

**Aldreds**  
Estate Agents



20 Cedar Close

Bradwell, Great Yarmouth, NR31 8JA

Offers In The Region Of £250,000



## 20 Cedar Close

Bradwell, Great Yarmouth, NR31 8JA

Sitting on this popular cul-de-sac, we are pleased to offer this well presented, spacious, extended three bedroom semi detached bungalow. The property has an entrance hall, two reception rooms, kitchen, inner hallway, three bedrooms and a bathroom. There are the benefits of gas central heating and sealed unit double glazing. Outside there are front & rear gardens and a driveway leading to garage. Carpets as fitted are included in the asking price.

### Entrance Hall

Loft access, door to side, storage cupboard, radiator.

### Lounge

17'0" x 10'4" (5.18 x 3.15)

Double glazed window to front aspect, radiator, archway to:-

### Dining Room

10'4" x 9'5" (3.15 x 2.87)

Radiator.

### Kitchen

13'6" x 9'1" (4.11 x 2.77 (4.12 x 2.78))

Base and wall mounted storage units with work surfaces over, double glazed window to front aspect, double glazed window to side aspect, stainless steel sink and drainer, part tiled walls, plumbing for washing machine, electric hob, electric oven, radiator.

### Bedroom 3

9'1" x 8'11" (2.77 x 2.72 (2.78 x 2.73))

Double glazed window to side aspect, radiator.

### Bathroom

6'5" x 5'5" (1.96 x 1.65)

Panel bath, pedestal hand wash basin, low level WC, opaque double glazed window to side aspect, radiator.

### Inner Hallway

### Bedroom 1

14'7" x 8'8" (4.45 x 2.64)

Double glazed window to rear aspect, radiator.





### Bedroom 2

12'4" x 11'0" (3.76 x 3.35)

Double glazed window to rear aspect, radiator.

### Outside

To the front of the property there is a driveway leading to garage, the garage has an up and over door and benefits from power and light. The garage also has an inspection pit. Shingle garden. To the rear of the property there is a lawned garden with flower beds and borders containing bushes, shrubs and plants, timber shed.

### Tenure

Freehold.

### Services

Mains water, electric, gas and drainage.

### Council Tax

Great Yarmouth Borough Council - Band C

### Location

Bradwell is a popular residential area adjoining Gorleston 2 miles from Great Yarmouth Town centre \* There are a variety of local shops \* Schools \* Medical centre \* Regular bus services to the main shopping areas \* Indoor swimming pool and recreation areas.

### Directions

From the Gorleston office head south along the High Street, at the traffic lights turn right into Church Lane, continue over the roundabout and the next set of traffic lights into Crab Lane, at the 'T' junction turn left into Beccles Road, at the traffic lights take the sharper turn on the right into Mill Lane, follow the road round to the left and continue into Willow Avenue,, turn right into Cedar Close where the property can be found at the end.

Ref: G17772/01/23



## Floor Plan

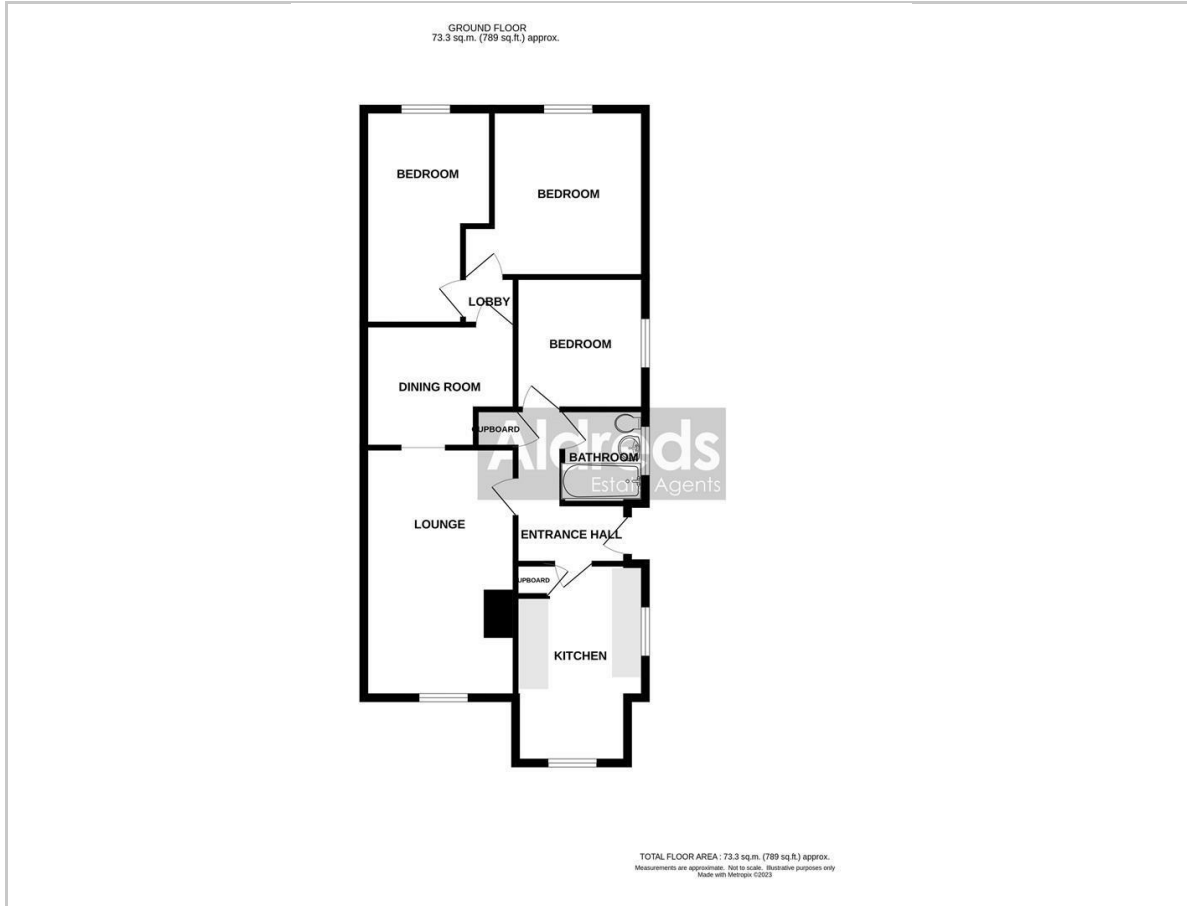

## Viewing

Please contact our Aldreds Gorleston Office on 01493 664600 if you wish to arrange a viewing appointment for this property or require further information.

### Disclaimer

These particulars are issued on an understanding that all negotiations shall be conducted through Messrs. Aldreds. Please note: Messrs. Aldreds for themselves and for the vendors or lessors of this property whose agents they are given notice that: 1. Particulars are set out as a general outline only for guidance of intending purchasers or lessees, and do not constitute nor constitute part of, an offer or contract. 2. All descriptions, dimensions, references to condition and necessary permissions for use and occupation, and other details are given without responsibility and any intending purchasers or tenants should not rely on them as statements or representations of fact but must satisfy themselves by inspection or otherwise as to the correctness of each of them. 3. No person in the employment of Messrs. Aldreds has any authority to make or give any representation or warranty whatever in relation to this property. 4. If you are proposing to visit the property and are traveling some distance please check with Aldreds on the issue of availability prior to traveling. 5. Aldreds Property Consultants and associated services may offer additional services to the prospective purchaser for which they will be entitled to receive a commission.

Aldreds are pleased to be working with Mortgage Advice Bureau. They're an award-winning mortgage broker with over 1,400 advisers across the UK, and have access to over 12,000 mortgage products from over 90 lenders. Aldreds Estate Agents Ltd receive a commission of £200 on each completed case. Your home may be repossessed if you do not keep up repayments on your mortgage. There may be a fee for mortgage advice. The actual amount you pay will depend upon your circumstances. The fee is up to 1%, but a typical fee is 0.3% of the amount borrowed. Mortgage Advice Bureau is a trading name of Mortgage Seeker Limited which is an appointed representative of Mortgage Advice Bureau Limited and Mortgage Advice Bureau (Derby) Limited which are authorised and regulated by the Financial Conduct Authority. Mortgage Seeker Limited Registered Office: Lovewell Blake, Sixty Six North Quay, Great Yarmouth, Norfolk, NR30 1HE. Registered in England Number: 372141.

## Area Map

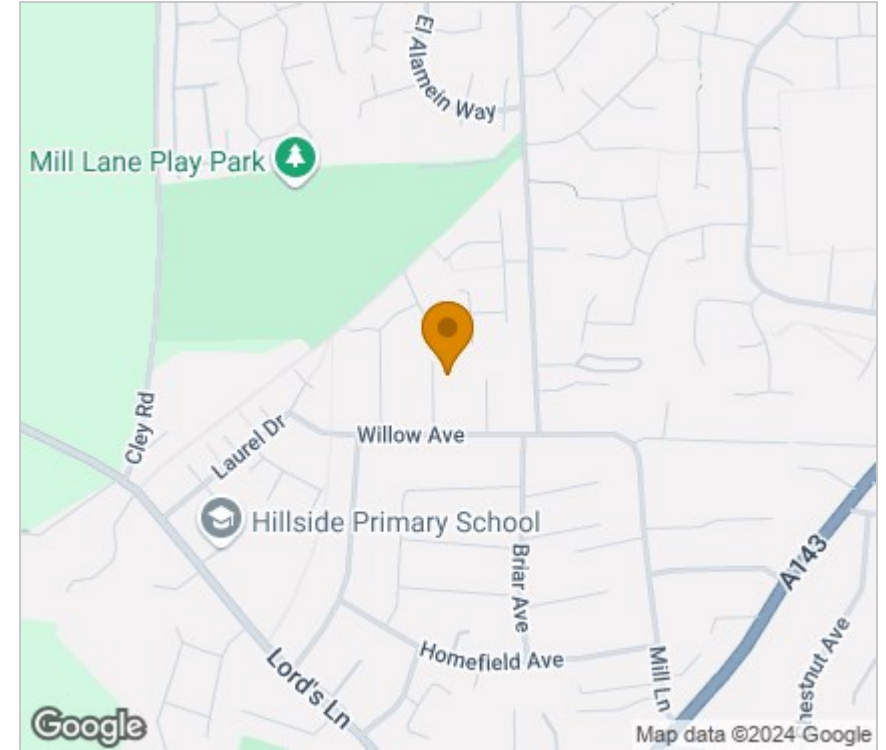

## Energy Efficiency Graph

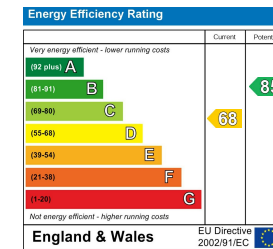

149 High Street, Gorleston, Norfolk, NR31 6RB  
Tel: 01493 664600 Email: [gorleston@aldreds.co.uk](mailto:gorleston@aldreds.co.uk) <https://www.aldreds.co.uk/>

Registered in England Reg. No. 08945751 Registered Office: 66 North Quay, Great Yarmouth, Norfolk NR30 1HE Directors: Mark Duffield B.S.c. FRICS. Dan Crawley MNAEA Paul Lambert MNAEA