

Aldreds
Estate Agents



24 The Mews

Gorleston, Great Yarmouth, NR31 6TW

£230,000



24 The Mews

Gorleston, Great Yarmouth,

A well presented and extended three bedroom semi detached house sitting in this convenient location for the James Paget Hospital. On the ground floor there is an entrance porch, entrance hall, lounge, dining room and a kitchen. Landing, three bedrooms and a shower room on the first floor. Gas central heating and sealed unit double glazing. Gardens to front & rear. Driveway to en bloc garage. Carpets, as fitted, are included in the asking price.

Entrance Porch

Door to front.

Entrance Hall

Stairs to landing, radiator.

Lounge

19'3" x 9'11" (5.87 x 3.02)

Double glazed window to front aspect, radiator.

Dining Room

11'10" x 9'7" (3.61 x 2.92)

Double glazed window to side aspect, radiator, double glazed French doors to rear garden.

Kitchen

11'9" x 9'0" (3.58 x 2.74)

Base & wall units with work tops, double glazed window to rear aspect, door to side, plumbing for washing machine, electric hob, electric oven, sink.

Landing

Storage cupboard with wall mounted gas boiler, loft access, double glazed window to side aspect.

Bedroom 1

11'1" x 9'11" (3.38 x 3.02 (3.37 x 3.01))

Double glazed window to front aspect, radiator.

Bedroom 2

11'0" x 7'11" (3.35 x 2.41)

Built in wardrobe, double glazed window to rear aspect, radiator.





Bedroom 3

7'11" x 6'3" (2.41 x 1.91)

Double glazed window to rear aspect, radiator.

Shower Room

6'0" x 5'5" (1.83 x 1.65)

Shower in cubicle, hand basin, low level WC, radiator.

Outside

To the front there is a lawned garden with bushes and shrubs. To the rear there is a paved patio, lawned garden, shed, bushes and shrubs. Driveway & en bloc garage.

Tenure

Leasehold. The property has the remainder of a 999 year lease from September 1975 at a ground rent of £25 per annum.

Services

Mains water, electric, gas, drainage.

Council Tax

Band B

Location

Gorleston-on-Sea is a coastal town 2 miles from Great Yarmouth centre and has a varied selection of local shops * Golf Course * Modern District hospital * Schools for all ages * Library * Regular bus services to the main shopping areas and a sandy beach.

Directions

From the Gorleston office head south along the High Street, at the traffic lights turn right into Church Lane, at the roundabout turn left into Middleton Road, at the next roundabout turn right into Lowestoft Road, at the traffic lights turn left into Bridge Road, turn right into Kennedy Avenue, at the 'T' junction turn right into Mariners Compass where The Mews is a walkway on the left. The property is overlooking to green.

Ref: G17817/03/23



Floor Plan

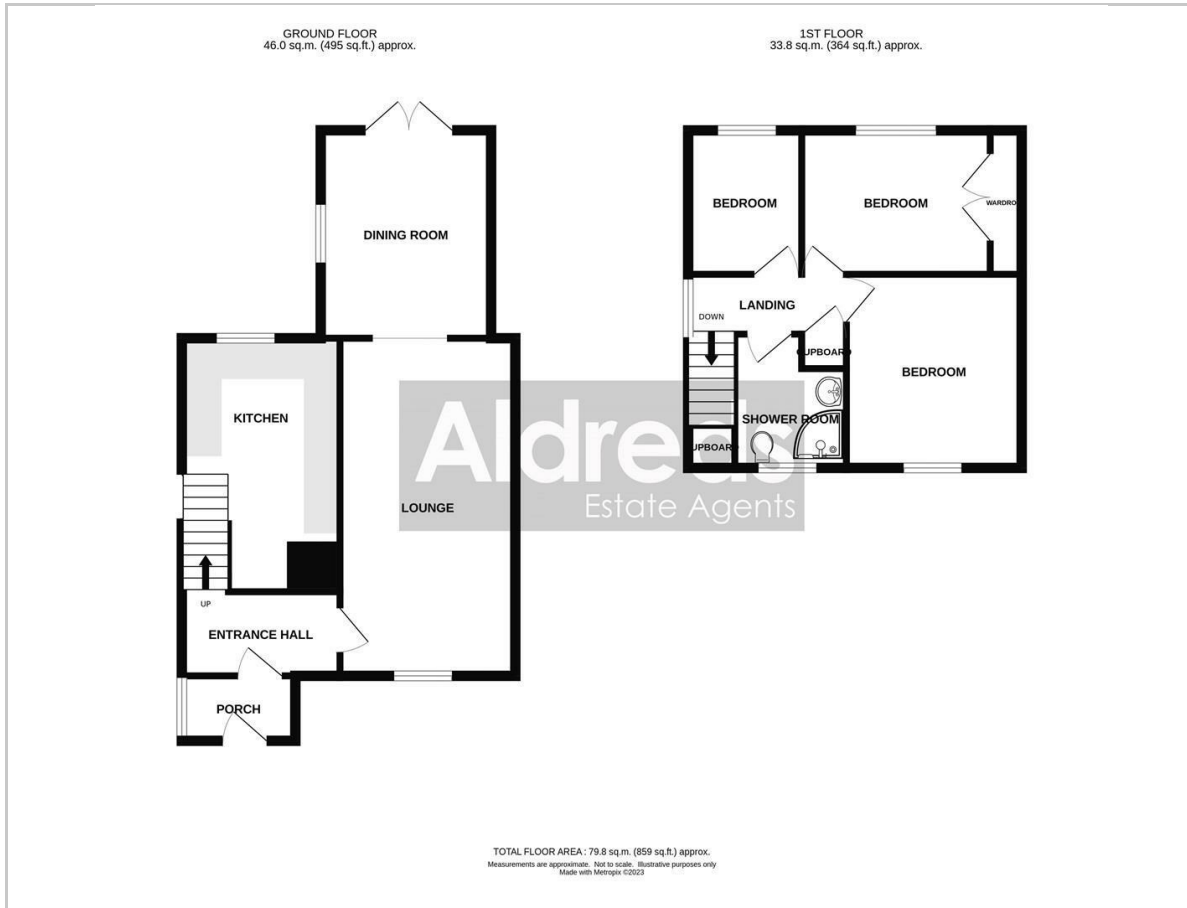

Viewing

Please contact our Aldreds Gorleston Office on 01493 664600 if you wish to arrange a viewing appointment for this property or require further information.

Disclaimer

These particulars are issued on an understanding that all negotiations shall be conducted through Messrs. Aldreds. Please note: Messrs. Aldreds for themselves and for the vendors or lessors of this property whose agents they are given notice that: 1. Particulars are set out as a general outline only for guidance of intending purchasers or lessees, and do not constitute nor constitute part of, an offer or contract. 2. All descriptions, dimensions, references to condition and necessary permissions for use and occupation, and other details are given without responsibility and any intending purchasers or tenants should not rely on them as statements or representations of fact but must satisfy themselves by inspection or otherwise as to the correctness of each of them. 3. No person in the employment of Messrs. Aldreds has any authority to make or give any representation or warranty whatever in relation to this property. 4. If you are proposing to visit the property and are traveling some distance please check with Aldreds on the issue of availability prior to traveling. 5. Aldreds Property Consultants and associated services may offer additional services to the prospective purchaser for which they will be entitled to receive a commission. Aldreds are pleased to be working with Mortgage Advice Bureau. They're an award-winning mortgage broker with over 1,400 advisers across the UK, and have access to over 12,000 mortgage products from over 90 lenders. Aldreds Estate Agents Ltd receive a commission of £200 on each completed case. Your home may be repossessed if you do not keep up repayments on your mortgage. There may be a fee for mortgage advice. The actual amount you pay will depend upon your circumstances. The fee is up to 1%, but a typical fee is 0.3% of the amount borrowed. Mortgage Advice Bureau is a trading name of Mortgage Seeker Limited which is an appointed representative of Mortgage Advice Bureau Limited and Mortgage Advice Bureau (Derby) Limited which are authorised and regulated by the Financial Conduct Authority. Mortgage Seeker Limited Registered Office: Lovewell Blake, Sixty Six North Quay, Great Yarmouth, Norfolk, NR30 1HE. Registered in England Number: 372141.

Area Map



Energy Efficiency Graph

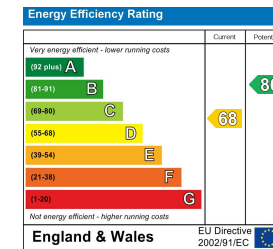

149 High Street, Gorleston, Norfolk, NR31 6RB
Tel: 01493 664600 Email: gorleston@aldreds.co.uk <https://www.aldreds.co.uk/>

Registered in England Reg. No. 08945751 Registered Office: 66 North Quay, Great Yarmouth, Norfolk NR30 1HE Directors: Mark Duffield B.S.c. FRICS. Dan Crawley MNAEA Paul Lambert MNAEA