



41 Waveney Valley Holiday Park Butt Lane

Burgh Castle, Great Yarmouth, NR31 9FN

£40,000



Sitting on the popular Waveney Valley Park, Aldreds are pleased to offer this two bedroom end terrace holiday chalet. The property has a large lounge/kitchen, two bedrooms and a bathroom. Sealed unit double glazing. Communal gardens and communal parking.



Lounge/Kitchen

Door to front, double glazed window to front aspect, double glazed window to rear aspect, base storage units, sink and drainer.

Bedroom 1 8'6" x 8'2" (2.59 x 2.49)

Built in wardrobe, double glazed window to front aspect.

Bedroom 2 8'2" x 8'2" (2.49 x 2.49)

Built in wardrobe, double glazed window to rear aspect.

Bathroom 7'7" x 5'4" (2.31 x 1.63)

Panel bath, hand wash basin, low level WC, opaque double glazed window to rear aspect.

Outside

Communal gardens and communal parking.

Tenure

Freehold. The vendor informs us the current site fees are around £1300 per annum (variable).

Occupation – 1st March - 14th January.

Council Tax

Great Yarmouth Borough Council - Band A

Location

Burgh Castle is a semi rural village 2 miles west of Gorleston and 4 miles from Great Yarmouth * The River Waveney and Breydon Water are on the outskirts of the village giving access to the Norfolk and Suffolk Broads * There is a yacht marina and historic Roman Castle ruins.

Directions

Leave Gorleston on the A143 Beccles Road, continue through Bradwell, turn right into New Road, continue into Belton, turn right into Stepshort, continue into Burgh Castle, continue into Butt Lane, turn left into Waveney Valley holiday village.

Ref: G17768/01/23

Area Map



Floor Plans

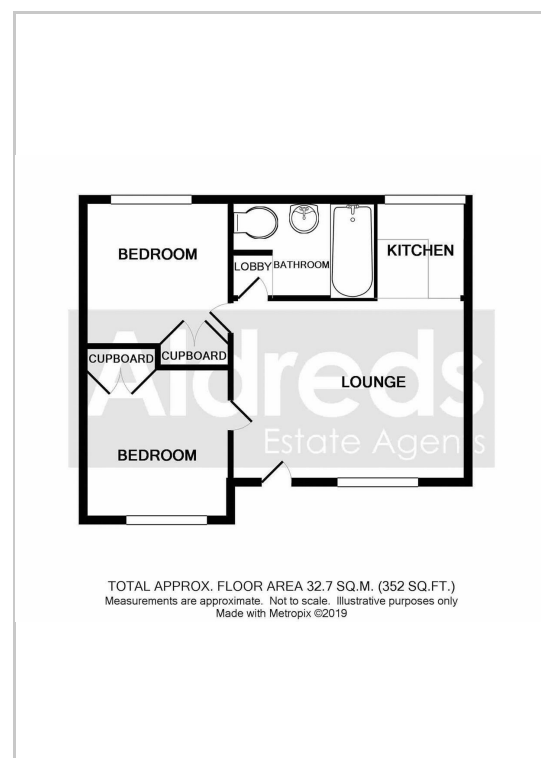

Energy Efficiency Graph

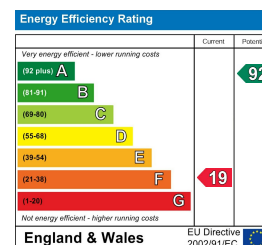

Disclaimer

These particulars are issued on an understanding that all negotiations shall be conducted through Messrs. Aldreds. Please note: Messrs. Aldreds for themselves and for the vendors or lessors of this property whose agents they are given notice that: 1. Particulars are set out as a general outline only for guidance of intending purchasers or lessees, and do not constitute nor constitute part of, an offer or contract. 2. All descriptions, dimensions, references to condition and necessary permissions for use and occupation, and other details are given without responsibility and any intending purchasers or tenants should not rely on them as statements or representations of fact but must satisfy themselves by inspection or otherwise as to the correctness of each of them. 3. No person in the employment of Messrs. Aldreds has any authority to make or give any representation or warranty whatever in relation to this property. 4. If you are proposing to visit the property and are traveling some distance please check with Aldreds on the issue of availability prior to traveling. 5. Aldreds Property Consultants and associated services may offer additional services to the prospective purchaser for which they will be entitled to receive a commission.

Aldreds are pleased to be working with Mortgage Advice Bureau. They're an award-winning mortgage broker with over 1,400 advisers across the UK, and have access to over 12,000 mortgage products from over 90 lenders. Aldreds Estate Agents Ltd receive a commission of £200 on each completed case. Your home may be repossessed if you do not keep up repayments on your mortgage. There may be a fee for mortgage advice. The actual amount you pay will depend upon your circumstances. The fee is up to 1%, but a typical fee is 0.3% of the amount borrowed. Mortgage Advice Bureau is a trading name of Mortgage Seeker Limited which is an appointed representative of Mortgage Advice Bureau Limited and Mortgage Advice Bureau (Derby) Limited which are authorised and regulated by the Financial Conduct Authority. Mortgage Seeker Limited Registered Office: Lovewell Blake, Sixty Six North Quay, Great Yarmouth, Norfolk, NR30 1HE. Registered in England Number: 372141. 6. Potential purchasers should check with their providers that the broadband and mobile phone coverage they would require is available.

149 High Street, Gorleston, Norfolk, NR31 6RB

Tel: 01493 664600 Email: gorleston@aldreds.co.uk <https://www.aldreds.co.uk/>

Registered in England Reg. No. 08945751 Registered Office: 66 North Quay, Great Yarmouth, Norfolk NR30 1HE Directors: Mark Duffield B.S.c. FRICS. Dan Crawley MNAEA Paul Lambert MNAEA