



11 Meadowcroft Bungalows Yarmouth Road, Ormesby, Great

Yarmouth, Great Yarmouth, Norfolk, NR26 9AA

£950 PCM





£950 PCM

11 Meadowcroft Bungalows Yarmouth

Ormesby, Great Yarmouth, NR29 3QQ

- Two Double Bedrooms
- Double Glazing
- Delightful Garden
- Dressing Room
- Gas Central Heating
- Private Parking

Aldreds lettings are delighted to offer this well presented spacious two / three bedroom bungalow situated in this cul-de-sac location within easy reach of local shops and the town centre. The accommodation comprises of an entrance hall, large living room, kitchen breakfast room, two double bedrooms, one single currently in use as a dressing room, bathroom and separate shower room, superb garden, driveway parking, gas central heating, double glazing Council Tax Band A, FURNISHED / PART FURNISHED **NOT AVAILABLE TO MOVE IN TO UNTIL 15TH SEPTEMBER**



Entrance Hall

Entrance porch leading to entrance hall. Radiator.

Living Room 17'0" x 11'1" (5.2 x 3.4)

Large living room with side aspect window and glazed patio doors to garden. TV point, radiator.

Kitchen Breakfast Room 11'9" x 11'1" (3.6 x 3.4)

Kitchen with ample storage and work surface and with enough room for a small table & chairs. Appliances include a gas cooker. Space and plumbing for additional appliances.

Bedroom 1 15'5" x 9'6" (4.7 x 2.9)

Double bedroom, double aspect windows, radiator.

Bedroom 2 10'2" x 6'10" (3.1 x 2.1)

Second double bedroom, front aspect window, radiator.

Bedroom 3 / Dressing Room 10'2" x 6'6" (3.1 x 2)

Single bedroom, currently in use as a dressing room. Skylight window, radiator.





Bathroom

Suite comprising bath, WC and wash basin. Frosted window, radiator.

Shower Room

Separate shower room, suite comprising double sized shower and WC. Tiled floor, radiator, frosted window.

Garden

Superb private garden with lawn areas, well stocked borders and mature trees.

Parking

Private driveway parking.

Additional Information

RENT

Rent is exclusive of Council Tax, water rates, sewerage rates. The rent is payable monthly in advance.

TENANCY

6 Months Assured Shorthold.

Directions



TERMS

NO SMOKING / PETS CONSIDERED

ADDITIONAL INFO

All applications for tenancy to be on a form which can be obtained from this office. A non-refundable holding deposit equivalent to one week's rent will be required. This will be transferred towards the first month's rent on commencement of the tenancy. The rent is payable monthly in advance and a Dilapidations deposit equivalent to 5 weeks' rent will also be required when agreements are signed. The Dilapidations Deposit is returnable after completion of a satisfactory tenancy. The aforementioned charges would be payable by bankers draft, a cheque drawn on a Building Society account, cash or Debit Card. NOT A PERSONAL CHEQUE.

Floor Plans

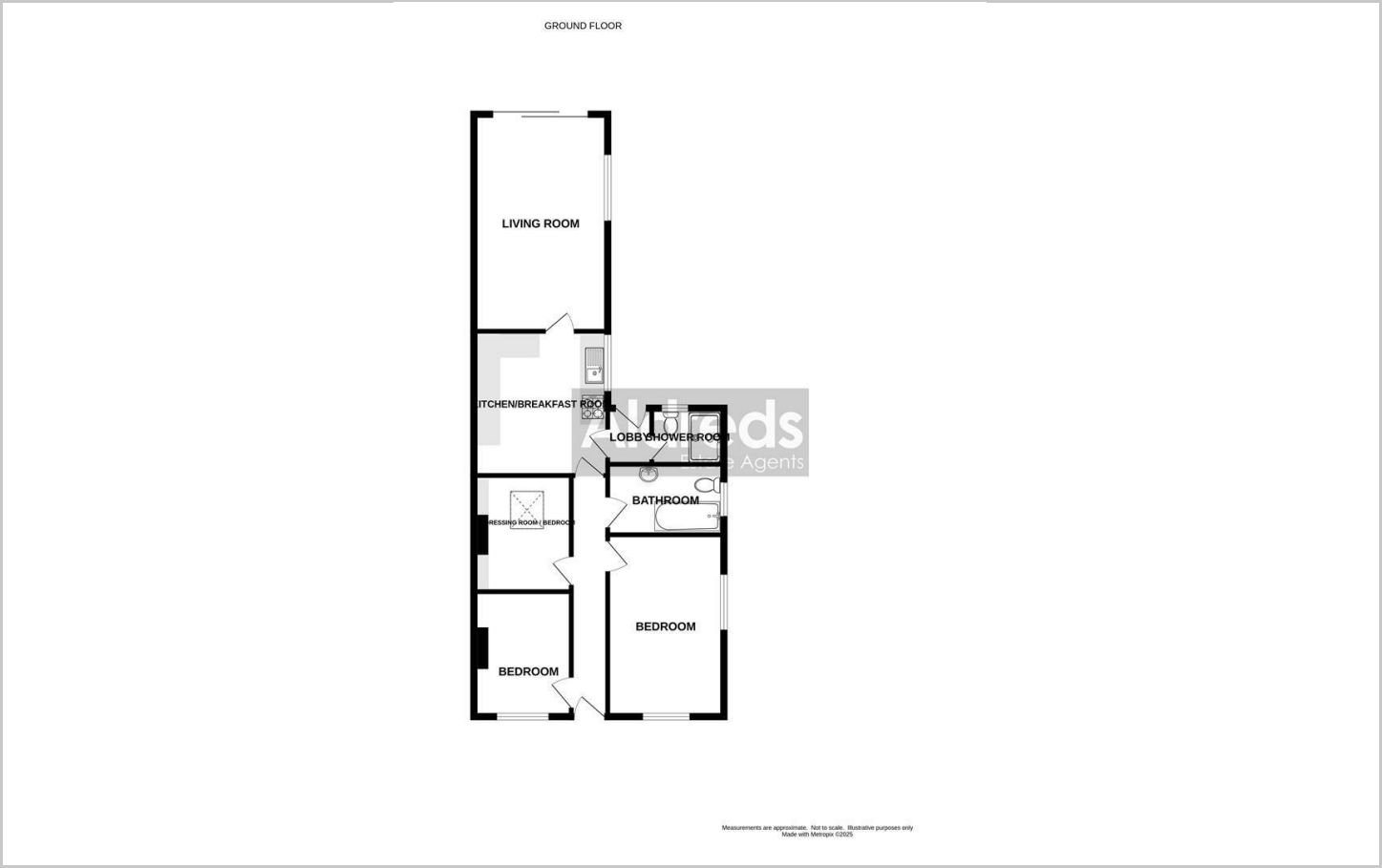

Viewing

Please contact our Aldreds Lettings Office on 01493 849111 if you wish to arrange a viewing appointment for this property or require further information.

Disclaimer

These particulars are issued on an understanding that all negotiations shall be conducted through Messrs. Aldreds. Please note: Messrs. Aldreds for themselves and for the vendors or lessors of this property whose agents they are given notice that: 1. Particulars are set out as a general outline only for guidance of intending purchasers or lessees, and do not constitute nor constitute part of, an offer or contract. 2. All descriptions, dimensions, references to condition and necessary permissions for use and occupation, and other details are given without responsibility and any intending purchasers or tenants should not rely on them as statements or representations of fact but must satisfy themselves by inspection or otherwise as to the correctness of each of them. 3. No person in the employment of Messrs. Aldreds has any authority to make or give any representation or warranty whatever in relation to this property. 4. If you are proposing to visit the property and are travelling some distance please check with Aldreds on the issue of availability prior to travelling. 5. Aldreds Property Consultants and associated services may offer additional services to the prospective purchaser for which they will be entitled to receive a commission. Aldreds are pleased to be working with Mortgage Advice Bureau. They're an award-winning mortgage broker with over 1,400 advisers across the UK, and have access to over 12,000 mortgage products from over 90 lenders. Aldreds Estate Agents Ltd receive a commission of £200 on each completed case. Your home may be repossessed if you do not keep up repayments on your mortgage. There may be a fee for mortgage advice. The actual amount you pay will depend upon your circumstances. The fee is up to 1%, but a typical fee is 0.3% of the amount borrowed. Mortgage Advice Bureau is a trading name of Mortgage Seeker Limited which is an appointed representative of Mortgage Advice Bureau Limited and Mortgage Advice Bureau (Derby) Limited which are authorised and regulated by the Financial Conduct Authority. Mortgage Seeker Limited Registered Office: Lovewell Blake, Sixty Six North Quay, Great Yarmouth, Norfolk, NR30 1HE. Registered in England Number: 03721415. 6. Potential purchasers should check with their providers that the broadband and mobile phone coverage they would require is available.

Location Map

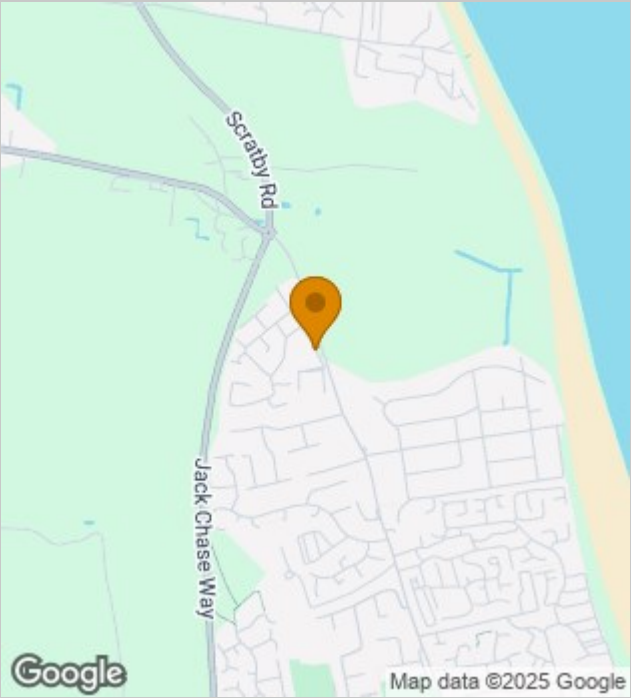

Energy Performance Graph

