



2 Vicarage Road

Dilham, North Walsham, NR28 9QA

£725 PCM



**** WATER CHARGES INCLUDED **** Aldreds Lettings are delighted to offer this superb two bedroom, two bathroom single storey barn conversion set in this delightful rural, but not isolated, location surrounded by open fields and countryside. The property benefits from a large open plan living room dining room with views over open countryside, cottage style painted kitchen, master bedroom with en-suite shower room, second double bedroom, main bathroom, maintained communal garden, electric heating, double glazing, residents parking, Council Tax Band A, UNFURNISHED



Living Room 17'4" x 15'8" (5.3 x 4.8)

Large living room with two rear aspect windows overlooking open farmland. Vaulted ceilings and feature exposed beams, door to garden, TV point, heater. Opens to kitchen area.

Kitchen Area

Cottage style painted kitchen with ample storage and work surface. Appliances include an electric cooker and cooker hood. Space for further appliance.

Bedroom 1 12'1" x 11'9" (3.7 x 3.6)

Double bedroom, rear aspect window looking over the garden, built in double wardrobe, heater. Door to en-suite bathroom.

Bedroom 1 En-suite

Modern white suite comprising bath, WC and wash basin. Heater, frosted window.

Bedroom 2 11'5" x 8'10" (3.5 x 2.7)

Second double bedroom, rear aspect window overlooking the garden, fitted wardrobe, heater, door to en-suite shower room.

Bedroom 2 en-suite

Modern white suite comprising shower cubicle, WC and wash basin. Chrome heated towel rail, frosted window.

Outside

Private garden area opens to communal maintained garden space. Separate shared laundry room with washing machine and tumble drier provided.

Parking

Off street residents parking is provided.

Additional information

12 Months Assured Shorthold.

TERMS

NO SMOKING

ADDITIONAL INFO

All applications for tenancy to be on a form which can be obtained from this office. A non-refundable holding deposit equivalent to one week's rent will be required. This will be transferred towards the first month's rent on commencement of the tenancy. The rent is payable monthly in advance and a Dilapidations deposit equivalent to 5 weeks' rent will also be required when agreements are signed. The Dilapidations Deposit is returnable after completion of a satisfactory tenancy. The aforementioned charges would be payable by bankers draft, a cheque drawn on a Building Society account, cash or Debit Card. NOT A PERSONAL CHEQUE.

Area Map



Floor Plans

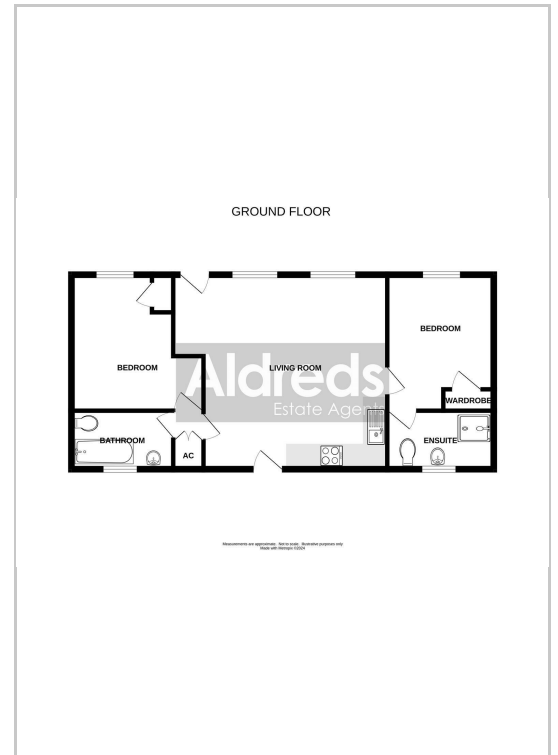

Energy Efficiency Graph

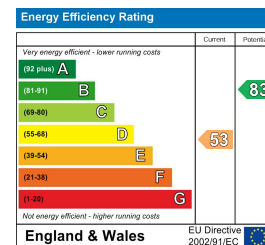

Disclaimer

These particulars are issued on an understanding that all negotiations shall be conducted through Messrs. Aldreds. Please note: Messrs. Aldreds for themselves and for the vendors or lessors of this property whose agents they are given notice that: 1. Particulars are set out as a general outline only for guidance of intending purchasers or lessees, and do not constitute nor constitute part of, an offer or contract. 2. All descriptions, dimensions, references to condition and necessary permissions for use and occupation, and other details are given without responsibility and any intending purchasers or tenants should not rely on them as statements or representations of fact but must satisfy themselves by inspection or otherwise as to the correctness of each of them. 3. No person in the employment of Messrs. Aldreds has any authority to make or give any representation or warranty whatever in relation to this property. 4. If you are proposing to visit the property and are travelling some distance please check with Aldreds on the issue of availability prior to travelling. 5. Aldreds Property Consultants and associated services may offer additional services to the prospective purchaser for which they will be entitled to receive a commission.

Aldreds are pleased to be working with Mortgage Advice Bureau. They're an award-winning mortgage broker with over 1,400 advisers across the UK, and have access to over 12,000 mortgage products from over 90 lenders. Aldreds Estate Agents Ltd receive a commission of £200 on each completed case. Your home may be repossessed if you do not keep up repayments on your mortgage. There may be a fee for mortgage advice. The actual amount you pay will depend upon your circumstances. The fee is up to 1%, but a typical fee is 0.3% of the amount borrowed. Mortgage Advice Bureau is a trading name of Mortgage Seeker Limited which is an appointed representative of Mortgage Advice Bureau Limited and Mortgage Advice Bureau (Derby) Limited which are authorised and regulated by the Financial Conduct Authority. Mortgage Seeker Limited Registered Office: Lovewell Blake, Sixty Six North Quay, Great Yarmouth, Norfolk, NR30 1HE. Registered in England Number: 03721415. 6. Potential purchasers should check with their providers that the broadband and mobile phone coverage they would require is available.

17 Hall Quay, Great Yarmouth, Norfolk, NR30 1HJ
Tel: 01493 849111 Email: lettings@aldreds.co.uk <https://www.aldreds.co.uk/>

Registered in England Reg. No. 08945751 Registered Office: 66 North Quay, Great Yarmouth, Norfolk NR30 1HE Directors: Mark Duffield B.S.c. FRICS. Dan Crawley MNAEA Paul Lambert MNAEA