

Aldreds
Estate Agents



6 Cambridge Road

Lowestoft NR32 1TE

Price Guide £175,000



3



1



1



D

6 Cambridge Road

Lowestoft NR32 1TE

GUIDE PRICE - £175,000 - £185,000 Aldreds are pleased to welcome this unique semi detached house on Cambridge Road. Boasting a 20ft kitchen/diner and cottage style garden, this property offers a homely atmosphere with charming characteristics throughout. One not to miss! Call us today on 01502 565432

Entrance Porch

Double glazed wood effect uPVC front door leading into property, space for coats and shoes, access into kitchen and lounge, stairs leading to first floor landing, tiled flooring, radiator

Lounge

12'4" x 12'4" (3.78m x 3.76m)

Double glazed windows to front and side aspect, exposed brick fireplace, power points, carpet flooring, wooden shelving bay window looking onto garden, radiator

Kitchen/Diner

20'8" x 10'4" (6.30m x 3.15m)

Two double glazed windows to side aspect, double glazed window to front aspect, fitted kitchen wall and base units with work surfaces, partially tiled walls, sink and drainer unit, space for washing machine, space for cooker, space for fridge and separate freezer, under stairs storage cupboard, radiator, tiled flooring

Lobby

Boiler cupboard, tiled flooring, double glazed wood effect uPVC door leading to garden, door leading to bathroom, tiled flooring

Bathroom

Double glazed window to front aspect, tiled walls, low level WC, pedestal sink, bath with fitted over head shower, tiled flooring





Bedroom 1

12'4" x 10'4" (3.78m x 3.17m)

Double glazed window to front and side aspect, radiator, power points, built in storage cupboard, carpet

Bedroom 2

12'4" max x 10'0" (3.78m max x 3.07m)

Double glazed window to side aspect, power points, radiator, door leading to bedroom 3, carpet

Bedroom 3 / Office

8'7" max x 8'3" (2.64m max x 2.54m)

Double glazed window to front aspect, fitted worktop, power points, radiator, carpet

Outside

The property benefits from a fully enclosed wrap around garden with mature shrubs and plants as well as decorative paving and sleepers. The garden offers access to a good sized storage cupboard with power and shelving.

Services

Mains water and drainage, gas and electric



Floor Plan

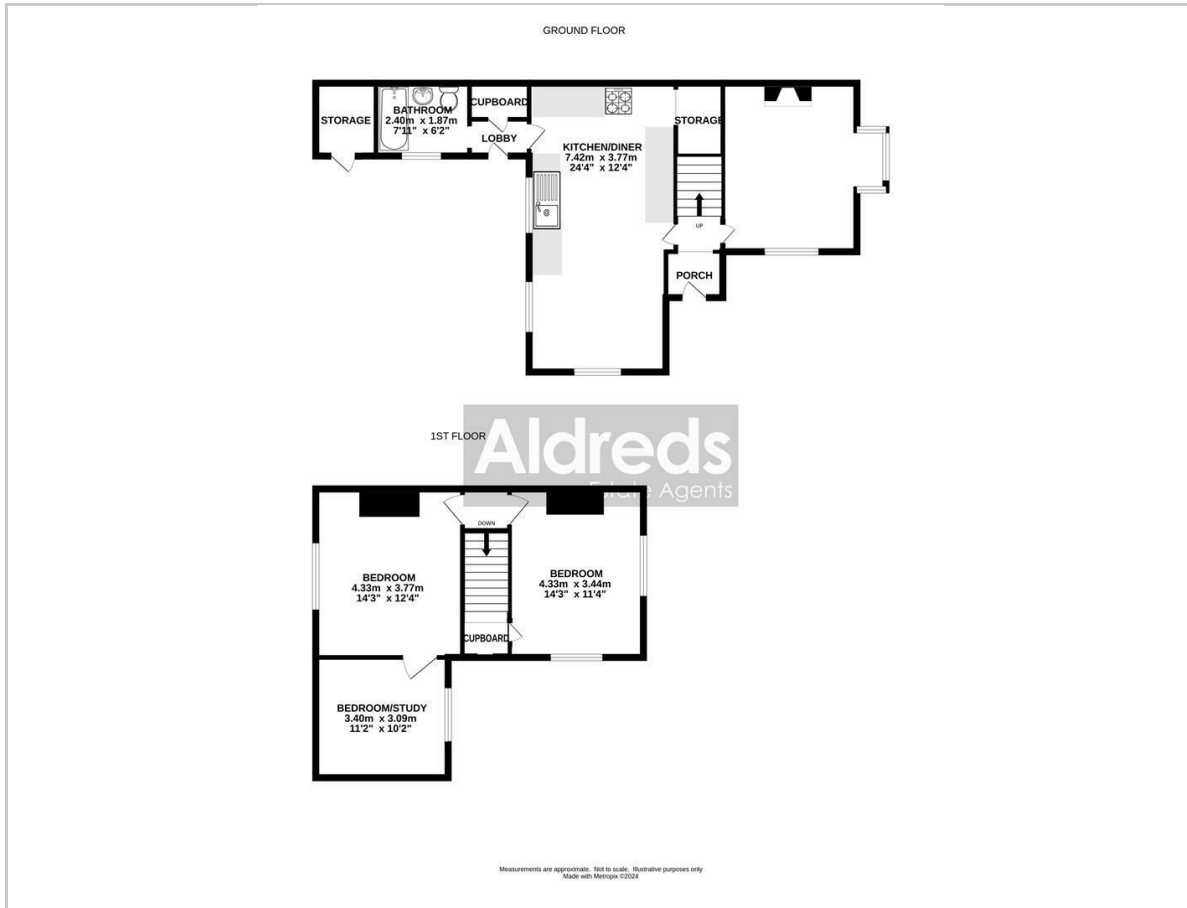

Viewing

Please contact our Aldreds Lowestoft Office on 01502 565432 if you wish to arrange a viewing appointment for this property or require further information.

Disclaimer

These particulars are issued on an understanding that all negotiations shall be conducted through Messrs. Aldreds. Please note: Messrs. Aldreds for themselves and for the vendors or lessors of this property whose agents they are given notice that: 1. Particulars are set out as a general outline only for guidance of intending purchasers or lessees, and do not constitute nor constitute part of, an offer or contract. 2. All descriptions, dimensions, references to condition and necessary permissions for use and occupation, and other details are given without responsibility and any intending purchasers or tenants should not rely on them as statements or representations of fact but must satisfy themselves by inspection or otherwise as to the correctness of each of them. 3. No person in the employment of Messrs. Aldreds has any authority to make or give any representation or warranty whatever in relation to this property. 4. If you are proposing to visit the property and are travelling some distance please check with Aldreds on the issue of availability prior to travelling. 5. Aldreds Property Consultants and associated services may offer additional services to the prospective purchaser for which they will be entitled to receive a commission.

Aldreds are pleased to be working with Mortgage Advice Bureau. They're an award-winning mortgage broker with over 1,400 advisers across the UK, and have access to over 12,000 mortgage products from over 90 lenders. Aldreds Estate Agents Ltd receive a commission of £200 on each completed case. Your home may be repossessed if you do not keep up repayments on your mortgage. There may be a fee for mortgage advice. The actual amount you pay will depend upon your circumstances. The fee is up to 1%, but a typical fee is 0.3% of the amount borrowed. Mortgage Advice Bureau is a trading name of Mortgage Seeker Limited which is an appointed representative of Mortgage Advice Bureau Limited and Mortgage Advice Bureau (Derby) Limited which are authorised and regulated by the Financial Conduct Authority. Mortgage Seeker Limited Registered Office: Lovewell Blake, Sixty Six North Quay, Great Yarmouth, Norfolk, NR30 1HE. Registered in England Number: 03721415. 6. Potential purchasers should check with their providers that the broadband and mobile phone coverage they would require is available.

Area Map



Energy Efficiency Graph

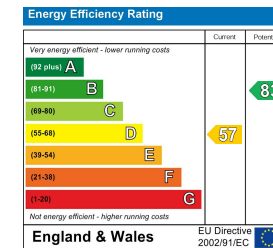

143 London Road North, Lowestoft, Suffolk, NR32 1NE
Tel: 01502 565432 Email: lowestoft@aldreds.co.uk <https://www.aldreds.co.uk/>

Registered in England Reg. No. 08945751 Registered Office: 66 North Quay, Great Yarmouth, Norfolk NR30 1HE Directors: Mark Duffield B.S.c. FRICS. Dan Crawley MNAEA Paul Lambert MNAEA