



256 Winterton Valley Estate Edward Road

Winterton-On-Sea, Great Yarmouth, NR29 4BX

£48,950



Aldreds are pleased to offer this east and west facing, well maintained and well equipped, two bedroom mid terrace holiday chalet situated in the much sought after Winterton Valley Estate. The chalet offers accommodation including open plan living/dining/kitchen area with fitted kitchen, two bedrooms and bathroom. The chalet benefits from double glazed windows. Offered with no onward chain. Early viewing is highly recommended to appreciate.



Living /Dining Room 18'7" x 7'11" (5.66 x 2.41)

Double glazed window and French doors to front aspect, table and chairs, sofa and arm chairs, tv point, fitted carpet, open access to:

Kitchen Area 7'7" x 5'5" (2.31 x 1.65)

Fitted modern white matching wall and base units with wood effect work surface over, single drainer sink unit, part tiled walls, cooker, fridge, microwave, double glazed window and part double glazed pvc door to rear, vinyl flooring.

Bedroom 1 12'4" x 8'4" (3.76 x 2.54 (3.77 x 2.53))

Double bed, wardrobe, bedside cabinet, double glazed window to front aspect, fitted carpet.

Bedroom 2 9'0" x 7'10" (2.74 x 2.39)

Two single beds, bedside cabinet, double glazed window to rear aspect, fitted carpet.

Inner Lobby

Clocks storage space, built in airing cupboard housing the copper hot water cylinder, door in to:

Bathroom

White suite comprising panel bath with electric shower over, pedestal wash basin, low level wc, part tiled walls, frosted double glazed window to rear aspect.

Outside

The property faces an east and west direction with communal lawned grounds, communal parking nearby and childrens play area.

Tenure

Leasehold.

99 year lease from 25th March 1971.

Site charges 2023 - £1803.23

Site open 24th March - 31st October + 7 days at Christmas

Dogs allowed.

Services

Mains water, electric and drainage.

Council Tax

Great Yarmouth Borough Council - Band 'A' (10% reduction applies for holiday use).

Location

Winterton-on-Sea is a coastal village approximately 9 miles north of Great Yarmouth with a sandy beach * Sand dunes * Nature Reserve * There is a selection of shops * Post Office * First School * Middle and High Schools are situated in Martham approximately 3 miles away * School buses operate in the area * Eastern Counties Bus services link the coastal village with Great Yarmouth.

Directions

On arriving in the village of Winterton-on-Sea on the Hemsby Road, turn right into Edward Road where Winterton Valley Estate can be found on your right hand side. Turn right in to the site and after a couple of hundred yards follow the road around the bend passing the reception building and follow the road around to the right where the chalet be found on the left hand side after a couple of hundred yards.

EPC Rating - F (35)

Ref: Y12185/8/24

Area Map



Floor Plans

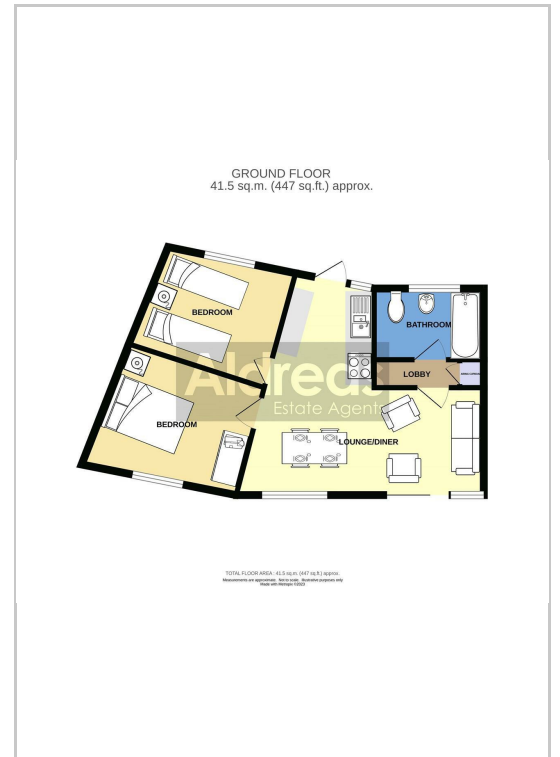

Energy Efficiency Graph

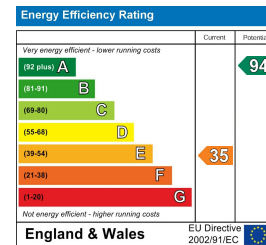

Disclaimer
These particulars are issued on an understanding that all negotiations shall be conducted through Messrs. Aldreds. Please note: Messrs. Aldreds for themselves and for the vendors or lessors of this property whose agents they are given notice that: 1. Particulars are set out as a general outline only for guidance of intending purchasers or lessees, and do not constitute nor constitute part of, an offer or contract. 2. All descriptions, dimensions, references to condition and necessary permissions for use and occupation, and other details are given without responsibility and any intending purchasers or tenants should not rely on them as statements or representations of fact but must satisfy themselves by inspection or otherwise as to the correctness of each of them. 3. No person in the employment of Messrs. Aldreds has any authority to make or give any representation or warranty whatever in relation to this property. 4. If you are proposing to visit the property and are traveling some distance please check with Aldreds on the issue of availability prior to traveling. 5. Aldreds Property Consultants and associated services may offer additional services to the prospective purchaser for which they will be entitled to receive a commission.

Aldreds are pleased to be working with Mortgage Advice Bureau. They're an award-winning mortgage broker with over 1,400 advisers across the UK, and have access to over 12,000 mortgage products from over 90 lenders. Aldreds Estate Agents Ltd receive a commission of £200 on each completed case. Your home may be repossessed if you do not keep up repayments on your mortgage. There may be a fee for mortgage advice. The actual amount you pay will depend upon your circumstances. The fee is up to 1%, but a typical fee is 0.3% of the amount borrowed. Mortgage Advice Bureau is a trading name of Mortgage Seeker Limited which is an appointed representative of Mortgage Advice Bureau Limited and Mortgage Advice Bureau (Derby) Limited which are authorised and regulated by the Financial Conduct Authority. Mortgage Seeker Limited Registered Office: Lovewell Blake, Sixty Six North Quay, Great Yarmouth, Norfolk, NR30 1HE. Registered in England Number: 372141.

17 Hall Quay, Great Yarmouth, Norfolk, NR30 1HJ
Tel: 01493 844891 Email: yarmouth@aldreds.co.uk <https://www.aldreds.co.uk/>

Registered in England Reg. No. 08945751 Registered Office: 66 North Quay, Great Yarmouth, Norfolk NR30 1HE Directors: Mark Duffield B.S.c. FRICS. Dan Crawley MNAEA Paul Lambert MNAEA