

Aldreds
Estate Agents



18 Beresford Road, Caister-On-Sea, Great Yarmouth, NR30 5DR

£240,000



2



1



2



D



£240,000

18 Beresford Road

Caister-On-Sea, Great Yarmouth, NR30 5DR

- Mature Semi Detached Bungalow
- Two Double Bedrooms
- Recently Refurbished Wet Room
- Gas Central HEating
- Ideal Retirement Property
- Sought After Location Close To Village Centre
- Two Reception Rooms & Conservatory
- Double Glazed Windows
- Generous Plot With Scope For Expansion
- Offered Chain Free

Aldreds are pleased to offer this deceptively spacious, mature semi detached bungalow on a generous plot with a private west facing rear garden and a short walk from the village centre making it an ideal retirement property. The property offers a central entrance hall that provides access to the lounge, dining room, kitchen, conservatory, two double bedrooms and recently refurbished wet room. Outside there is a long driveway for car parking with a non standard garage and delightful established gardens. The property also benefits from double glazed windows, gas central heating and is offered chain free. Viewing recommended.



Entrance Hall

Part double glazed pvc entrance door, access to loft space, doors leading off to:

Lounge 15'10" x 12'0" (4.84 x 3.67)

Plus double glazed bay window to front aspect and double glazed window to side, chimney breast with fitted gas fire, two wall lights, radiator, tv point.

Dining Room 10'0" x 9'4" (3.06 x 2.87)

radiator, access to kitchen and double doors to:

Conservatory 14'8" x 7'8" (4.49 x 2.35)

Brick and pvc double glazed construction with poly carbonate roof over, two wall lights, power points, radiator, part double glazed door to rear.





Kitchen 10'0" x 9'10" (3.06 x 3.01)

Extensively fitted with oak fronted wall and matching base units with work surface over, part tiled walls, gas cooker, single drainer one and a half bowl stainless steel sink unit, wood effect vinyl flooring, space and plumbing for a washing machine, telephone point, integrated fridge/freezer, double glazed window to side and frosted double glazed door to side, door to:

Inner Lobby

Shallow storage cupboard, recess housing the gas combination boiler, door to:

Wet Room 6'8" x 5'3" (2.04 x 1.61)

Recently refurbished with a fully tiled wet room with waterproof floor membrane and mains fed shower, pedestal wash basin, low level wc, extractor fan, chrome towel rail/radiator, frosted double glazed window to rear aspect.

Bedroom 1 12'11" x 12'0" (3.95 x 3.67)

Including wardrobe cupboard, corner fireplace, radiator, tv aerial lead, double glazed window to front aspect.

Directions



Bedroom 2 12'11" x 10'0" (3.95 x 3.06)

Including wardrobe cupboard, corner fireplace, radiator, double glazed window to rear aspect.

Outside

The property sits on a very generous plot with a lawned front garden with established planting and bushes bordering. Adjacent to the bungalow is a long block pavior driveway providing parking for several cars with a timber fenced screen and gate leading beyond in to the rear garden. The rear garden has an additional block pavior drive/patio which extends to the partly concealed non standard constructed garage. The remainder of the garden is laid with decking, patio, extensive lawned area and is well screened by established bushes, small trees and conifers.

Tenure

Freehold

Services

Mains water, electric, gas and drainage.

Council Tax

Great Yarmouth Borough Council - Band 'B'

Location

Caister-on-Sea is a popular coastal village approximately 3 miles north of Great Yarmouth * There are a variety of local shops, pubs and restaurants * Post Office * First, Middle and High schools * Golf Course * Regular bus services to Great Yarmouth * Caister also boasts Roman Ruins * a sandy beach and its own Historic Castle.

Directions

From the Yarmouth office head north along the A149 Caister Road, continue past the Yarmouth Stadium, at the roundabout turn right into Yarmouth Road, at the mini roundabout and turn right in to Tan Lane and after a couple of hundred yards turn right in to Beresford Road.

Ref: Y12141/06/24/CF

Floor Plans

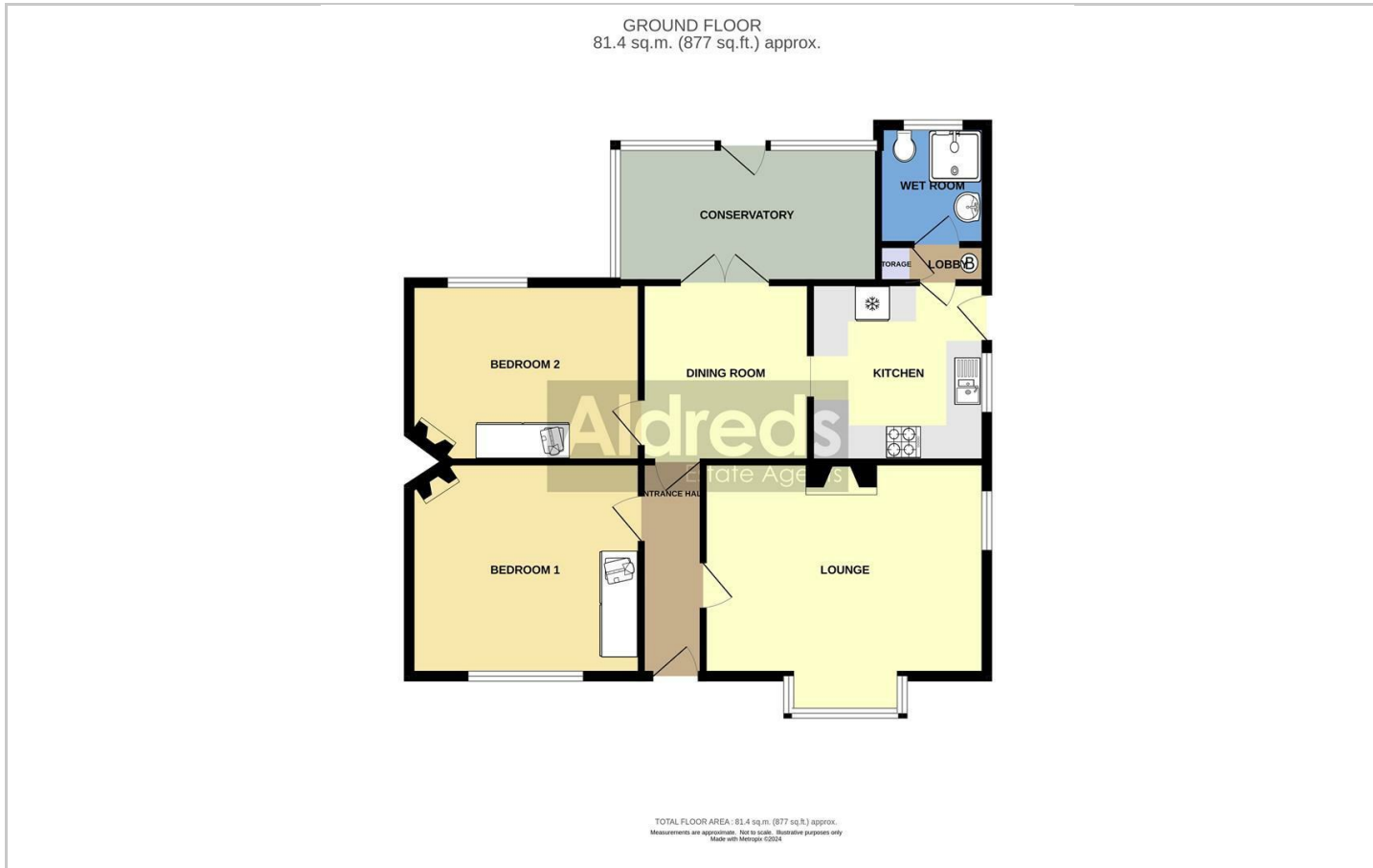

Location Map

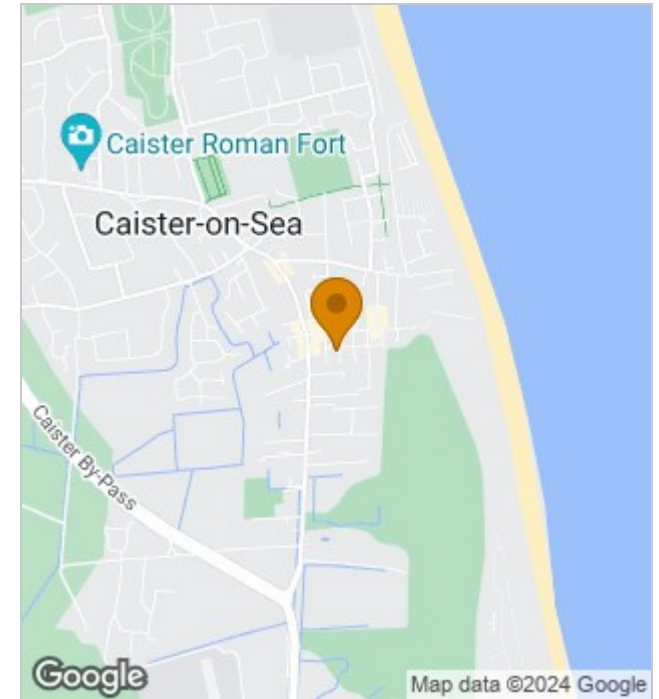

Energy Performance Graph

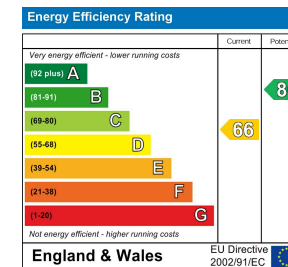

Viewing

Please contact our Aldreds Great Yarmouth Office on 01493 844891 if you wish to arrange a viewing appointment for this property or require further information.

Disclaimer

These particulars are issued on an understanding that all negotiations shall be conducted through Messrs. Aldreds. Please note: Messrs. Aldreds for themselves and for the vendors or lessors of this property whose agents they are given notice that: 1. Particulars are set out as a general outline only for guidance of intending purchasers or lessees, and do not constitute nor constitute part of, an offer or contract. 2. All descriptions, dimensions, references to condition and necessary permissions for use and occupation, and other details are given without responsibility and any intending purchasers or tenants should not rely on them as statements or representations of fact but must satisfy themselves by inspection or otherwise as to the correctness of each of them. 3. No person in the employment of Messrs. Aldreds has any authority to make or give any representation or warranty whatever in relation to this property. 4. If you are proposing to visit the property and are travelling some distance please check with Aldreds on the issue of availability prior to travelling. 5. Aldreds Property Consultants and associated services may offer additional services to the prospective purchaser for which they will be entitled to receive a commission. Aldreds are pleased to be working with Mortgage Advice Bureau. They're an award-winning mortgage broker with over 1,400 advisers across the UK, and have access to over 12,000 mortgage products from over 90 lenders. Aldreds Estate Agents Ltd receive a commission of £200 on each completed case. Your home may be repossessed if you do not keep up repayments on your mortgage. There may be a fee for mortgage advice. The actual amount you pay will depend upon your circumstances. The fee is up to 1%, but a typical fee is 0.3% of the amount borrowed. Mortgage Advice Bureau is a trading name of Mortgage Seeker Limited which is an appointed representative of Mortgage Advice Bureau Limited and Mortgage Advice Bureau (Derby) Limited which are authorised and regulated by the Financial Conduct Authority. Mortgage Seeker Limited Registered Office: Lovewell Blake, Sixty Six North Quay, Great Yarmouth, Norfolk, NR30 1HE. Registered in England Number: 03721415. 6. Potential purchasers should check with their providers that the broadband and mobile phone coverage they would require is available.

17 Hall Quay, Great Yarmouth, Norfolk, NR30 1HJ
Tel: 01493 844891 Email: yarmouth@aldreds.co.uk <https://www.aldreds.co.uk/>

Registered in England Reg. No. 08945751 Registered Office: 66 North Quay, Great Yarmouth, Norfolk NR30 1HE Directors: Mark Duffield B.S.c. FRICS. Dan Crawley MNAEA Paul Lambert MNAEA