



4  1  1 

Mallaby St, Birkenhead

£145,000

BELVOIR!



Key Features

- > END TERRACE
- > PRIVATE GARDEN
- > FOUR BEDROOMS
- > CONVENIENT LOCATION
 - > FREEHOLD
 - > NO CHAIN
 - > EPC rating E



This delightful four bedroom end terrace house located in the heart of North Birkenhead. This freehold property offers a perfect blend of comfort and convenience, making it an ideal family home. The house features four spacious bedrooms, providing ample space for a growing family, as well as one well-appointed bathroom. The living spaces include a large kitchen and dining room, perfect for family meals and entertaining, along with a separate cosy lounge for relaxation.

Outside, you'll find a cosy and private outdoor space, ideal for enjoying some fresh air and outdoor activities. Street parking is available for your convenience. The property is situated in a quiet neighbourhood, close to local amenities, schools, and public transport links, such as Birkenhead Park which is less than a two-minute walk from the property.



For those who rely on public transport, the property is conveniently located near the 437-bus route, providing regular services to key destinations like The Met quarter and Birkenhead Bus Station. Birkenhead Central Train Station is also nearby, offering easy access to Mersey rail services for commuting to Liverpool and surrounding areas.

This property is a fantastic opportunity for those looking to settle in a well-connected area with a strong sense of community. Don't miss out on making 47 Mallaby Street your new home!



HALLWAY

18'11" x 5'11" (5.8m x 1.8m)

Front door to front aspect. Carpet to floor. White wooden frames and skirting. Blue paint to walls. Radiator to wall.

LIVING ROOM

14'11" x 11'4" (4.5m x 3.5m)

Door to side aspect. Window to front aspect. Chimney breast to side aspect. Carpet to floors. Radiator to wall. Wallpaper to walls.

DINING ROOM

9'8" x 16'0" (2.9m x 4.9m)

Door to front aspect. carpet to floors. Window to rear aspect. Blue paint to walls. Radiator to wall.

KITCHEN

13'9" x 16'2" (4.2m x 4.9m)

Door to rear aspect. Vinyl to floor. Wallpapered and white painted walls. White gloss upper and lower cupboards. Radiators to wall. Windows to rear aspect.

BATHROOM

7'2" x 4'11" (2.2m x 1.5m)

Door to front aspect. Window to rear aspect. Tiles to walls. Vinyl to floors. Radiator to wall. Bath and toilet to rear aspect.

BEDROOM ONE

9'9" x 5'0" (3m x 1.5m)

Door to front aspect. Window to rear aspect. Carpet to floors. Paint to walls. Radiators to walls.

BEDROOM TWO

8'11" x 9'11" (2.7m x 3m)

Door to side aspect. Carpet to floors. Radiator to wall. Paint to walls.

BEDROOM THREE

14'7" x 9'11" (4.4m x 3m)

The Main Bedroom. Door to side aspect. Large window to front aspect. Carpet to floors. Wallpaper and paint to walls. Radiator to walls.

BEDROOM FOUR

6'7" x 9'0" (2m x 2.7m)

Door too rear aspect. Window to front aspect. Carpet to floors. green paint to walls. Radiator to walls.

DISCLAIMER

We endeavour to make our property particulars as informative & accurate as possible, however, they cannot be relied upon. We recommend all systems and appliances be tested as there is no guarantee as to their ability or efficiency. All photographs, measurements & floorplans have been taken as a guide only and are not precise. If you require clarification or further information on any points, please contact us, especially if you are travelling some distance to view. Solicitors should confirm moveable items described in the sales particulars are, in fact included in the sale due to changes or negotiations. We recommend a final inspection and walk through prior to exchange of contracts. Fixtures & fittings other than those mentioned are to be agreed with the seller.





Ground Floor

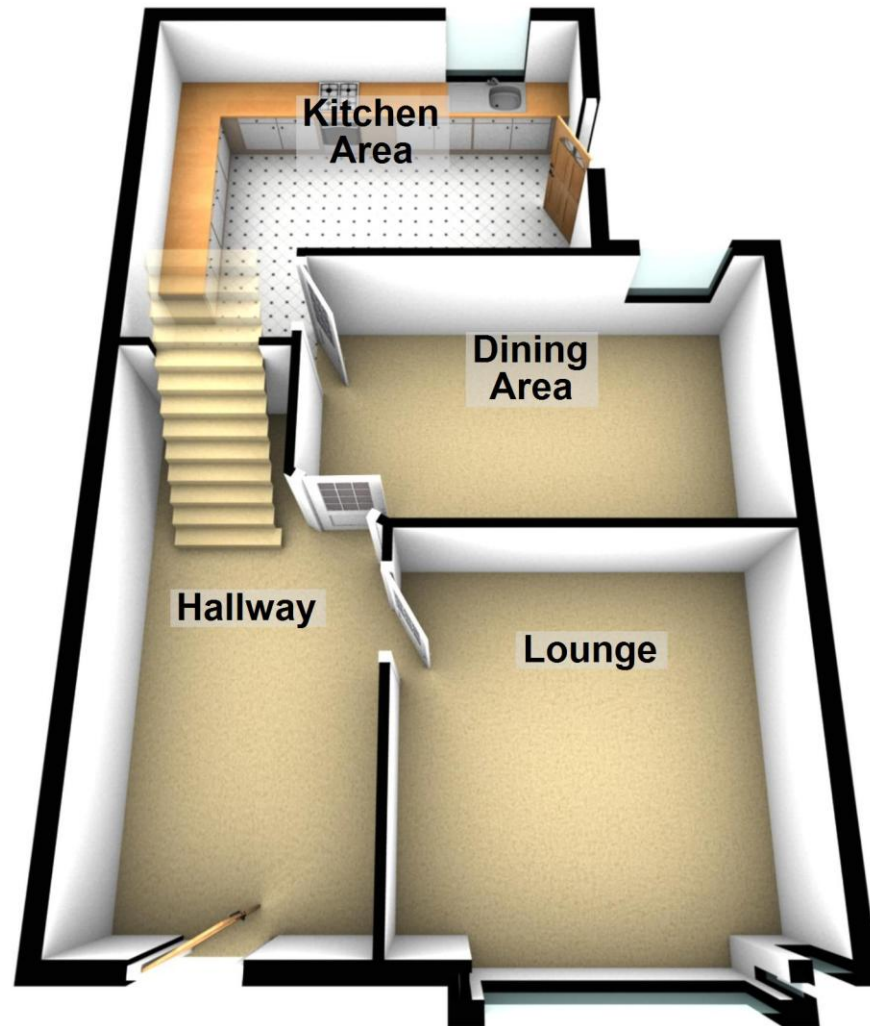

First Floor

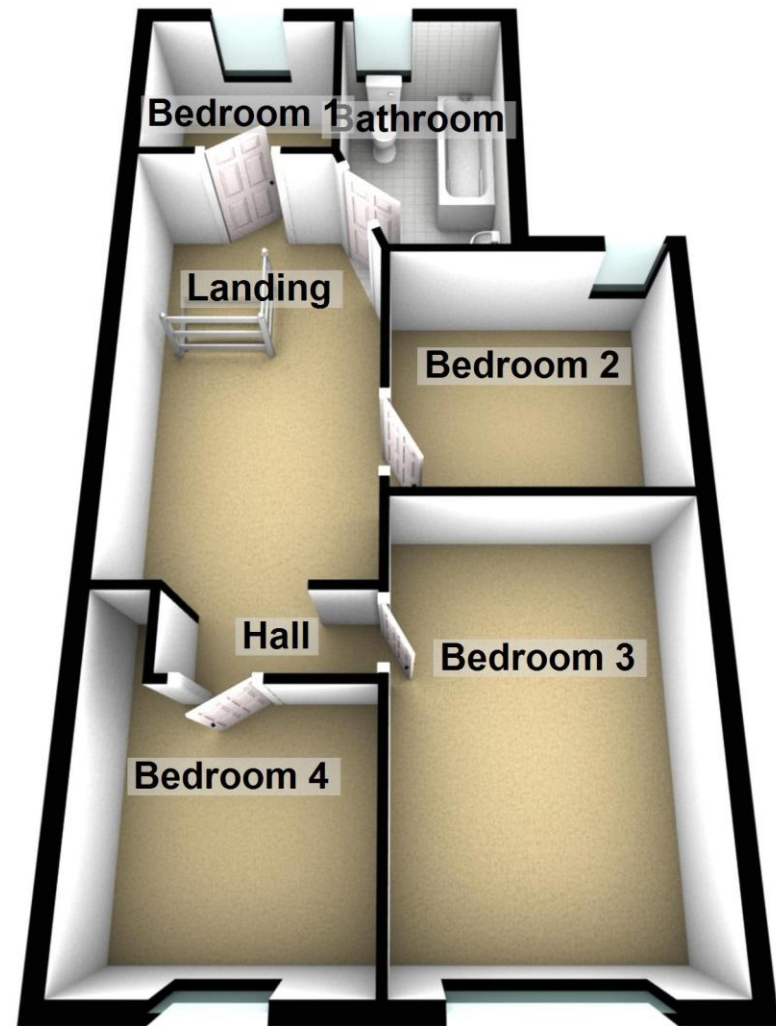



Contact us today to arrange a viewing...

BELVOIR!

<https://www.belvoir.co.uk/liverpool-prescot-estate-agents/>

0151 430 0041