

Cannon Hill Lane Raynes Park, SW20 9ET

£400,000 Leasehold - Share of Freehold



Well presented two double bedroom first floor conversion flat in sought after residential location with its own entrance. A short walk to Wimbledon Chase train station and Raynes park. With a good length lease of over 900 years and being sold with a share of freehold. This is a fantastic property for any buyers looking for a home in the area they can move straight into.

CANNON HILL LANE, SW20

Approx. Gross Internal Floor Area

558 Sq. ft/51.82 Sq. m

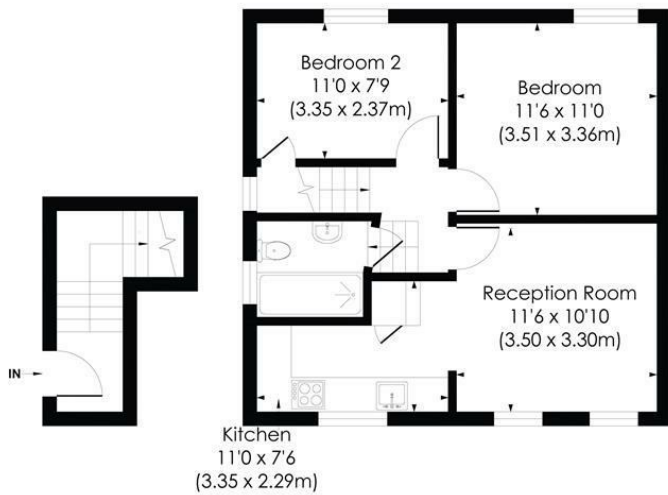

GROUND FLOOR

FIRST FLOOR



© Pixangle Property Marketing Ltd. info@pixangle.com Tel: 0208 870 2118

pixangle PROPERTY MARKETING
This floor plan has been prepared for the purpose of illustration only in accordance with the latest RICS code of measuring practice and is not to scale. All measurements and areas are approximate and whilst every effort has been made to ensure the accuracy of the plan contained here, no responsibility is taken for any error, omission or misstatement.

- First Floor Conversion Flat
- Two Double Bedrooms
- Sought After Location
- Share Of Freehold
- Well Presented Throughout
- Own Entrance / Front Door
- Merton Council Tax Band - C
- EPC - C
- 981 Year Lease Remaining

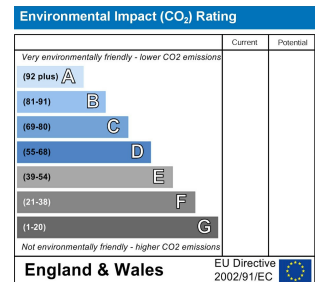
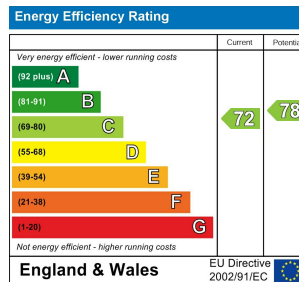

For Free Mortgage Quote and Best Mortgage Rates, call Ellisons Mortgage Advisor on 0208 944 9595



Although these particulars are believed to be correct, their accuracy is not guaranteed and they do not form part of any contract.

Celebrating 30 years of successful Sales and Lettings in Merton

