

Amity Grove West Wimbledon, SW20 0LJ

£2,250 PCM



Centrally located **TWO BEDROOM, TWO BATHROOM**, ground floor Victorian conversion with direct access to a private rear garden and off street parking to the front. Located on a desirable road only 0.2 miles to Raynes Park Station. An excellent property for a professional couple, with private entrance, open plan modern kitchen/reception and two bedrooms (one with en-suite) and modern family bathroom.

Council Tax - D
EPC - D

Amity Grove, SW20

Approximate Gross Internal Area = 51.7 sq m / 556 sq ft

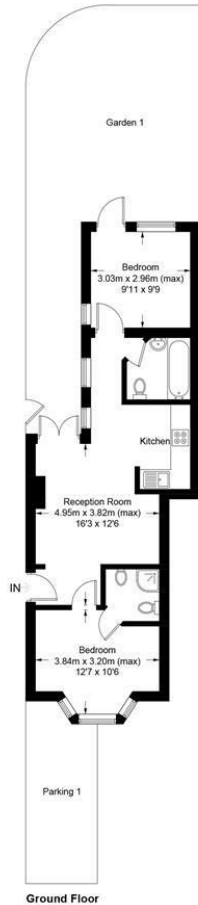

This floor plan is for representation purposes only and is not drawn to scale.

The Gross Internal Area includes outbuildings shown on the plan.

Whilst every attempt has been made to ensure the accuracy of the plan measurements of doors, windows and rooms are approximate only and should be checked before making any decisions reliant upon them.

Copyright Bespokeplans.co.uk (ID783580)



- Two Bedrooms, Two Bathrooms
- Private Rear Garden
- Private Parking To Front
- 0.2 Mile to Station
- Recently refurbished
- First months advance rent
- Five weeks security deposit
- No agency fees
- Council Tax - D
- EPC - D

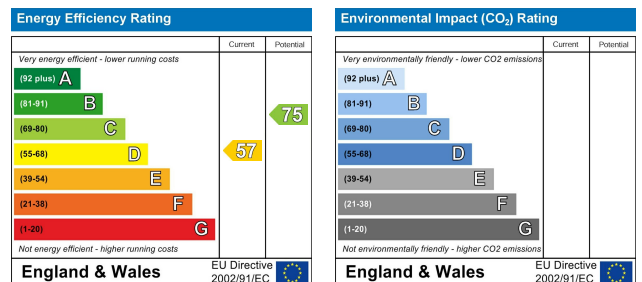

For Free Mortgage Quote and Best Mortgage Rates, call Ellisons Mortgage Advisor on 0208 944 9595



Although these particulars are believed to be correct, their accuracy is not guaranteed and they do not form part of any contract.

Celebrating 30 years of successful Sales and Lettings in Merton

