

Grosvenor Court London Road, SM4 5HG

£265,000 Leasehold



This is a fantastic two bedroom ground floor flat, located within easy access of Morden Underground Station, local facilities and good local bus links. The property is very well presented throughout, and benefits from having double glazing, gas central heating and is being offered to the market with no onward chain. This is the ideal property for an investor or first time buyer looking in the area.

Grosvenor Court, SM4

Approximate Gross Internal Area = 56 sq m / 603 sq ft

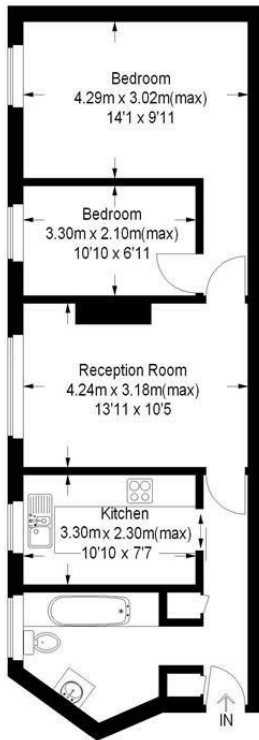

This floor plan is for representation purposes only and is not drawn to scale. Whilst every attempt has been made to ensure its accuracy measurements are approximate only and should be checked before making any decisions reliant upon them.
Copyright Bespokeplans.co.uk 2013
(ID84992)

- Two Bedrooms
- Ground Floor Flat
- Gas Central Heating
- Good Transport Links
- No Onward Chain
- EPC Rating : C
- Merton Council Tax Band : C
- Lease Remaining (Years): 82
- Ground Rent (Per Annum): £150
- Service Charges (Per Annum): £1322

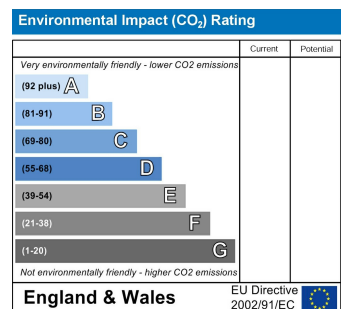
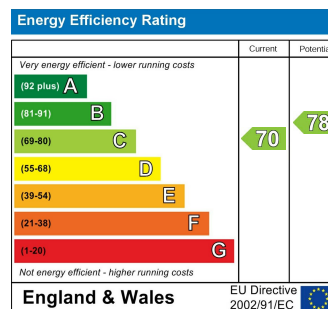

For Free Mortgage Quote and Best Mortgage Rates, call Ellisons Mortgage Advisor on 0208 543 1166



Although these particulars are believed to be correct, their accuracy is not guaranteed and they do not form part of any contract.

Celebrating 30 years
of successful Sales and
Lettings in Merton

