

**Mostyn Road
London, SW19 3LS**

£650,000 Freehold



A beautifully presented three double bedroom, two bathroom extended terraced house with lovely west facing private garden. This stunning property is located near to South Merton railway station in the sought after residential location of Merton Park. A lovely house for any families looking for a home in the area. Being sold with the benefit of no onward chain.

MOSTYN ROAD, SW19

Approx. Gross Internal Floor Area
1080 Sq. ft/100.37 Sq. m (Excluding Eaves)

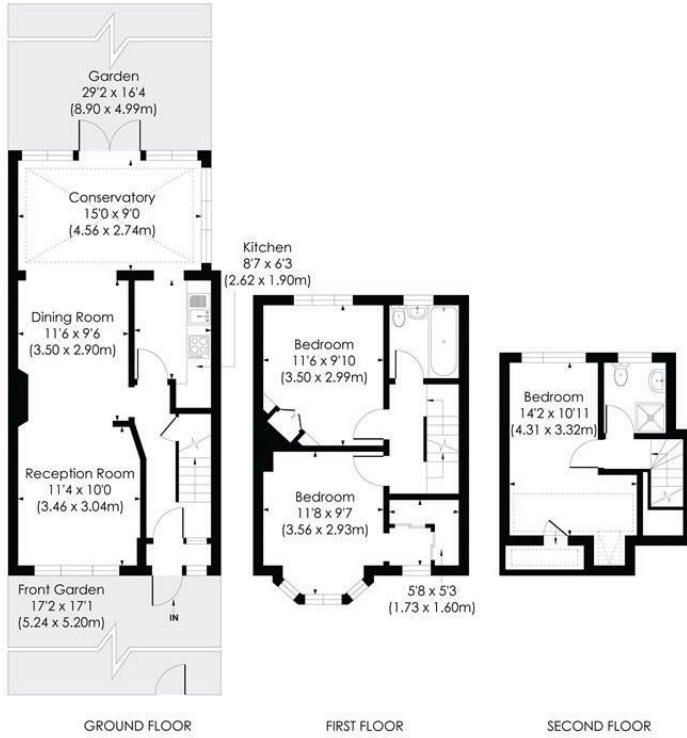

pixangle PROPERTY MARKETING
 This floor plan has been prepared for the purpose of illustration only in accordance with the latestRICS code of measuring practice and is not to scale. All measurements and areas are approximate and whilst every effort has been made to ensure the accuracy of the plan contained here, no responsibility is taken for any error, omission or misstatement.

- Three double bedrooms
- Lovely condition throughout
- No onward chain
- Private West facing garden
- Sought After location
- Near to South Merton Train Station
- EPC- D
- Merton Council Tax Band - E

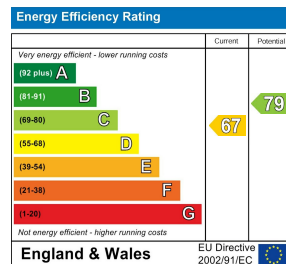

For Free Mortgage Quote and Best Mortgage Rates, call Ellisons Mortgage Advisor on 0208 543 1166



Although these particulars are believed to be correct, their accuracy is not guaranteed and they do not form part of any contract.

Celebrating 30 years of successful Sales and Lettings in Merton

