

**Heyford Avenue
London, SW20 9JT**

£375,000 Leasehold



A beautifully presented two bedroom ground floor purpose built maisonette with lovely private garden. Located in a sought after cul de sac in a residential location and near to Thames Link over ground station and Morden Town Centre and Tube Station. This is a fantastic property for any buyers looking for a home they can move straight into.

HEYFORD AVENUE, SW20

Approx. Gross Internal Floor Area
661 Sq. ft/61.39 Sq. m

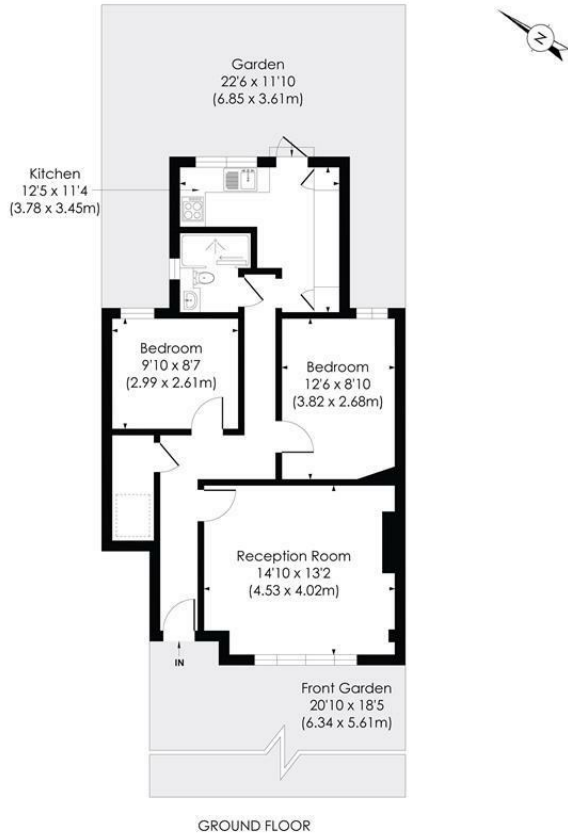

© Pixangle Property Marketing Ltd. info@pixangle.com Tel: 0208 870 2118



This floor plan has been prepared for the purpose of illustration only in accordance with the latest RICS code of measuring practice and is not to scale. All measurements and areas are approximate and whilst every effort has been made to ensure the accuracy of the plan contained here, no responsibility is taken for any error, omission or misstatement.

- Purpose Built Maisonette
- Two bedrooms
- Lovely private Garden
- Well Presented throughout
- Sought after location
- Near to transport
- EPC - E
- Council Tax Band - C

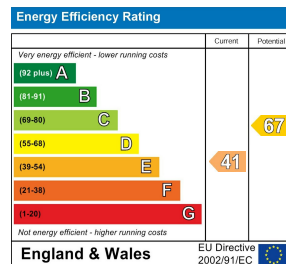

For Free Mortgage Quote and Best Mortgage Rates, call Ellisons Mortgage Advisor on 0208 543 1166



Although these particulars are believed to be correct, their accuracy is not guaranteed and they do not form part of any contract.

Celebrating 30 years of successful Sales and Lettings in Merton

