

Alexandra Road Wimbledon, SW19 7JZ

£275,000 Leasehold

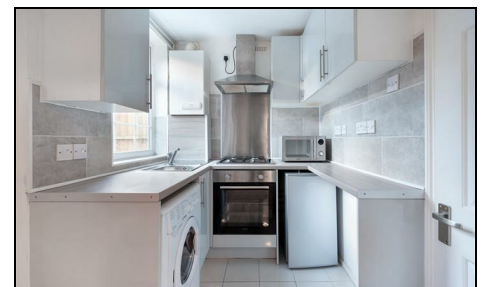

A ground floor garden studio flat offered to the market with no onward chain and located only moments from Wimbledon Town Centre and Mainline Station. Located at the rear of a Victorian semi-detached conversion, boasting a private entrance, front garden and both a modern kitchen and bathroom. Alexandra Road is positioned next to Wimbledon High Street with its numerous restaurants, shops and amenities, and also walking distance to Wimbledon Village. With a long lease and low maintenance costs this is a brilliant first time purchase or buy to let investment.

ALEXANDRA ROAD, SW19

Approx. Gross Internal Floor Area

305 Sq. ft/ 28.30 Sq. m

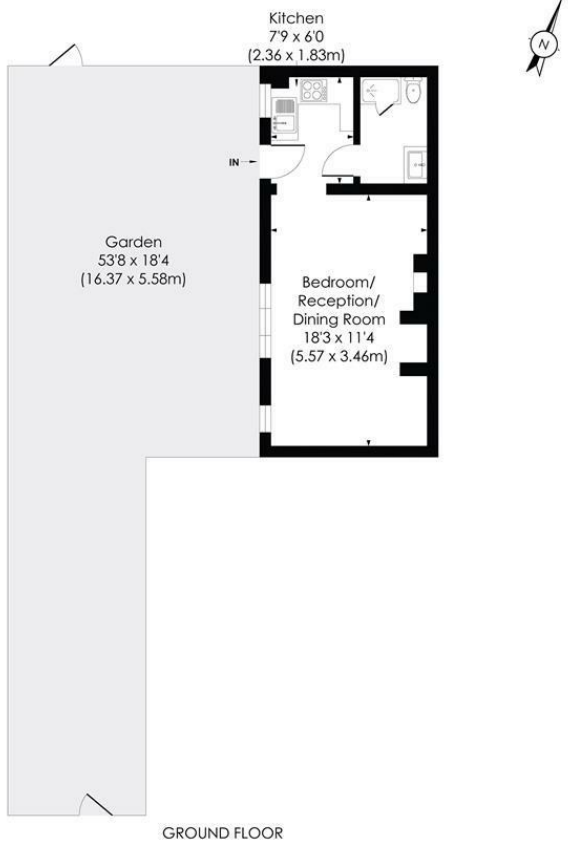

pixangle
PROPERTY MARKETING

© Pixangle Property Marketing Ltd. info @pixangle.com Tel: 0208 870 2118
This floor plan has been prepared for illustration purposes only, in accordance with the latest RICS code of measuring and is not to scale.
All measurements and areas are approximate and whilst every effort has been made to ensure the accuracy of the plan contained here, no responsibility is taken for any error, omission or misstatement.

- Ground Floor Studio Flat
- Garden
- Private Entrance
- Moments from Wimbledon Town Centre and Mainline Station
- No Onward Chain
- Superb First Time Purchase or Buy to Let Investment
- Leasehold - 211 years remaining
- Annual Ground Rent - Peppercorn, Annual Service Charges - Ad-hoc
- EPC Rating C
- Council Tax Band B

Energy Efficiency Rating		Current	Potential
Very energy efficient - lower running costs			
(92 plus) A			
(81-91) B			
(69-80) C		71	73
(55-68) D			
(39-54) E			
(21-38) F			
(1-20) G			
Not energy efficient - higher running costs			
England & Wales		EU Directive 2002/91/EC	

For Free Mortgage Quote and Best Mortgage Rates, call an Ellisons Mortgage Advisor on 020 8944 9494



Although these particulars are believed to be correct, their accuracy is not guaranteed and they do not form part of any contract.

Celebrating 30 years of successful Sales and Lettings in Merton

