

WEST BARNES LANE, KT3  
Approx. Gross Internal Floor Area  
472 Sq. ft/43.88 Sq. m

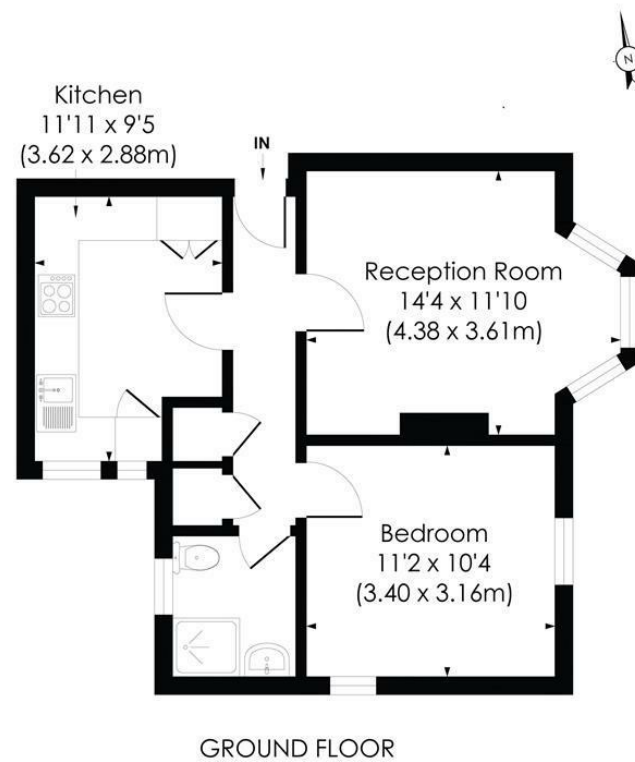

© Pixangle Property Marketing Ltd. info@pixangle.com Tel: 0208 870 2118  
This floor plan has been prepared for the purpose of illustration only in accordance with the latest RICS code of measuring practice and is not to scale. All measurements and areas are approximate and whilst every effort has been made to ensure the accuracy of the plan contained here, no responsibility is taken for any error, omission or misstatement.

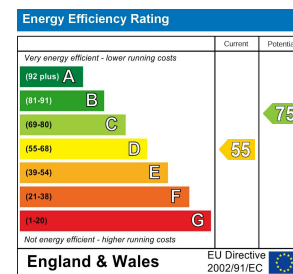

**£300,000: Leasehold**

This spacious one double bedroom, ground floor apartment is ideally located for both Raynes Park and Motspur Park Stations. An ideal first/second time purchase or but to let investment, with good sized kitchen, modern shower room, separate reception room and double bedroom. Offered to the market with no onward chain.



This spacious one double bedroom, ground floor apartment is ideally located for both Raynes Park and Motspur Park Stations. An ideal first/second time purchase or but to let investment, with good sized kitchen, modern shower room, separate reception room and double bedroom. Offered to the market with no onward chain.



### SPECIFICATION:

- One Double Bedroom
- Ground Floor Apartment
- Spacious Kitchen
- Modern Shower Room
- No Onward Chain
- Remaining Lease - 78 Years
- Ground Rent - £200 PA
- Service Charge - £1243.13 PA
- EPC Rating - D
- Council Tax Band - B