



## Cantrell Lodge 759-761 Hertford Road, Enfield

£210,000 Leasehold

GROUND FLOOR MAISONETTE • ONE DOUBLE BEDROOM • SPACIOUS LIVING ROOM • FITTED KITCHEN • COMMUNAL GARDEN • AMPLE RESIDENT PARKING • NEAR TO AMENITIES • CLOSE TO STATION • LEASEHOLD • EPC RATING - D

**KINGS**  
SALES LETTINGS MANAGEMENT

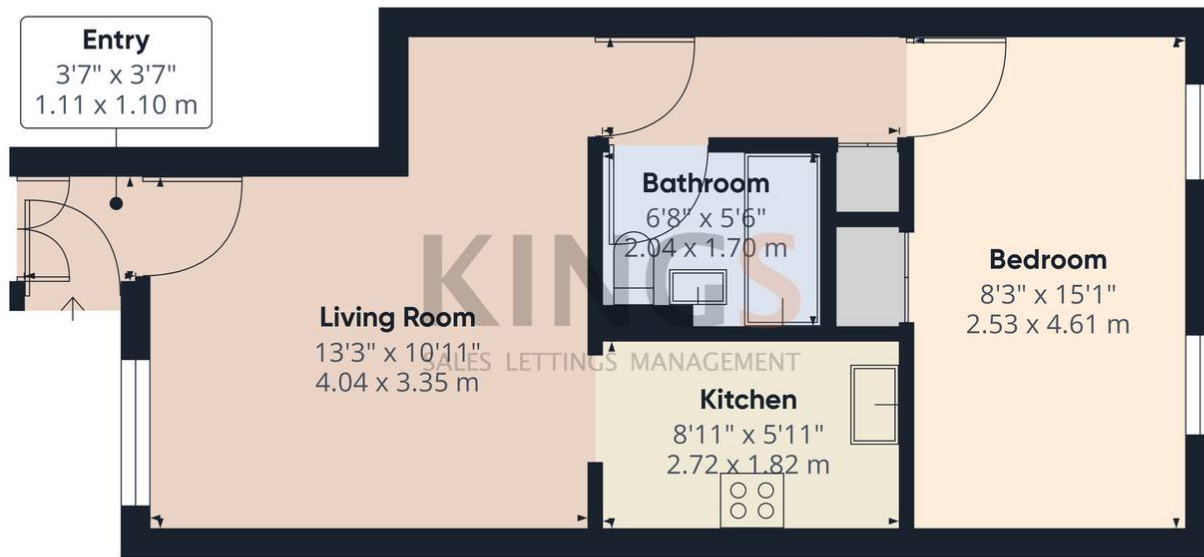

Approximate total area<sup>(1)</sup>  
433.57 ft<sup>2</sup>  
40.28 m<sup>2</sup>

(1) Excluding balconies and terraces

While every attempt has been made to ensure accuracy, all measurements are approximate, not to scale. This floor plan is for illustrative purposes only.

Calculations are based on RICS IPMS 3C standard.

GIRAFFE360

