



## Atlas Building, Shilton Road, Barwell, LE9 8HA

£120,000

 1  1  1



- 1 Bedroom
- Large Lounge
- Storage Space
- Parking
- Extremely Spacious
- Modern Decor
- Dining Area
- Modern Bathroom
- Local Amenities
- Good Access to Major Roads

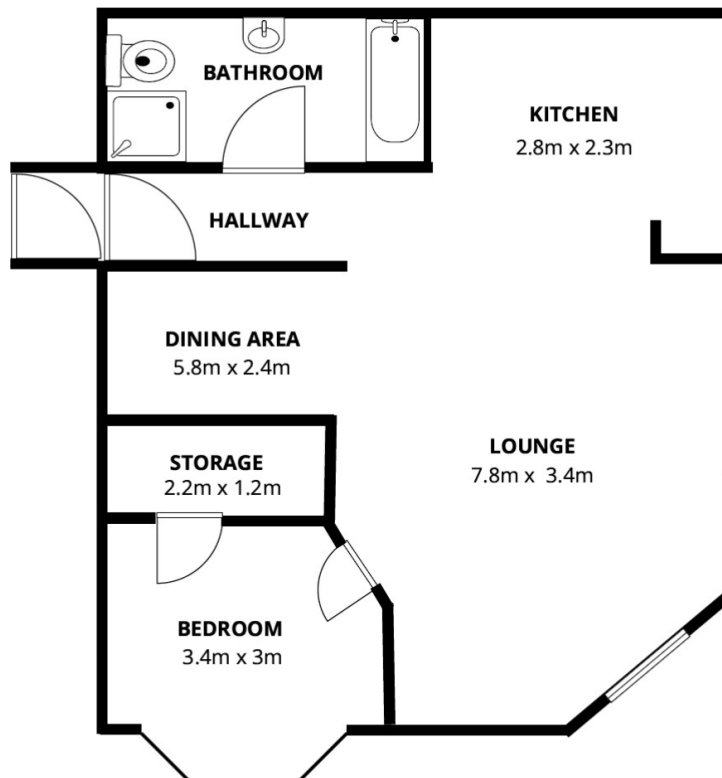

For illustrative purposes only.  
Measurements are approximate and floorplan should be used as a guide.

Caldecott Property are proud to bring to market this extremely spacious first-floor apartment. NO CHAIN. Extremely spacious first floor apartment in this sympathetically converted factory. Popular and highly convenient location within walking distance of the village centre including shops, schools, Doctors/Dentists, bus services, parks, pubs and takeaways with good access to major road links. Benefits from inset ceiling spotlights, gas central heating and SUDG.

Offers entrance hall, bathroom with separate bath and shower, open plan living and dining space along with a good sized kitchen. One double bedroom with storage cupboard. Allocated car parking space and bin store. Ideal First Time Buy or Buy to Let investment.





**CALDECOTT**

PROPERTY SALES & LETTINGS

**Phone Number:**

01788 221994

**Email:**

*Hello@caldecottproperty.co.uk*

**Website:**

*www.caldecottproperty.co.uk*