



FOUR BEDROOM
DETACHED HOUSE



Tantabank Gardens

DALTON-IN-FURNESS

Bowfell

HOUSE DESCRIPTION

This elegant four-bedroom detached home offers a stylish and comfortable lifestyle with its spacious living accommodation.

The ground floor features a generously sized lounge that is bathed in natural light from a beautiful bay-fronted window. The fully integrated German made kitchen includes an open-plan family/dining area. French doors provide easy access to the rear garden

and private patio area. Additional amenities on the ground floor include a utility room, cloakroom, and integral garage.

On the upper floor, you will discover a luxurious family bathroom along with four well-proportioned bedrooms. Among them is the master bedroom which boasts an en-suite shower room.

FLOOR PLAN DIMENSIONS

GROUND FLOOR

Kitchen/Diner (max)	5.59m x 3.85m
Lounge (max)	3.41m x 5.17m
Utility	1.90m x 1.94m
Garage (max)	2.95m x 5.14m

FIRST FLOOR

Master Bedroom (max)	3.41m x 4.10m
En-Suite (max)	1.64m x 1.84m
Bedroom 2 (max)	3.04m x 3.40m
Bedroom 3 (max)	2.80m x 3.01m
Bedroom 4	2.66m x 2.83m
Bathroom (max)	1.91m x 2.83m

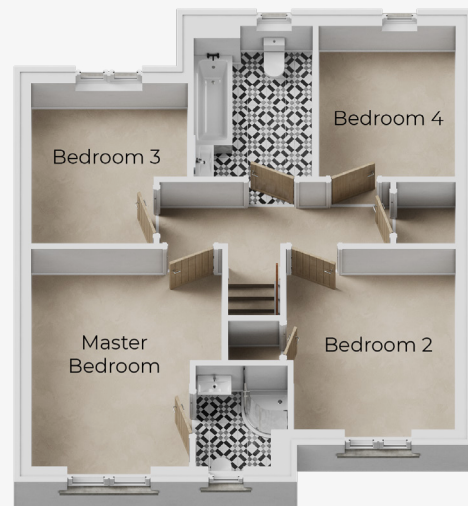

The images shown are for illustration purposes only. Whilst every care is taken to ensure accuracy of information contained in this brochure, we cannot take responsibility for any error or misdescription and we reserve the right to alter or amend designs and specifications without prior notice. The information contained herein is for guidance only and does not form part of any contract or warranty. External finishes may vary from those shown and any dimensions given are approximate and sizes may vary from those indicated.

Properties may be built handed (mirror image). External materials, landscaping, garage and window positions may vary to suit the location of individual homes. Elevational treatments may vary to those shown, please speak to our New Homes Advisor for the details regarding individual plot specifications.