



21 Byron Close, Sandbach, CW11 3GF

Offers Over £240,000





21 Byron Close

Sandbach, CW11 3GF

Take a moment to view our guided tour of this deceptively spacious semi-detached home with a private rear garden, off road parking and garage!

A wonderful three bedroom family home with the added benefit of great outside space, a detached single garage and all nestled in the ever popular location of Ettiley Heath. Perfect first time buy or for those wanting to upsize!

The property briefly comprises: a welcoming entrance hallway with downstairs cloakroom, a lounge to the front and open-plan kitchen diner at the rear of the property, complete with French doors having a pleasant aspect overlooking the rear garden. Upstairs, there are three well-balanced bedrooms accessed via the landing and a family bathroom. Externally, there are gardens to both the front and rear with driveway parking and a single garage.

Sandbach is a thriving South Cheshire market town with historical monuments dating back to Anglo-Saxon times. Day to day essentials are easily accessible, with a range of speciality shops including bakers, grocers, delis, restaurants, boutiques, coffee shops, Waitrose, florists, fashion shops etc. On Thursdays a popular traditional Elizabethan street market extends into the Town Hall. There is also a Farmers Market every second Saturday of the month on the cobbled square!

Excellent travel and commuting links are provided by; quick access to the M6 Motorway junction 17, Sandbach railway station provides good links to Manchester, frequent trains from Crewe mainline railway station conveniently link Cheshire to London in under 2 hours and Manchester International Airport is only a 40 minute drive away! In addition, local schools for both primary & secondary students are held in high repute, many families move into the area with this in mind.

So, what's not to love! View our video, photos & floorplan, then call the experts here at Chris Hamriding to book that all-important viewing!



Offers Over £240,000



Accommodation	
Entrance Lobby	6'5" x 3'8" (1.96 x 1.12)
Cloakroom	5'10" x 2'8" (1.79 x 0.82)
Lounge	14'9" x 14'7" (4.52 x 4.45)
Open-Plan Kitchen/Diner	14'9" x 10'1" (4.50 x 3.09)
First Floor Landing	9'3" x 7'4" (2.83 x 2.26)
Bedroom One	10'11" x 10'9" (3.35 x 3.28)
Bedroom Two	13'9" x 8'1" (4.20 x 2.47)
Bedroom Three	8'1" x 6'4" (2.48 x 1.95)
Bathroom	6'4" x 6'3" (1.94 x 1.91)
Garage	16'7" x 8'0" (5.07 x 2.46)



Directions





Floor Plans

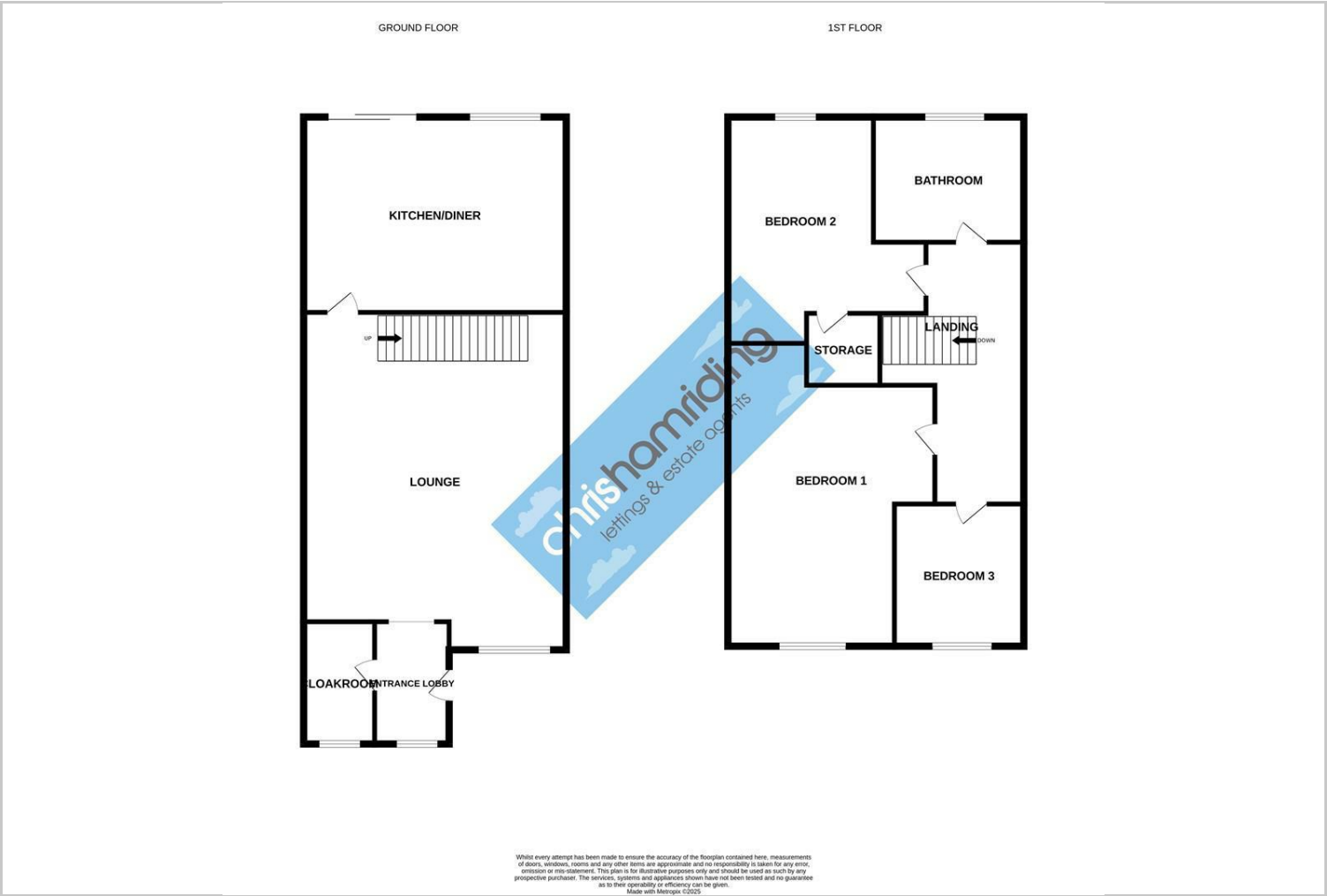

Area Map



Energy Performance Graph

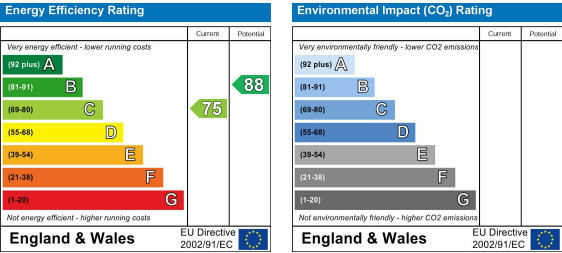

Viewing

Please contact our Sandbach Office on 01270 346500 if you wish to arrange a viewing appointment for this property or require further information.

NOTICE Chris Hamriding Lettings & Estate Agents for themselves and for the vendor or lessors of this property whose agents they are given notice that: (i) the particulars are set out as a general outline only for the guidance of intending purchasers or lessees, and do not constitute, nor constitute part of, an offer of contract, (ii), all descriptions, dimensions, references to condition and necessary permissions for use and occupation, and other details are given in good faith and are believed to be correct but any intending purchasers or tenants should not rely on them as statement or representation of fact but must satisfy themselves by inspection or otherwise as to the correctness of each of them, (iii) no person in the employment of Chris Hamriding Lettings & Estate Agents has any authority to make or give any representation or warranty whatever in relation to this property.