

chris hamriding

lettings & estate agents



84 Crewe Road, Sandbach, CW11 4NU

Offers In The Region Of £365,000

Take a moment to view our signature, guided tour of this impressive home!

Positioned on Crewe Road in the charming town of Sandbach, this delightful detached bungalow offers beautifully appointed accommodation that is sure to impress! With two well-proportioned double bedrooms and a thoughtfully redesigned shower room, this property is perfect for those seeking 'one-level living' and being just a short walk to the centre of Sandbach.

The heart of the home has to be the lounge at the rear, which forms part of an extension to the bungalow in more recent years, enjoying a pleasant aspect over the rear garden with large French doors framing the garden plus designer wood burning stove being a lovely feature of the room. Another impressive addition to the home is the high specification kitchen, with its deep storage and space for a dining table, providing ample room for culinary creativity and entertaining guests. The modern fittings and stylish design make this kitchen a true highlight of the property. The bedrooms are well-planned, being both double rooms and having built-in robes to the principle room. The shower room is also exceptional quality with a large shower tray, contemporary tiling, LVT flooring and a wealth of useful storage.

Step outside to discover the beautiful rear garden, a tranquil oasis perfect for enjoying the outdoors which has been cleverly zoned with a variety of seating areas. Whether you wish to cultivate your green thumb or

Accommodation

Entrance Hall 20'0" x 6'2" (6.098 x 1.902)

Lounge 14'7" x 13'9" (4.464 x 4.208)

Open-plan Kitchen/Diner 14'4" x 13'11" (4.393 x 4.259)

Bedroom One 12'8" x 10'11" (3.861 x 3.335)

Bedroom Two 11'3" x 7'11" (3.437 x 2.431)

Shower Room 7'8" x 7'2" (2.355 x 2.198)

First Floor Landing 14'3" x 4'9" (4.347 x 1.470)

Loft Room 13'10" x 5'9" (4.217 x 1.772)

Floor Plan

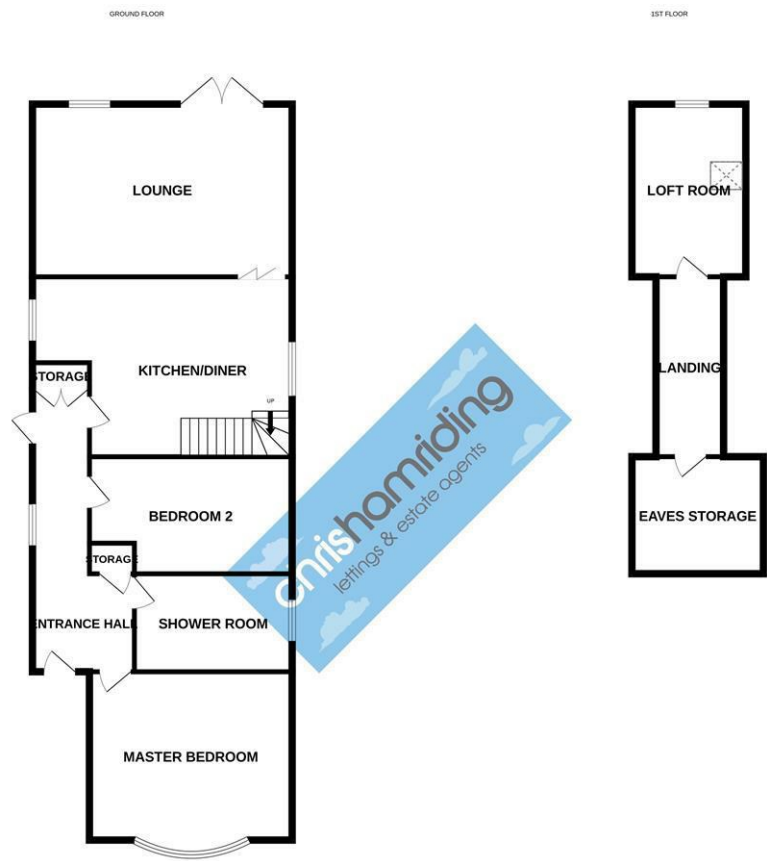

Whilst every attempt has been made to ensure the accuracy of the floorplan contained here, measurements of doors, windows, rooms and any other items are approximate and no responsibility is taken for any error, omission or mis-statement. This plan is for illustrative purposes only and should be used as such by any prospective purchaser. The services, systems and appliances shown have not been tested and no guarantee as to their operability or efficiency can be given.
Made with Metropix ©2025

Area Map

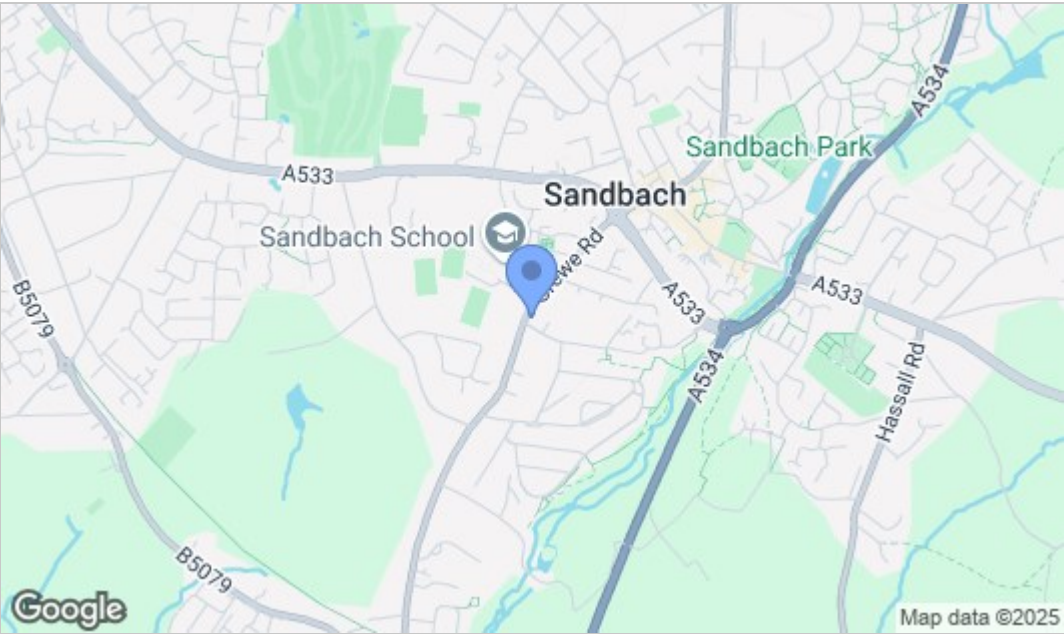

Energy Efficiency Graph

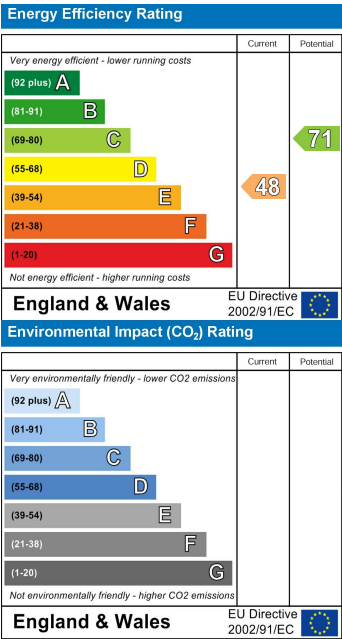

NOTICE Chris Hamriding Lettings & Estate Agents for themselves and for the vendor or lessors of this property whose agents they are given notice that: (i) the particulars are set out as a general outline only for the guidance of intending purchasers or lessees, and do not constitute, nor constitute part of, an offer of contract, (ii), all descriptions, dimensions, references to condition and necessary permissions for use and occupation, and other details are given in good faith and are believed to be correct but any intending purchasers or tenants should not rely on them as statement or representation of fact but must satisfy themselves by inspection or otherwise as to the correctness of each of them, (iii) no person in the employment of Chris Hamriding Lettings & Estate Agents has any authority to make or give any representation or warranty whatever in relation to this property.