

chris hamriding

lettings & estate agents



31a Woodside Avenue, Alsager, ST7 2DL

Offers In The Region Of £169,950

Take a moment to view our signature, guided tour of this fantastic offering! The perfect first time buy!

Positioned on an established estate in the charming village Alsager, this delightful semi-detached home offers a perfect blend of comfort and modern living whilst being located close to the village centre along with its growing variety of amenities and highly regarded schooling. With two spacious reception rooms on the ground floor plus a dining/kitchen, this property provides ample space for both relaxation and entertaining. The two bedrooms on the first floor are well balanced and both are comfortable double rooms.

The home features a well-appointed family bathroom located upstairs, along with a convenient downstairs cloakroom, making it ideal for both families and guests alike. The extended garden room at the rear of the property invites natural light and offers a versatile space that can be used as a playroom, study, or simply a serene spot to enjoy the garden!

For those wanting parking, the property boasts tandem parking for two vehicles. Additionally, this energy-efficient home is designed to help reduce utility costs and is also council tax band A, the lowest band you can achieve.

The home enjoys plenty of glazing throughout and French doors to both the garden room and lounge - The garden room leads out to a manageable and mature rear garden, perfect for enjoying during the summer

Accommodation

Entrance Hall 4'10" x 3'4" (1.498 x 1.019)

Kitchen 14'0" x 8'11" (4.276 x 2.738)

Cloakroom 4'4" x 3'6" (1.335 x 1.079)

Lounge 13'11" x 12'7" (4.263 x 3.857)

Conservatory 9'11" x 9'10" (3.037 x 3.013)

First Floor Landing 12'3" x 6'7" (3.734 x 2.016)

Bedroom One 13'11" x 9'4" (4.256 x 2.856)

Bedroom Two 14'0" x 8'3" (4.286 x 2.528)

Bathroom 8'11" x 4'10" (2.733 x 1.485)

Floor Plan

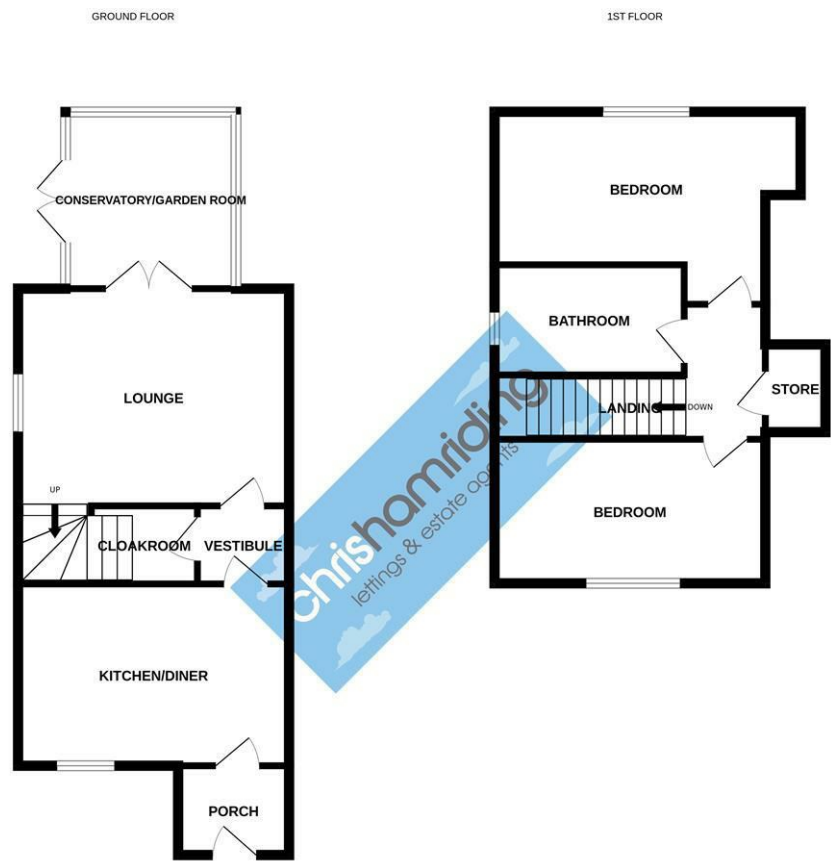

Whilst every attempt has been made to ensure the accuracy of the floorplan contained here, measurements of doors, windows, rooms and any other terms are approximate and no responsibility is taken for any error, omission or mis-statement. This plan is for illustrative purposes only and should be used as such by any prospective purchaser. The services, systems and appliances shown have not been tested and no guarantee as to their operability or efficiency can be given. Made with Metropix ©2025

Area Map

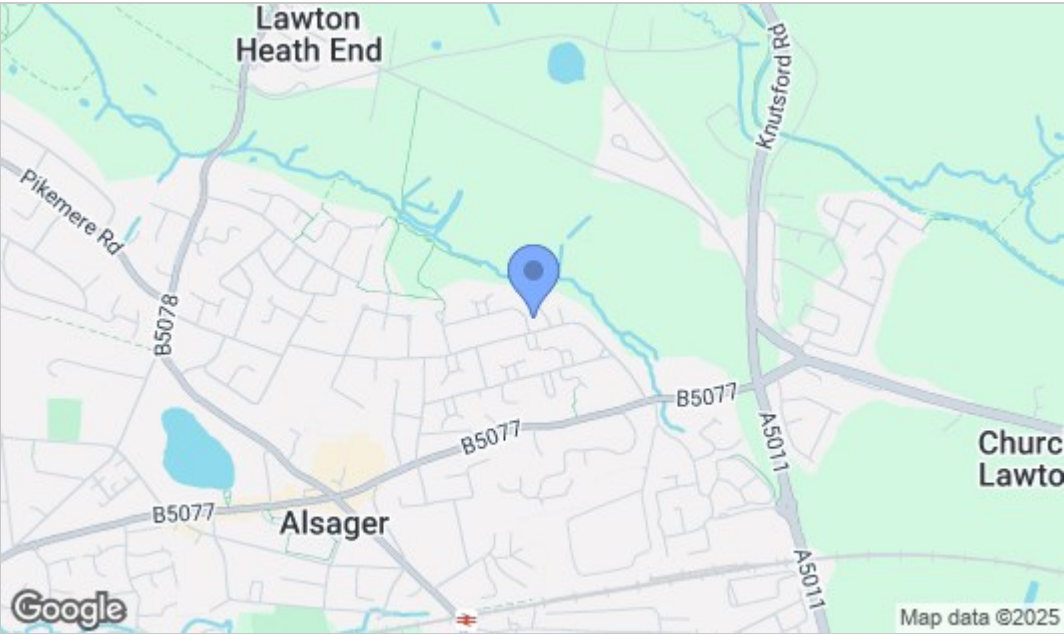

Energy Efficiency Graph

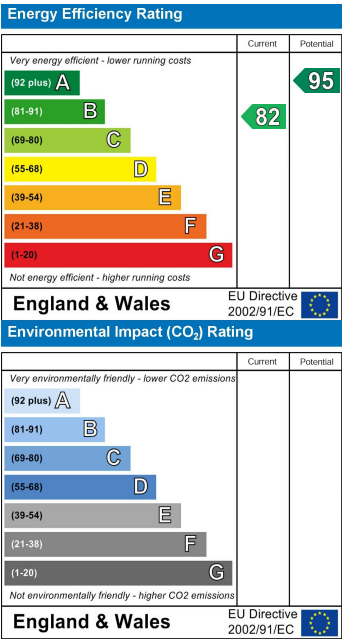

NOTICE Chris Hamriding Lettings & Estate Agents for themselves and for the vendor or lessors of this property whose agents they are given notice that: (i) the particulars are set out as a general outline only for the guidance of intending purchasers or lessees, and do not constitute, nor constitute part of, an offer of contract, (ii), all descriptions, dimensions, references to condition and necessary permissions for use and occupation, and other details are given in good faith and are believed to be correct but any intending purchasers or tenants should not rely on them as statement or representation of fact but must satisfy themselves by inspection or otherwise as to the correctness of each of them, (iii) no person in the employment of Chris Hamriding Lettings & Estate Agents has any authority to make or give any representation or warranty whatever in relation to this property.