



Green Road
Baiter Park Poole BH15 1QW
£1,350 Per month

D/E

DAVIDSON ESTATES
sales & lettings





Details

Ideally located in the sought after Baiter Park area, this well presented two double bedroom mid-terrace house has been recently redecorated throughout, featuring brand new carpets. This home offers a fresh and modern feel within walking distance of Poole Quay, the town centre, and stunning harbourside walks.

Property Comprises

Upon entering you are welcomed into a spacious lounge diner with feature bay window, leading through to the kitchen complete with appliances, located at the rear of the house, offering a practical layout and features a side door that leads directly to the garden.

Upstairs, you will find a large master bedroom, alongside a second double bedroom. The main family bathroom completes the upper floor with separate bath and shower.

The rear courtyard garden is a delightful feature, basking in sunny south-west exposure. Additionally, there is on-street parking available, with permits obtainable through the local council.

This property is ideally located just a short distance from Poole Town Centre, The Quay, and the picturesque Harbourside, providing a flat and pleasant walk across to Whitecliff.

Available now on an unfurnished basis. Furnishings are also available to stay.

EPC Rating - D
Council Tax Band - C







More Information

- South Westerly Garden
- Close Proximity to Harbour
- Recently Redecorated
- Desirable Location
- Spacious Accommodation
- New Carpets

Property Requirements

No Pets
No Smokers

You must be able to pass a credit check to rent this property
Annual Income Criteria 30 X Monthly Rent (£40,500)

Davidson Estates

To see our properties before they go on the market please like us on Facebook (Davidson Estates Sales & Lettings), Instagram (davidsonsestates) & YouTube (davidsonsestates)

Copyright

All photos, video, and drone footage are copyrighted by Davidson Estates Sales & Lettings LTD. All rights reserved.

Any redistribution or reproduction of part or all of the contents in any form is prohibited other than the following:

1. You may print or download to local hard disk extracts for your personal and non-commercial use only
2. You may copy the content to individual third parties for their personal use, but only if you acknowledge Davidson Estates as the source of the material

You may not, except with our express written permission, distribute or commercially exploit the content. Nor may you transmit it or store it on any other website or another form of the electronic retrieval system.



hello@davidsonsestates.com | davidsonsestates.com

GROUND FLOOR
425 sq.ft. (39.5 sq.m.) approx.

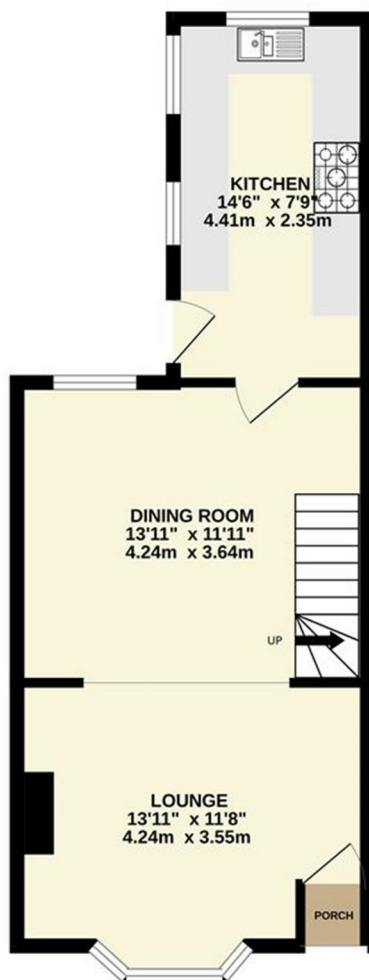

1ST FLOOR
382 sq.ft. (35.5 sq.m.) approx.



TOTAL FLOOR AREA : 807 sq.ft. (75.0 sq.m.) approx.

Whilst every attempt has been made to ensure the accuracy of the floorplan contained here, measurements of doors, windows, rooms and any other items are approximate and no responsibility is taken for any error, omission or mis-statement. This plan is for illustrative purposes only and should be used as such by any prospective purchaser. The services, systems and appliances shown have not been tested and no guarantee as to their operability or efficiency can be given.
Made with Metropix G2025



CONTACT US

Whichever way suits you...

07557 025044 | 07713 870543

hello@davidsonsestates.com

01202 287606

www.davidsonsestates.com

