



Green Road
Baiter Park Poole BH15 1QW
£315,000







Details

Nestled in the charming Baiter Park area, this mid-terrace house on Green Road presents a wonderful opportunity for those looking to create their dream home in an ideal location.

Property Comprises

Upon entering, you are welcomed into a spacious lounge diner, leading through to the kitchen, located at the rear of the house, offering a practical layout and features a side door that leads directly to the garden.

Upstairs, you will find a large master bedroom that provides ample room for furnishings, alongside a second double bedroom. The main family bathroom completes the upper floor with separate bath and shower.

The rear courtyard garden is a delightful feature, basking in sunny south-west exposure. Additionally, there is on-street parking available, with permits obtainable through the local council.

This property is ideally located just a short distance from Poole Town Centre, The Quay, and the picturesque Harbourside, providing a flat and pleasant walk across to Whitecliff. While the house is in need of renovation, it offers a blank canvas for those with vision and creativity. This is a rare opportunity to invest in a property in such a desirable location, making it a must-see for potential buyers.







More Information

- South Westerly Garden
- Close Proximity to Harbour
- Two Double Bedrooms
 - Desirable Location
- Spacious Accommodation
 - No Forward Chain

Tenure

Tenure: Freehold

EPC Rating: D

Council Tax: BCP Council, Band C

Davidson Estates

To see our properties before they go on the market please like us on Facebook (Davidson Estates Sales & Lettings), Instagram (davidsonsestates) & YouTube (davidsonsestates)

Copyright

All photos, video, and drone footage are copyrighted by Davidson Estates Sales & Lettings LTD. All rights reserved.

Any redistribution or reproduction of part or all of the contents in any form is prohibited other than the following:

1. You may print or download to local hard disk extracts for your personal and non-commercial use only
2. You may copy the content to individual third parties for their personal use, but only if you acknowledge Davidson Estates as the source of the material

You may not, except with our express written permission, distribute or commercially exploit the content. Nor may you transmit it or store it on any other website or another form of the electronic retrieval system.



hello@davidsonsestates.com | davidsonsestates.com

GROUND FLOOR
429 sq.ft. (39.8 sq.m.) approx.

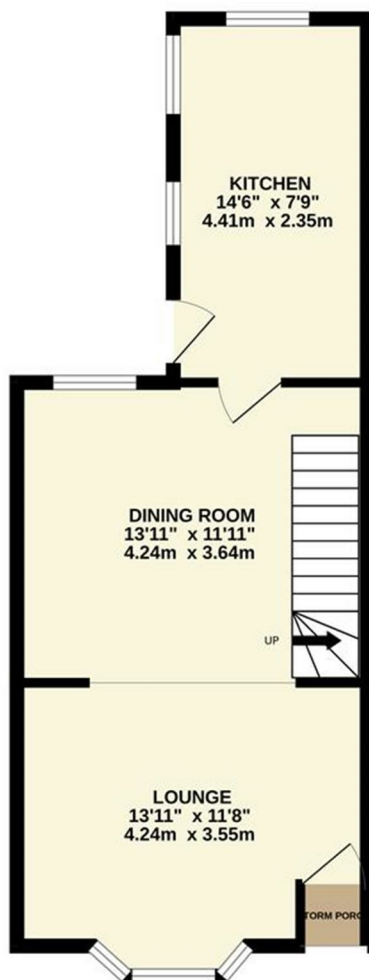

1ST FLOOR
388 sq.ft. (36.0 sq.m.) approx.



TOTAL FLOOR AREA : 817 sq.ft. (75.9 sq.m.) approx.

Whilst every attempt has been made to ensure the accuracy of the floorplan contained here, measurements of doors, windows, rooms and any other items are approximate and no responsibility is taken for any error, omission or mis-statement. This plan is for illustrative purposes only and should be used as such by any prospective purchaser. The services, systems and appliances shown have not been tested and no guarantee as to their operability or efficiency can be given.
Made with Metropix C3205



CONTACT US

Whichever way suits you...

07557 025044 | 07713 870543

hello@davidsonsestates.com

01202 287606

www.davidsonsestates.com

