



Bredy Close
Poole BH17 9JP
£239,950





Details

Nestled in Bredy Close, West Canford Heath, this delightful one-bedroom terraced house offers a perfect blend of modern living and comfort.

Property Comprises

The property features an entrance porch that leads into a spacious living area, a modern kitchen complete with back door that opens directly into the rear garden.

Upstairs, the landing includes fitted storage, maximising the use of space into the master bedroom which is generously sized and also benefits from a built-in cupboard. The modern bathroom equipped with walk in shower and vanity storage.

Outside the property offers parking for two vehicles to the front and a rear garden laid to lawn and patio.

Tenure

Tenure: Freehold

EPC Rating: D

Council Tax: BCP Council, Band B





More Information

- Ideal First Time Buy
- Allocated Parking
- Modern Kitchen
- Modern Shower Room
- One Bedroom
- Rear Garden

Davidson Estates

To see our properties before they go on the market please like us on Facebook (Davidson Estates Sales & Lettings), Instagram (davidsonsestates) & YouTube (davidsonsestates)

Copyright

All photos, video, and drone footage are copyrighted by Davidson Estates Sales & Lettings LTD. All rights reserved.

Any redistribution or reproduction of part or all of the contents in any form is prohibited other than the following:

1. You may print or download to local hard disk extracts for your personal and non-commercial use only
2. You may copy the content to individual third parties for their personal use, but only if you acknowledge Davidson Estates as the source of the material

You may not, except with our express written permission, distribute or commercially exploit the content. Nor may you transmit it or store it on any other website or another form of the electronic retrieval system.



hello@davidsonsestates.com | davidsonsestates.com

GROUND FLOOR
247 sq.ft. (22.9 sq.m.) approx.

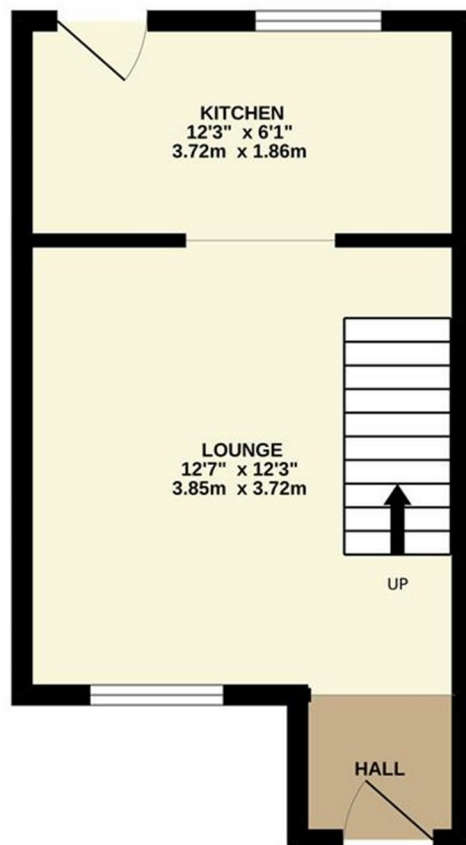

1ST FLOOR
236 sq.ft. (21.9 sq.m.) approx.

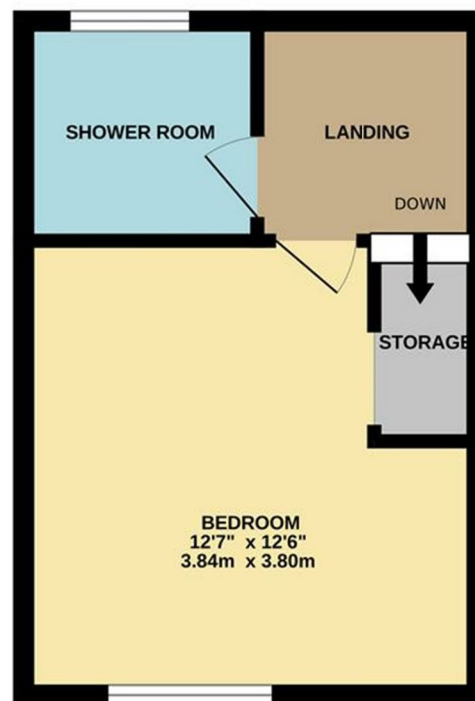

TOTAL FLOOR AREA : 482 sq.ft. (44.8 sq.m.) approx.

Whilst every attempt has been made to ensure the accuracy of the floorplan contained here, measurements of doors, windows, rooms and any other items are approximate and no responsibility is taken for any error, omission or mis-statement. This plan is for illustrative purposes only and should be used as such by any prospective purchaser. The services, systems and appliances shown have not been tested and no guarantee as to their operability or efficiency can be given.

Made with Metropix ©2025



DAVIDSON ESTATES
sales & lettings

CONTACT US

Whichever way suits you...

07557 025044 | 07713 870543

hello@davidsonsestates.com

01202 287606

www.davidsonsestates.com

