



7 Oakmead, Witney





## 7 Oakmead

A neatly presented four-bedroom townhouse offering versatile accommodation across three floors.

Council Tax band: D

Tenure: Freehold

- A neatly presented four-bedroom townhouse located on the popular Madley Park development.
- Extremely versatile accommodation arranged across three floors.
- Garage and off-street parking.
- Spacious living room with double aspect windows and feature fireplace.
- Beautifully landscaped garden with pergola and mature trees and shrubs.
- Master bedroom with ensuite.







Approximate Gross Internal Area (Excluding Void)

Ground Floor = 36.0 sq m / 387 sq ft

First Floor = 34.0 sq m / 366 sq ft

Second Floor = 32.1 sq m / 345 sq ft

Garage = 12.9 sq m / 139 sq ft

Total = 115.0 sq m / 1,237 sq ft

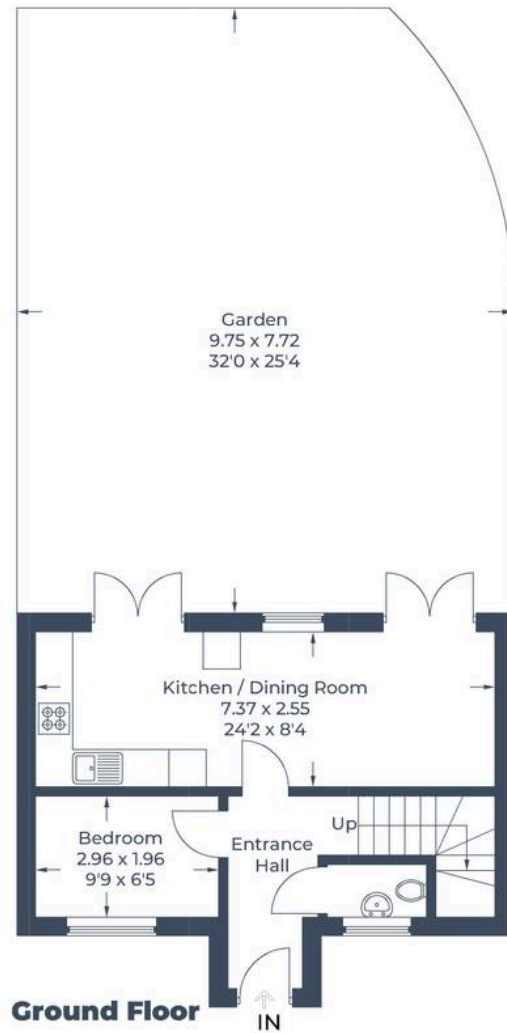





## Simpsons Witney Branch

4 Langdale Court Witney, Oxfordshire - OX28 6AD

01993 835030 • [witney@simpsonsproperty.com](mailto:witney@simpsonsproperty.com) • [www.simpsonsproperty.com/](http://www.simpsonsproperty.com/)