

ATHERTONS

ESTATE & LETTING AGENTS

EST. 1985



Flat 3, Castle Hill Court, 72 Bournemouth Road

Poole

Guide Price **£280,000**

ATHERTONS
ESTATE & LETTING AGENTS

EST. 1985



Flat 3

Castle Hill Court, Poole

WONDERFUL SPACIOUS APARTMENT - A delightful first-floor apartment, just moments from the vibrant Ashley Cross area. The generous living space features a lounge/dining room that opens onto a sunny south-facing balcony, providing lovely views of the rear gardens. Both stairs and a lift offer access to all levels. The property includes two spacious double bedrooms, a bathroom, and a separate WC. Additional benefits include electric heating, double-glazed windows, a carport, and a large, secure storage room

Council Tax band: B

Tenure: Share of Freehold

EPC Energy Efficiency Rating: C

EPC Environmental Impact Rating: D

- Wonderful Apartment
- Two Double Bedrooms
- Spacious Living Room
- Share Of Freehold
- Car Port & Outside Storage
- Lovely Gardens



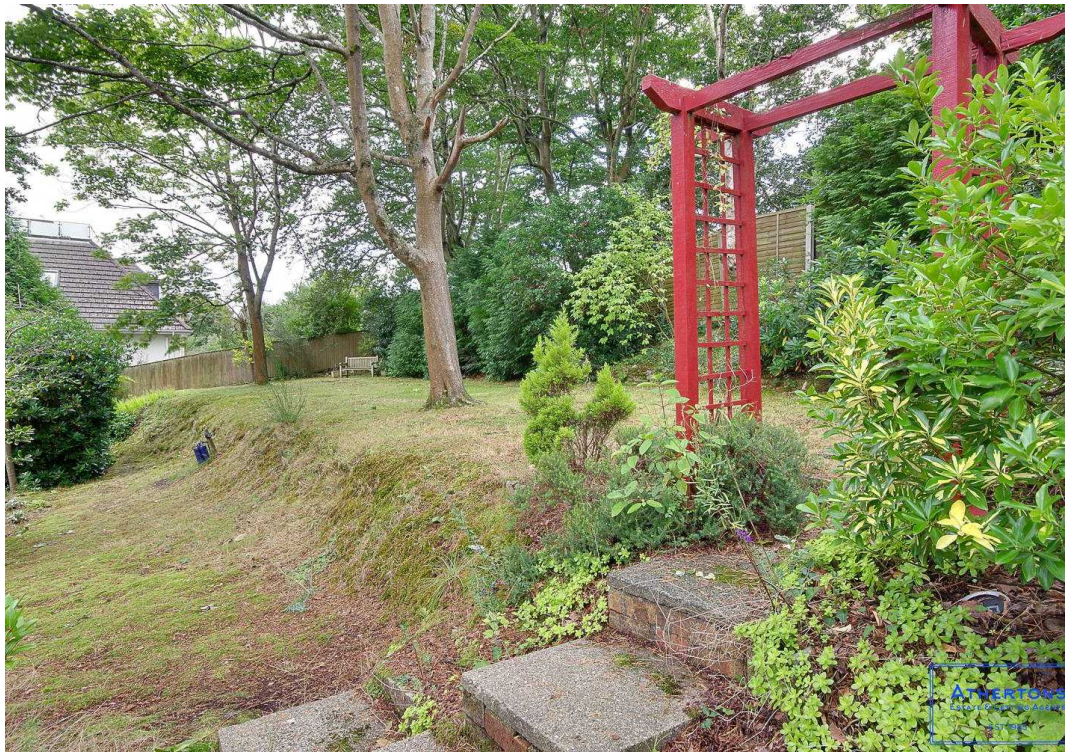

FIRST FLOOR
814 sq.ft. (75.6 sq.m.) approx.

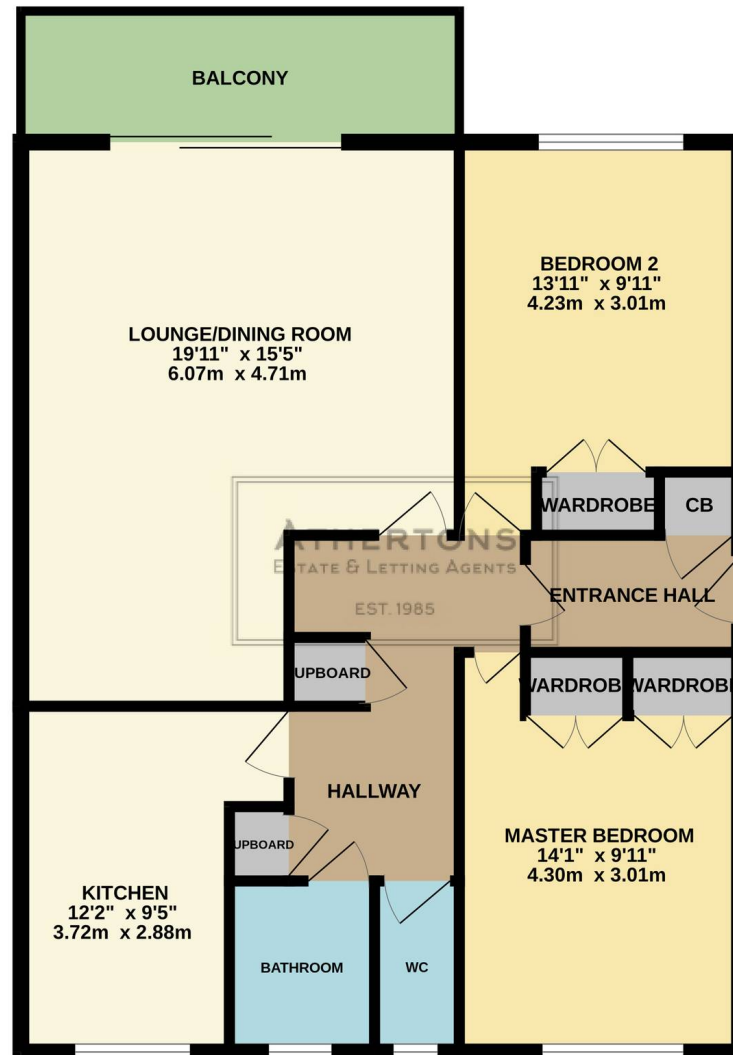

TOTAL FLOOR AREA : 814 sq.ft. (75.6 sq.m.) approx.

Whilst every attempt has been made to ensure the accuracy of the floorplan contained here, measurements of doors, windows, rooms and any other items are approximate and no responsibility is taken for any error, omission or mis-statement. This plan is for illustrative purposes only and should be used as such by any prospective purchaser. The services, systems and appliances shown have not been tested and no guarantee as to their operability or efficiency can be given.
Made with Metropix ©2024



ATHERTONS

Athertons Estate Agents

14 Dorchester Road, Oakdale - BH15 3JY

01202 681113 • poole@athertonsea.com • <http://www.athertonsestateagents.co.uk>

