

ATHERTONS
ESTATE & LETTING AGENTS

EST. 1985

76 Palmer Road, Poole

Poole

Guide Price **£360,000**



76 Palmer Road

Poole, Poole

SOLD BY ATHERTONS - SIMILAR PROPERTIES

REQUIRED An exquisite detached family residence nestled in the heart of Oakdale. This immaculately maintained property features an inviting entrance hallway, a generously sized kitchen/breakfast room, a delightful lounge, a master bedroom boasting abundant built-in wardrobes, an additional double bedroom, and a contemporary bathroom with a shower over the bath. The exterior boasts a meticulously kept South-East facing rear garden with side access and a driveway. Furthermore, the property boasts double glazing, central heating, and a spacious loft area with potential for expansion. Viewing this exceptional property is highly encouraged.

Council Tax band: C

Tenure: Freehold

EPC Energy Efficiency Rating: D

EPC Environmental Impact Rating: D

- Beautiful Family Home
- Modern Kitchen & Bathroom
- Two Double Bedrooms
- Popular Location
- Wonderful Rear Garden
- Driveway



GROUND FLOOR
619 sq.ft. (57.5 sq.m.) approx.

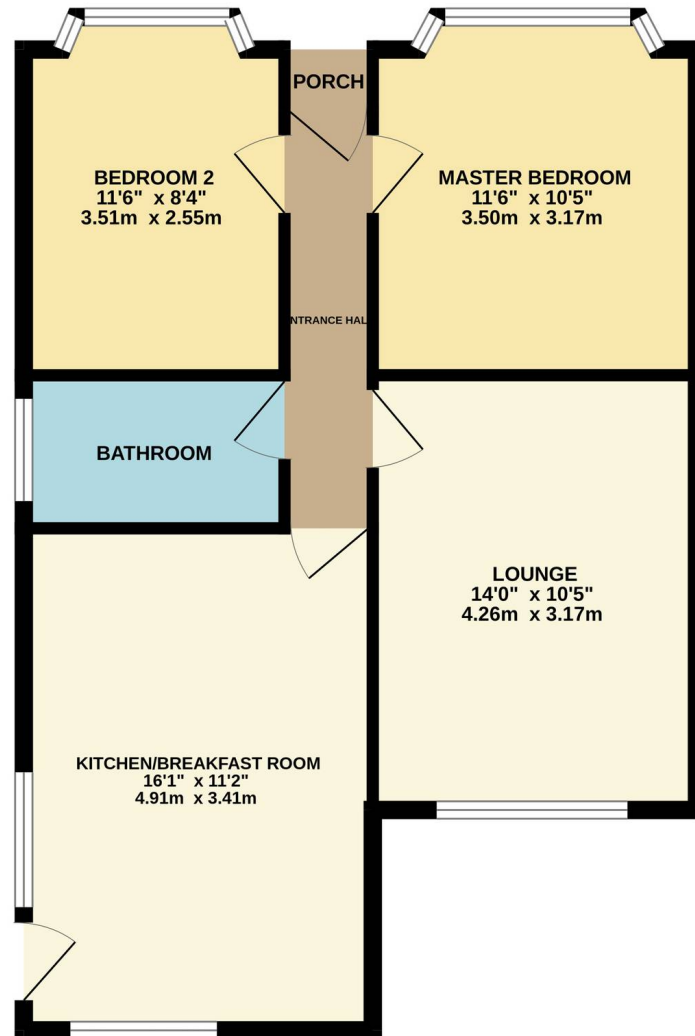

TOTAL FLOOR AREA : 619 sq.ft. (57.5 sq.m.) approx.

Whilst every attempt has been made to ensure the accuracy of the floorplan contained here, measurements of doors, windows, rooms and any other items are approximate and no responsibility is taken for any error, omission or mis-statement. This plan is for illustrative purposes only and should be used as such by any prospective purchaser. The services, systems and appliances shown have not been tested and no guarantee as to their operability or efficiency can be given.
Made with Metropix ©2024



Athertons Estate Agents

14 Dorchester Road, Oakdale - BH15 3JY

01202 681113 • poole@athertonsea.com • <http://www.athertonsestateagents.co.uk>

