

A row of red brick houses with bay windows and a garden. The houses are made of red brick with white window frames and bay windows. The garden is green and has a wooden fence. The sky is blue with white clouds.

*Symonds
Taylor*

30 The Drive, Gosforth

Newcastle Upon Tyne

Guide Price **£775,000**





30 The Drive

Gosforth, Newcastle Upon Tyne

This impressive three storey, period townhouse, is located in the heart of central Gosforth. This family home offers great versatility, generous room sizes, many original features and will suit a wide range of regional and national buyers, with a south facing garden, rear courtyard and an internal viewing will be essential.

Accommodation comprises:

Ground Floor: Entrance Vestibule, Hallway, Sitting Room, Family Room, Dining Kitchen, Utility Room, Cloakroom/WC.

First Floor: Landing, Principal Bedroom, Bedroom 2, Bedroom 3, Shower Room.

Second Floor: Landing, Bedroom 4, Bedroom 5, Bedroom 6/Home Office, Family Bathroom.

Outside: Front South Facing Lawn Garden, Paved Patio, Rear Courtyard.

EPC: D

Council Tax Band: F

Tenure: Freehold



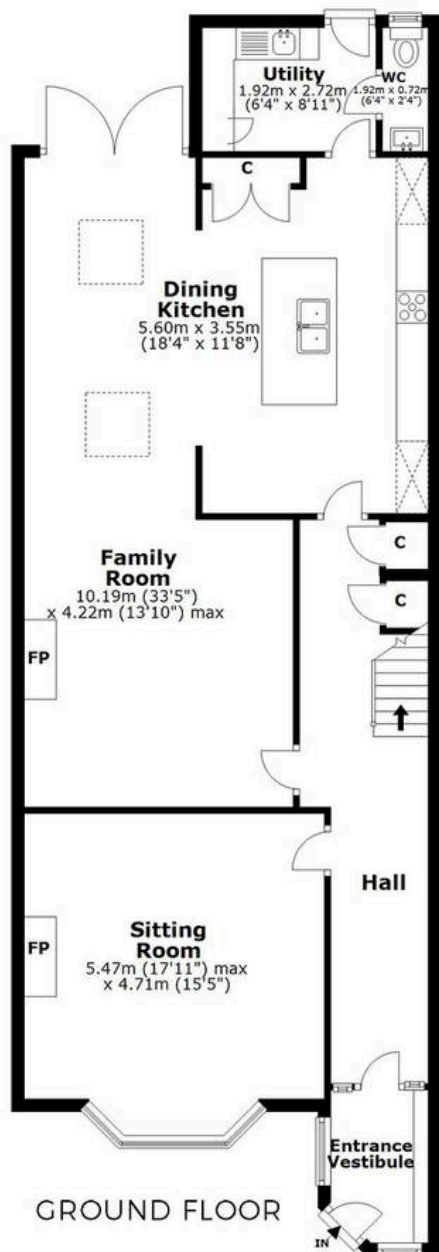

30 THE DRIVE, GOSFORTH, NE3 4AH
NOT TO SCALE - FOR ILLUSTRATIVE PURPOSES ONLY
APPROXIMATE GROSS INTERNAL AREA 2743 SQ FT / 255 SQ M
All measurements and fixtures including doors and windows
are approximate and should be independently verified.
Copyright © BASH 2024
www.wearebash.co.uk







Symonds Taylor

101 St. Georges Terrace, Jesmond – NE2 2DN

0191 338 9999 • hello@symondstaylor.co.uk • www.symondstaylor.co.uk

All descriptions, plans or references to condition are given in good faith only. Whilst every endeavour is made to ensure accuracy, please check with us on any points of especial importance to you.