

*Symonds  
Taylor*

**12 Dunsdale Road, Holywell**

Whitley Bay

Guide Price **£235,000**



## 12 Dunsdale Road

Holywell, Whitley Bay

This semi-detached family home is located in the popular village of Holywell close to Whitley Bay and Northumberland's beautiful coastline. With a south facing garden, ample parking and garage it will suit a wide range of families and an internal inspection is essential.

**Ground Floor:** Entrance Porch, Hallway, Sitting Room/Dining Room, Breakfasting Kitchen.

**First Floor:** Landing, Bedroom 1, Bedroom 2, Bedroom 3, Family Bathroom.

**Outside:** Front Town Garden, Driveway, Ample Off-Street Parking, Integral Garage, Rear South Facing Lawn garden.

12 Dunsdale Road is a semi-detached family home with accommodation spread over two floors and heated by gas central heating, with double glazing installed. This property will suit a wide range of buyers from couples to families. Accessing the property is via the front door, which leads directly into the entrance porch and from there the hallway, where there are stairs off to the first floor. The breakfasting kitchen is towards the front of the property and provides the heart of this family home. It has a modern fitted kitchen with wall and base cabinets and breakfast bar, complementary work surfaces and integral appliances. From here there is doored access out through to the garage and also leading through to the open plan sitting room/dining room, which runs the full width of the back of the house, which has sliding doors leading out to the south facing garden. On the



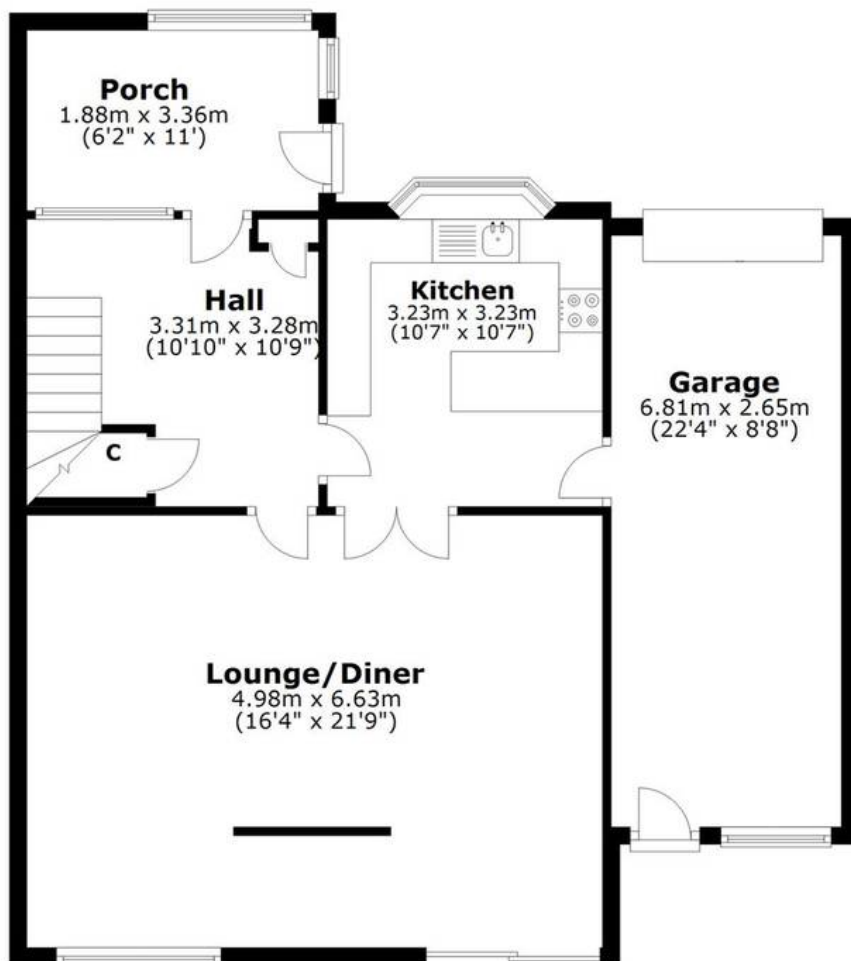

GROUND FLOOR



FIRST FLOOR

12 DUNSDALE ROAD, HOLYWELL, WHITLEY BAY, NE25 0NG

NOT TO SCALE - FOR ILLUSTRATIVE PURPOSES ONLY

APPROXIMATE GROSS INTERNAL AREA 1151 SQ FT / 107 SQ M

All measurements and fixtures including doors and windows  
are approximate and should be independently verified.

Copyright © BASH

[www.wearebash.co.uk](http://www.wearebash.co.uk)

*Symonds  
Taylor*



## **Symonds Taylor**

101 St. Georges Terrace, Jesmond - NE2 2DN

0191 338 9999 • [hello@symondstaylor.co.uk](mailto:hello@symondstaylor.co.uk) • [www.symondstaylor.co.uk](http://www.symondstaylor.co.uk)

All descriptions, plans or references to condition are given in good faith only. Whilst every endeavour is made to ensure accuracy, please check with us on any points of especial importance to you.