



2 Floors



3 Bedrooms



1 En suite

LAWRENCE THREE BEDROOM HOME

A three bedroom detached home with a substantial lounge and an impressive open plan kitchen / dining area with French doors leading to the rear garden. Upstairs boasts three generous bedrooms with the master benefitting from an en suite shower room.

LAWRENCE

THREE BEDROOM HOME

✦ DIMENSIONS

First Floor:

Bedroom 1

3.21m x 3.50m
10'6" x 11'6"

En Suite

Bedroom 2

3.28m x 2.45m
10'10" x 8'0"

Bedroom 3

3.33m x 2.43m
10'11" x 7'11"

Bathroom

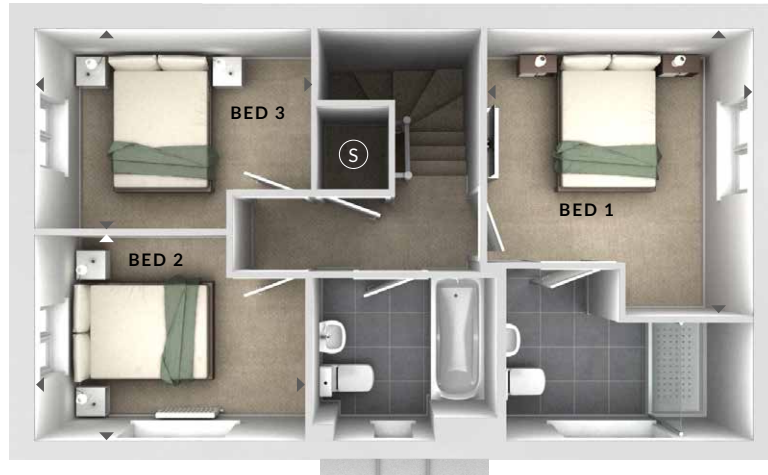

First Floor

Ground Floor:

Lounge

3.26m x 4.95m
10'8" x 16'3"

Kitchen/Dining

3.21m x 4.95m
10'6" x 16'3"

(S) Storage

(C) Cloaks

◀ ▶ Measurement Points

△ External Access

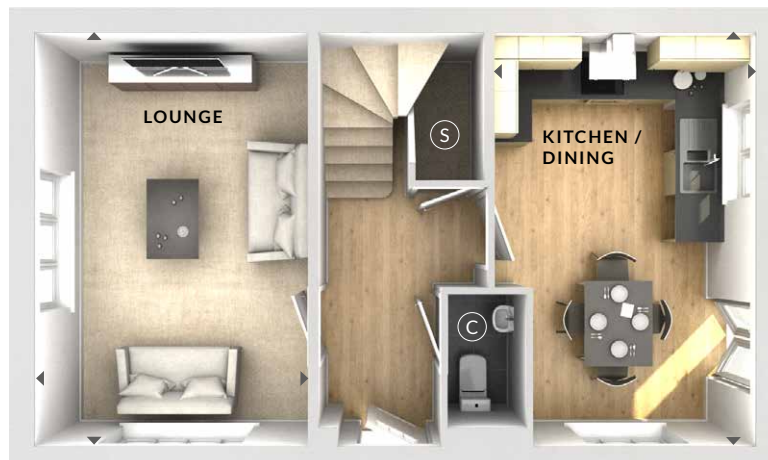

Ground Floor