

Hilleys Croft,



Contact us for more information 0121 750 0390



Directions



KLARICO Estate Agents proudly present this 3-bedroom mid-terrace property situated within Birmingham. This property offers a spacious living room alongside a kitchen/diner. This property would be ideal for First Time Buyers alongside Investors.

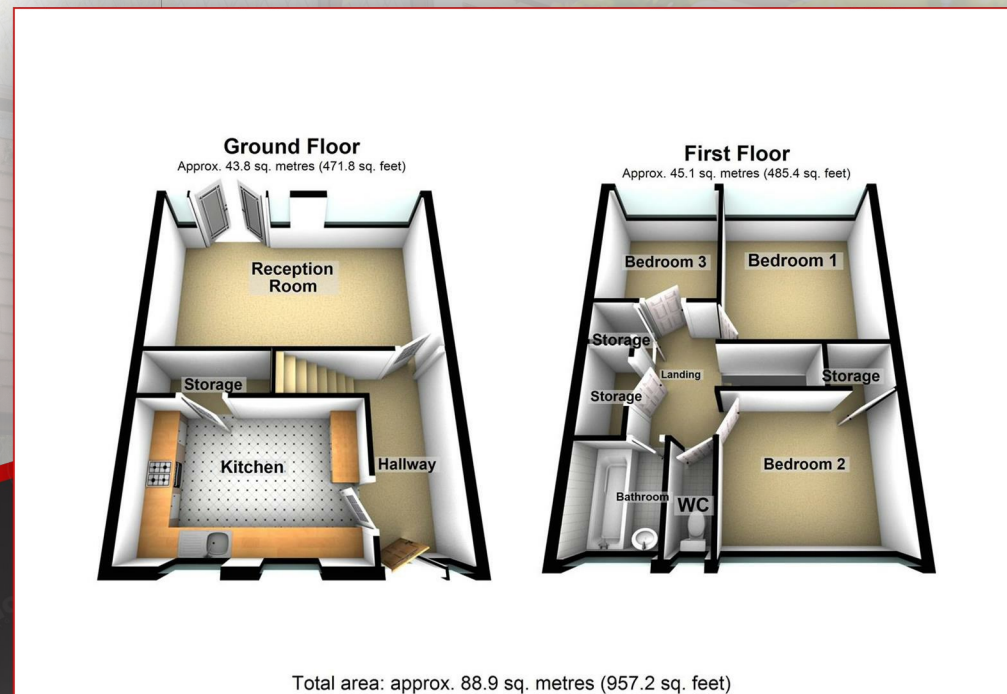

Hallway

3.77m x 1.52m (12'4" x 5'0")

Kitchen

2.82m x 4.20m (9'3" x 13'9")

Reception Room

3.68m x 5.79m (12'1" x 19'0")

Bedroom 1

3.80m x 3.37m (12'6" x 11'1")

Bedroom 2

2.84m x 3.41m (9'4" x 11'2")

Bedroom 3

2.93m x 2.35m (9'7" x 7'9")

Bathroom

1.90m x 1.50m (6'3" x 4'11")

WC

1.90m x 0.75m (6'3" x 2'6")

Garden