

Arden Oak Road, Sheldon



Contact us for more information 0121 750 0390



Directions



KLARICO estate agents proudly present this stunning 3-bedroom semi-detached property located within a prominent part of Birmingham. Benefits from having an impressive rear garden and provides off road parking for multiple vehicles as well as lockable garage. Book you're viewing now to avoid disappointment!

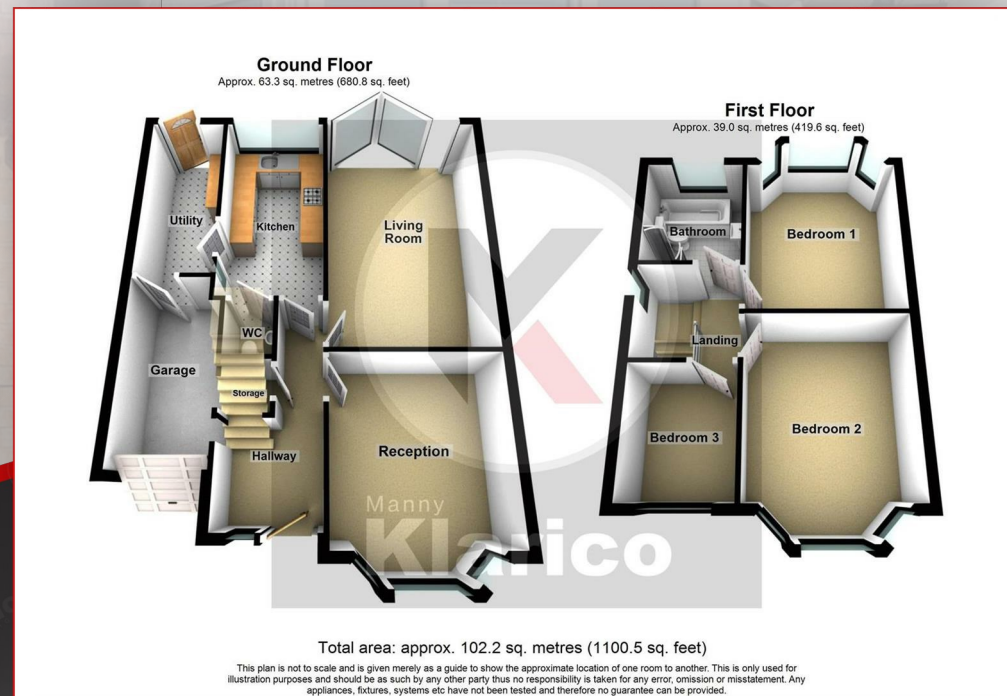

Reception

3.49m x 3.32m (11'5" x 10'11")

Living Room

5.39m x 3.32m (17'8" x 10'11")

Kitchen

4.31m x 2.17m (14'2" x 7'1")

Utility

3.80m x 1.60m (12'6" x 5'3")

WC

.92 x 1.16 (.30'10" x 3'9")

Garage

3.74 x 2.09 (12'3" x 6'10")

Bedroom 1

3.44m x 3.20m (11'3" x 10'6")

Bedroom 2

3.50m x 3.21m (11'6" x 10'6")

Bedroom 3

2.50m x 1.89m (8'2" x 6'2")

Bathroom

2.48m x 2.25m (8'2" x 7'5")