

Geraldine Road,



Contact us for more information 0121 750 0390

Geraldine Road,



Directions



KLARICO Estate Agents proudly present this 3-bedroom mid terrace property situated within Birmingham. This property offers 2 spacious living rooms alongside a kitchen/diner. This property would be ideal for First Time Buyers alongside Investors.

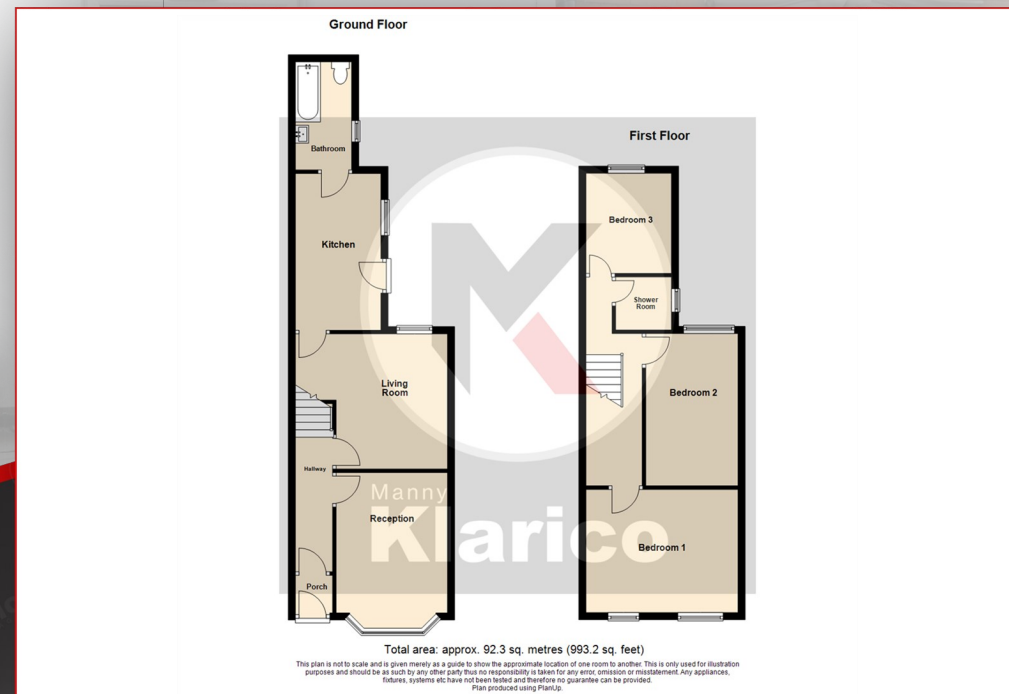

Reception

3.92m x 3.11m (12'10" x 10'2")

Living Room

3.78m x 3.11m (12'5" x 10'2")

Kitchen

4.38m x 2.39m (14'4" x 7'10")

Bathroom

3.02m x 1.57m (9'11" x 5'2")

Bedroom 1

3.44m x 4.25m (11'3" x 13'11")

Bedroom 2

4.26m x 2.38m (14'0" x 7'10")

Bedroom 3

2.80m x 2.39m (9'2" x 7'10")

Shower Room

Garden

www.mannyklarico.co.uk

332 Hob Moats Road, Birmingham, B92 8JT