



A pleasant one bedroom RETIREMENT apartment situated on the second floor with a southerly aspect. The property benefits from a bright living room with a feature fireplace and an archway leading to the kitchen which has fitted units with a built in cooker, hob and cooker hood. The bedroom has fitted mirrored fronted wardrobes and the bathroom has a cream coloured suite and a large shower enclosure.

Shannock Court comprises 52 properties arranged over 3 floors and is situated close to the High Street with a variety of shops and

£955.00_{pcm}

Council Tax Band: B

Local Authority: North Norfolk

Shannock Court, Sheringham NR26 8DW

www.myfutureliving.co.uk | 01823 793420 | lettings@myfutureliving.co.uk





- ***Minimum age 60, joint applicant can be 55***
- Security of a long term rental contract
- 24 hour Emergency Call system
- On-site Manager
- Maintained and landscaped gardens
- Communal lounge for socialising and relaxing
- Pet friendly



47 Shannock Court George Street, Sheringham NR26 8DW

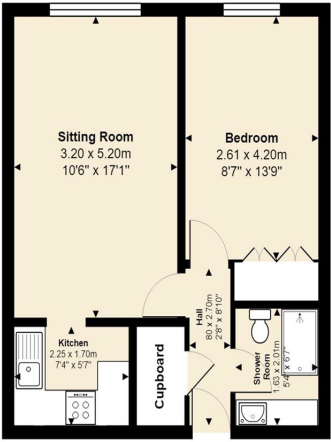

Total Area: 42.1 m² ... 454 ft²

All measurements are approximate and for display purposes only



Energy Efficiency Rating		
	Current	Potential
Very energy efficient - lower running costs		
92-100 A		
81-91 B		
69-80 C	75	81
55-68 D		