

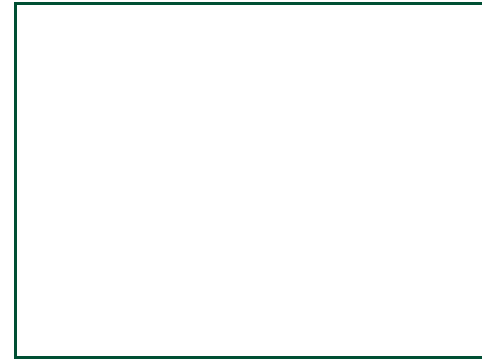

Park Drive
Kings Heath, Northampton

oriordanbond
SALES & LETTINGS



GROUND FLOOR
419 sq.ft. (38.9 sq.m.) approx.

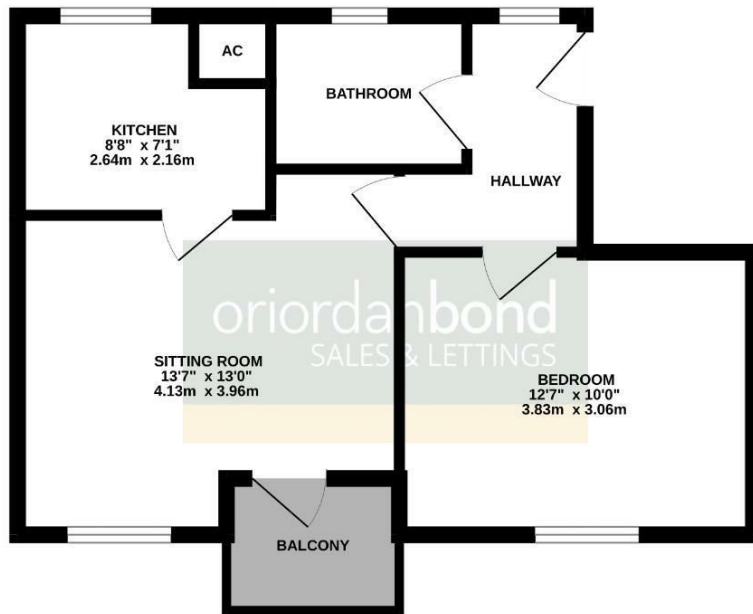

TOTAL FLOOR AREA: 419 sq.ft. (38.9 sq.m.) approx.
While every attempt has been made to ensure the accuracy of the description contained here, measurements of doors, windows, rooms and any other items are approximate and no responsibility is taken for any error, omission or mis-statement. This plan is for illustrative purposes only and should be used as such by any prospective purchaser. The services, systems and appliances shown have not been tested and no guarantee as to their operability or efficiency can be given.
Made with Metragen CS204

Park Drive

Kings Heath
NN5 7JU

OFFERS OVER £105,000

Offered to the market with no onward chain is this one bedroom first floor apartment. Located on the outskirts of Kings Heath, set within close proximity of local parks and shops, the property would make an ideal purchase for first time buyers and investors.

The accommodation comprises entrance hall, sitting room, kitchen, one double bedroom and a bathroom. Benefits include gas radiator heating, uPVC double glazing, a secure intercom entry system and a balcony to the rear. (C/419/balc)

Leasehold Information: Lease Remaining - 114 years (as of 2024) /
Ground Rent - £100 per annum / Service Charge - £500 per annum

Additional information

- Council Tax Band: A
- Energy Efficiency Rating: C

Viewing

Viewing strictly by appointment – details below

Disclaimer

O’Riordan Bond Estate Agents Limited has not tested apparatus, equipment, fittings or services and so cannot verify they are in working order. The buyer is advised to obtain verification from their solicitor or surveyor.

O’Riordan Bond Duston North Sales
01604 589007

dustonnorth@oriordanbond.co.uk

