

THE PRIVATE OFFICE  
REAL ESTATE

# PINE HOUSE

EATON PARK ESTATE



Measuring just under 10,000 Sq Ft with an exceptional garden and well planned accommodation, this exceptional family home is situated in one of the areas most sought after and prestigious gated private estates, making Pine House a superb opportunity for anyone looking to buy a home of great quality in a first class location.

  
FOUNDER AND CEO



THE PRIVATE OFFICE  
REAL ESTATE



THE PRIVATE OFFICE  
REAL ESTATE





THE PRIVATE OFFICE  
REAL ESTATE



THE PRIVATE OFFICE  
REAL ESTATE





# THE PRIVATE OFFICE REAL ESTATE



THE PRIVATE OFFICE  
REAL ESTATE



# THE PRIVATE OFFICE REAL ESTATE

**Pine House,  
Fairmile Avenue**  
Gross internal area (approx.)  
Total = 909 sq.m (9785 sq.ft)  
Main House = 799 sq.m (8599 sq.ft)  
(Including Restricted Head Height Area)  
Outbuildings = 110 sq.m (1186 sq.ft)  
For Identification Only. Not To Scale.  
© www.skyshotglobal.com

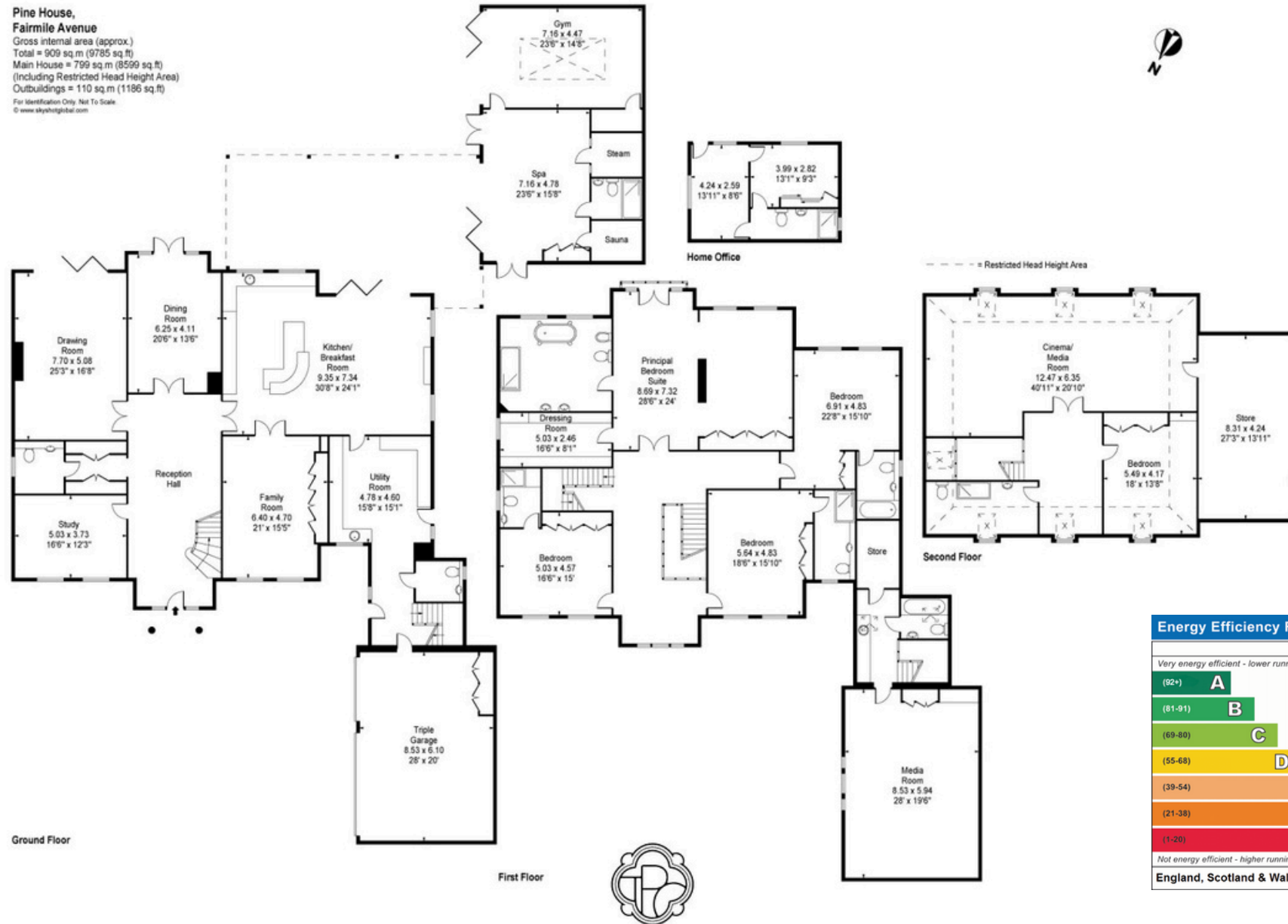

Energy Efficiency Rating		
	Current	Potential
Very energy efficient - lower running costs		
(92+)	A	
(81-91)	B	87 89
(69-80)	C	
(55-68)	D	
(39-54)	E	
(21-38)	F	
(1-20)	G	
Not energy efficient - higher running costs		
England, Scotland & Wales		EU Directive 2002/91/EC



Important Notice: This plan is not to scale (unless specified), is for guidance only and must not be relied upon as a statement of fact. All measurements and areas are approximate only (and have been prepared in accordance with the current edition of the RICS Code of Measuring Practice). Please read the Important Notice on the last page of text of the particulars.



Pine House, 2 Fairmile Avenue, Eaton Park Estate, Cobham, Surrey, KT11 2JB

£5,950,000 | GYM, CINEMA ROOM, SAUNA AND SALT SPA



**Trevor Kearney**  
**Founder and CEO**

tk@theprivateofficere.com

+44 (0)7301 289 026

+44 (0) 203 916 6800

@superprimesurrey

# THE PRIVATE OFFICE REAL ESTATE



**FIXTURES AND FITTINGS** All fixtures, fittings and furnishings i.e. curtains, light fittings and garden statuary etc. are expressly excluded from the sale, but some items may be made available by separate negotiations.

**TENURE** Freehold

**VIEWINGS** Strictly by appointment with the sole marketing agents The Private Office: Real Estate

**IMPORTANT NOTICE** The Private Office: Real Estate, their clients and any joint agents give notice that:

1. They are not authorised to make or give any representations or warranties in relation to the property either here or elsewhere, either on their own behalf or on behalf of their client or otherwise. They assume no responsibility for any statement that may be made in these particulars. These particulars do not form part of any offer or contract and must not be relied upon as statements or representations of fact.
2. Any areas, measurements or distances are approximate. The text, photographs and plans are for guidance only and are not necessarily comprehensive. It should not be assumed that the property has all necessary planning, building regulation or other consents and The Private Office: Real Estate have not tested any services, equipment or facilities. Purchasers must satisfy themselves by inspection or otherwise.

Details prepared: September 2024 Photographs: Taken August 2022

**OFFICE ADDRESS**

The Boathouse, Millbrook  
Guildford, GU1 3XJ

**THE PRIVATE OFFICE : REAL ESTATE LIMITED**

Registered in England & Wales No. 14988093

hello@thepriateofficere.com  
thepriateofficere.com

**REGISTERED ADDRESS**

1 Park Road  
Hampton Wick, KT1 4AS