

Elder Brook Park, Neasham Road, Darlington, DL2 1DL.
£189,995



Elder Brook Park, Neasham Road, Darlington, DL2 1DL.

£189,995

Council Tax Band:

The Ripon is a beautiful semi-detached home that's perfect for first-time buyers and families. This 3-bedroom property comes with 2 parking spaces. Downstairs, there is a front aspect kitchen–dining area to enjoy, as well as a spacious lounge with French doors leading to the rear garden. There is also a downstairs cloakroom and storage.

On the first floor, you can enjoy a generous principal bedroom with fitted wardrobes and an en-suite. There are also two further bedrooms and a family bathroom.

There is an estate management charge of approx.
£110+VAT pa (23/24)

Rear garden

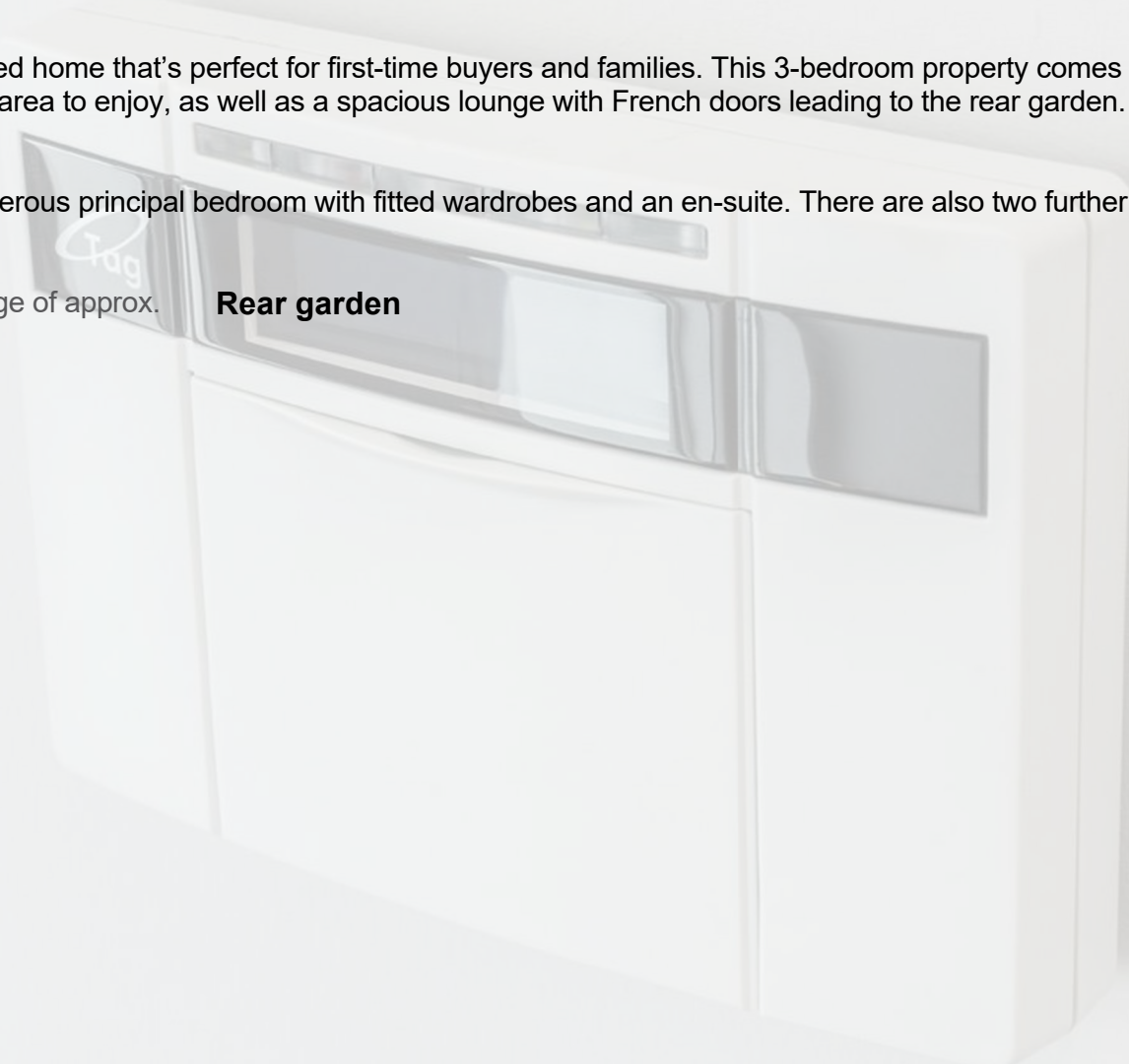

Principal elevation

Entrance Hallway

Kitchen/dining area
12'1" x 8'2" (3.70 x 2.50)

Ground floor WC

Lounge
15'7" x 11'4" (4.75 x 3.46)

First floor landing

Principal bedroom
9'10" x 8'10" (3.01 x 2.71)

En-suite
7'0" x 5'4" (2.14 x 1.65)

Second bedroom
9'3" x 8'2" (2.83 x 2.49)

Third bedroom
7'10" x 6'0" (2.39 x 1.83)

Bathroom
6'2" x 6'1" (1.89 x 1.87)

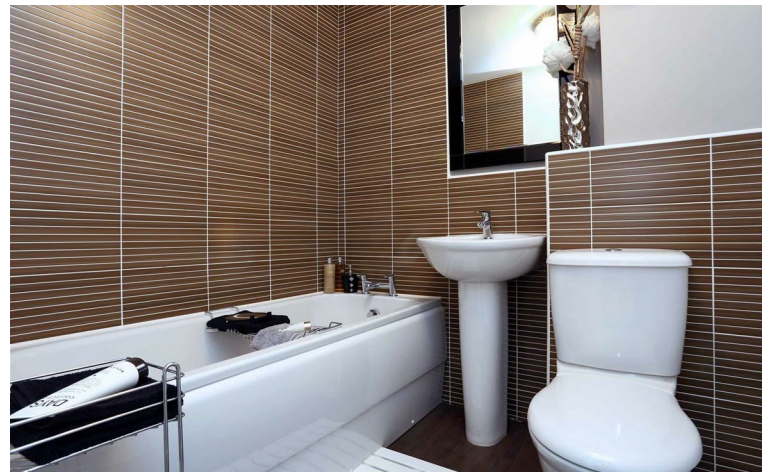



65 Duke Street
 Darlington
 County Durham
 DL3 7SD
 01325 804850
 sales@vurvstates.co.uk
<https://www.vurv.online/>

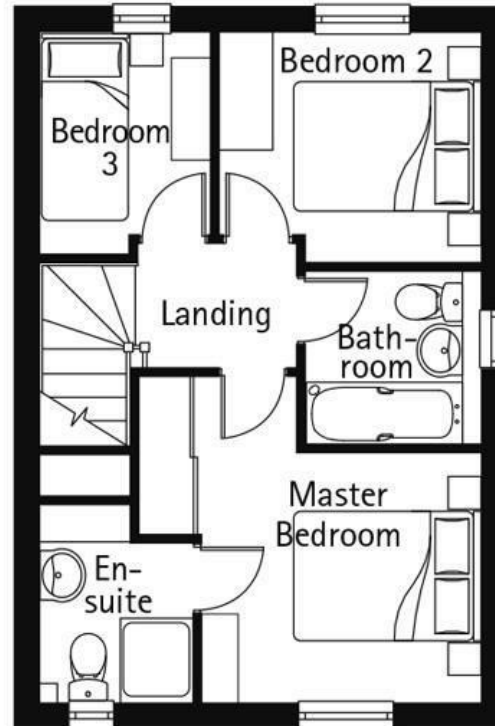
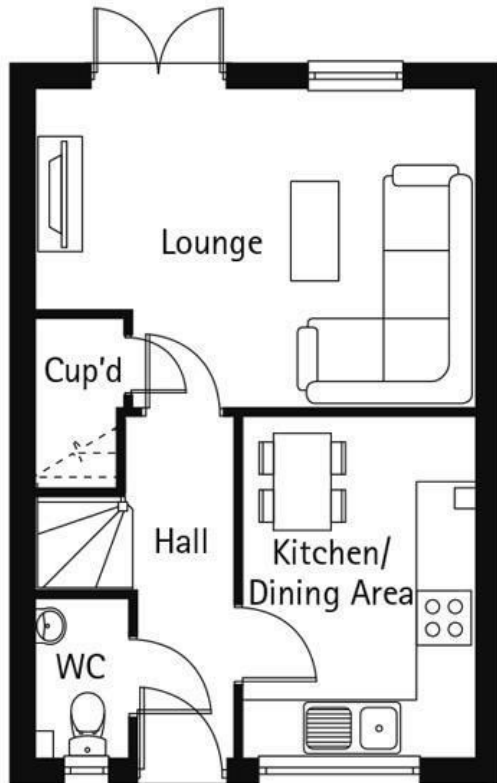

Energy Efficiency Rating		Current	Potential
<i>Very energy efficient - lower running costs</i>			
(92 plus) A			
(81-91) B			
(69-80) C			
(55-68) D			
(39-54) E			
(21-38) F			
(1-20) G			
<i>Not energy efficient - higher running costs</i>			
England & Wales			EU Directive 2002/91/EC