

Hurworth Meadows, Neasham Road, Darlington, DL2 1DL.  
£149,995





Hurworth Meadows, Neasham Road, Darlington, DL2 1DL.

£149,995

Council Tax Band:

**\*\* First time buyer deal - £500 towards deposit and flooring included \*\***

The Daisy is a beautiful 2-bedroom home that's perfect for first-time buyers and small families. It comes complete with parking. Downstairs, there is a front aspect kitchen-dining area to enjoy, as well as a spacious lounge with French doors leading to the rear garden. There is also a downstairs cloakroom.

On the first floor, you can enjoy a generous principal bedroom. There is another bedroom and a family bathroom.

Like all properties at Hurworth Meadows, the Daisy comes complete with premium insulation, solar panels and an electric vehicle charging port.

EPC BAND B

These houses are sold on a FREEHOLD basis.

There is an estate management charge of approx.

£110+VATpa (23/24)

**Principal elevation**

**Entrance hallway**

**Ground floor w/c**

**Kitchen/dining area**

11'5" x 6'9" (3.50 x 2.07)

**Lounge**

13'3" x 10'2" (4.05 x 3.11)

**First floor landing**

**Principal bedroom**

13'3" x 10'3" (4.05 x 3.14)

**Bedroom two**

11'4" x 6'7" (3.47 x 2.01)

**Bathroom/w.c**

6'5" x 5'7" (1.97 x 1.71)

**Rear garden**

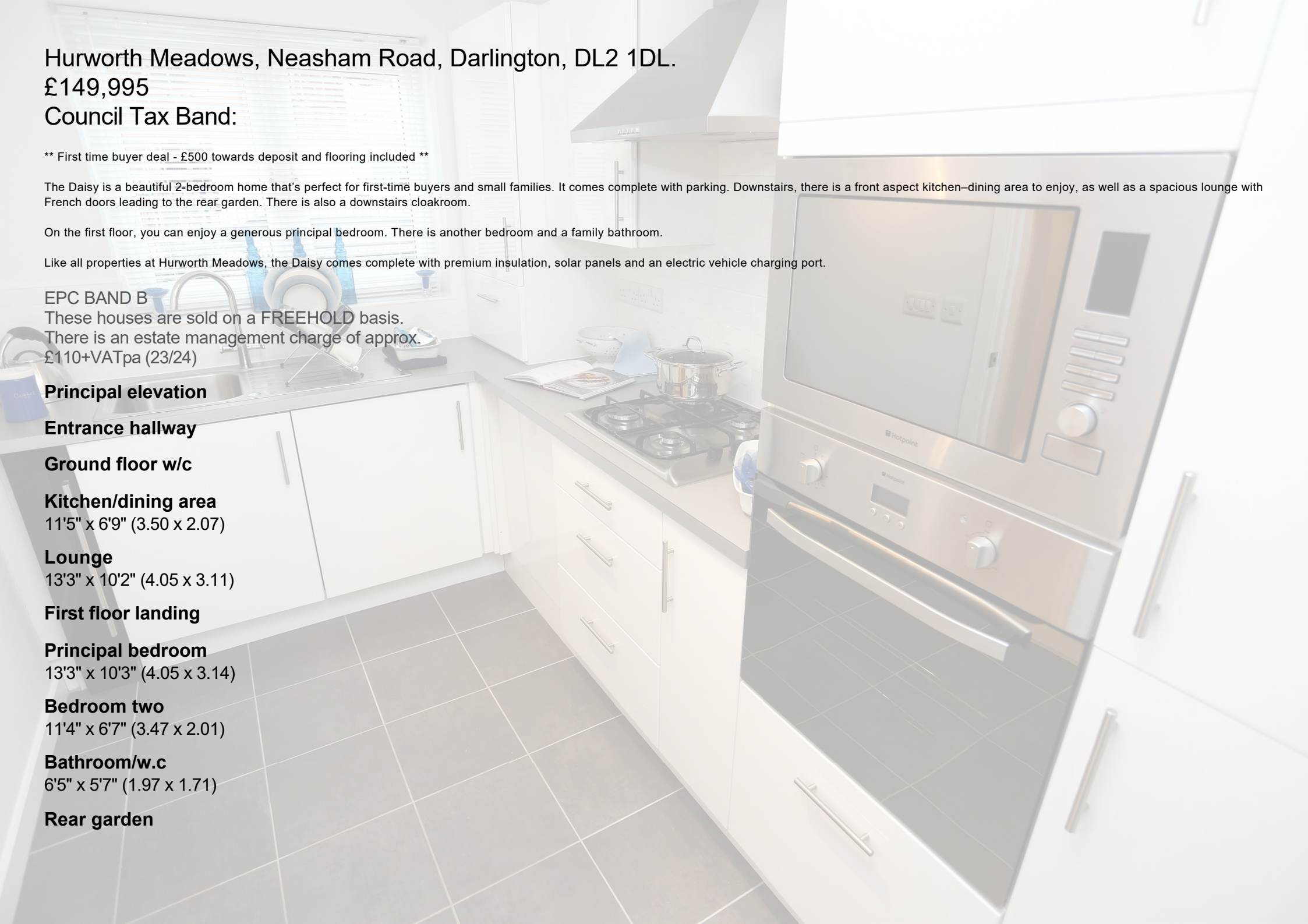







65 Duke Street  
 Darlington  
 County Durham  
 DL3 7SD  
 01325 804850  
 sales@vurvstates.co.uk  
<https://www.vurv.online/>

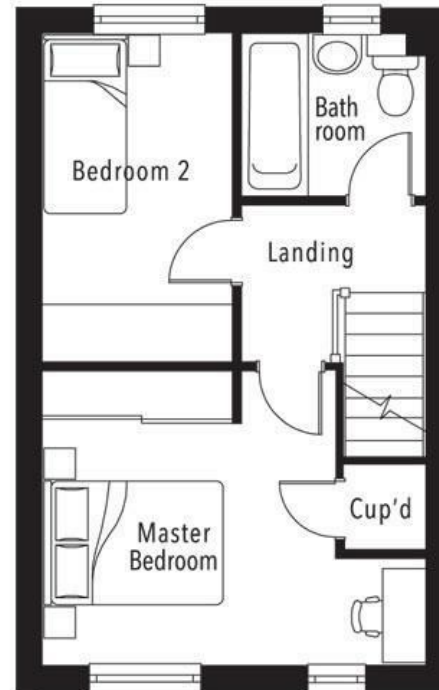
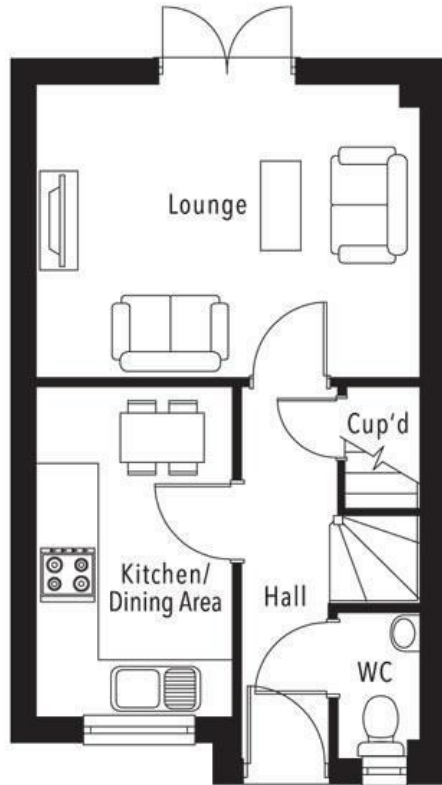

Energy Efficiency Rating		
	Current	Potential
<i>Very energy efficient - lower running costs</i>		
(92 plus) <b>A</b>		
(81-91) <b>B</b>		
(69-80) <b>C</b>		
(55-68) <b>D</b>		
(39-54) <b>E</b>		
(21-38) <b>F</b>		
(1-20) <b>G</b>		
<i>Not energy efficient - higher running costs</i>		
<b>England &amp; Wales</b>	EU Directive 2002/91/EC	