

Hurworth Meadows, Neasham Road, Darlington, DL2 1DL.
£149,995



Hurworth Meadows, Neasham Road, Darlington, DL2 1DL.

£149,995

Council Tax Band:

** First time buyer deal - £5000 towards deposit and Flooring included **

The Daisy is a beautiful 2-bedroom home that's perfect for first-time buyers and small families. It comes complete with parking. Downstairs, there is a front aspect kitchen-dining area to enjoy, as well as a spacious lounge with French doors leading to the rear garden. There is also a downstairs cloakroom.

On the first floor, you can enjoy a generous principal bedroom. There is another bedroom and a family bathroom.

Like all properties at Hurworth Meadows, the Daisy comes complete with premium insulation, solar panels and an electric vehicle charging port.

EPC BAND B

These houses are sold on a FREEHOLD basis.

There is an estate management charge of approx.

£110+VATpa (23/24)

Principal elevation

Entrance hallway

Ground floor w/c

Kitchen/dining area

11'5" x 6'9" (3.50 x 2.07)

Lounge

13'3" x 10'2" (4.05 x 3.11)

First floor landing

Principal bedroom

13'3" x 10'3" (4.05 x 3.14)

Bedroom two

11'4" x 6'7" (3.47 x 2.01)

Bathroom/w.c

6'5" x 5'7" (1.97 x 1.71)

Rear garden

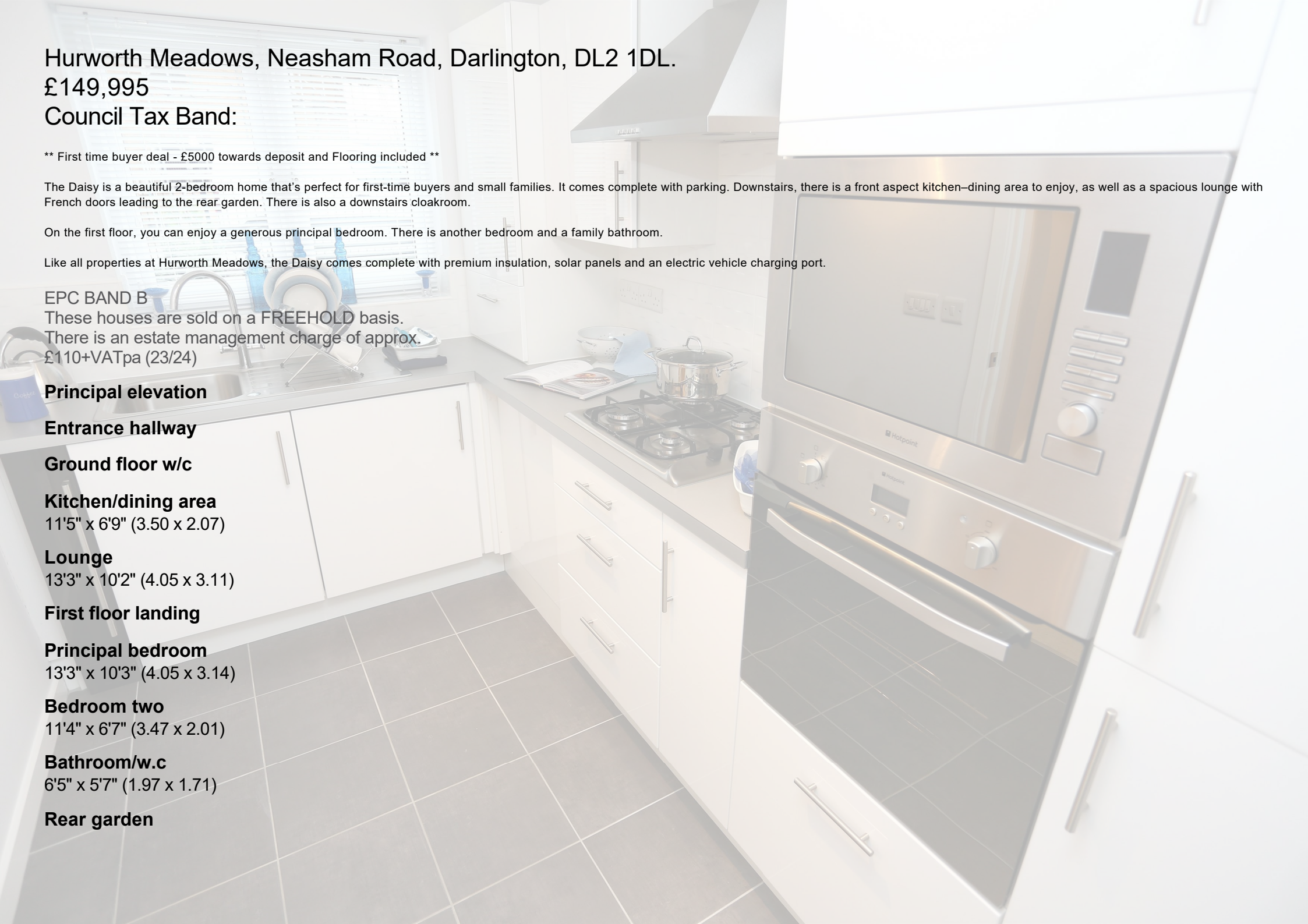





65 Duke Street
 Darlington
 County Durham
 DL3 7SD
 01325 804850
 sales@vurvstates.co.uk
<https://www.vurv.online/>

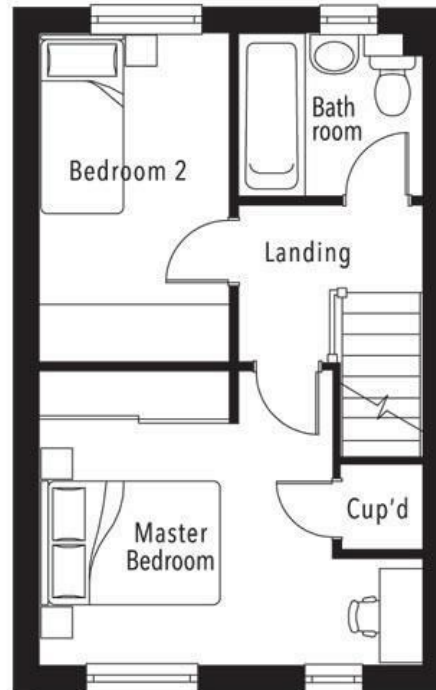
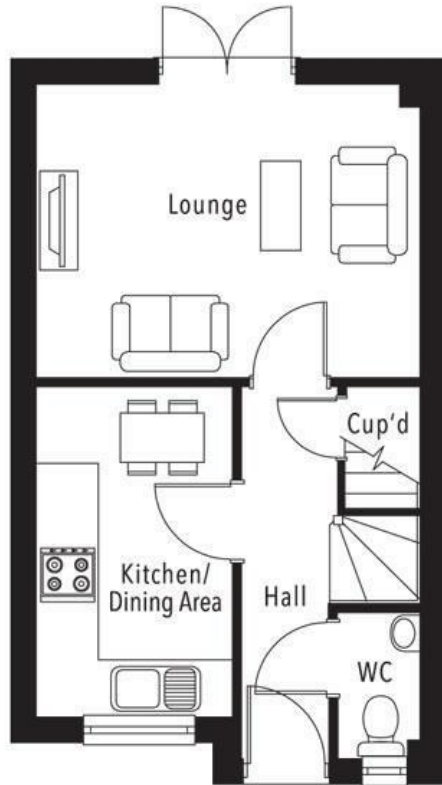

Energy Efficiency Rating		
	Current	Potential
<i>Very energy efficient - lower running costs</i>		
(92 plus) A		
(81-91) B		
(69-80) C		
(55-68) D		
(39-54) E		
(21-38) F		
(1-20) G		
<i>Not energy efficient - higher running costs</i>		
England & Wales	EU Directive 2002/91/EC	