

Directions

Viewings

Viewings by arrangement only. Call 01825 701 030 to make an appointment.

EPC Rating

B

Energy Efficiency Rating		
	Current	Potential
Very energy efficient - lower running costs		
(92 plus) A		96
(81-91) B	83	
(69-80) C		
(55-68) D		
(39-54) E		
(21-38) F		
(1-20) G		
Not energy efficient - higher running costs		
England & Wales		
EU Directive 2002/91/EC		

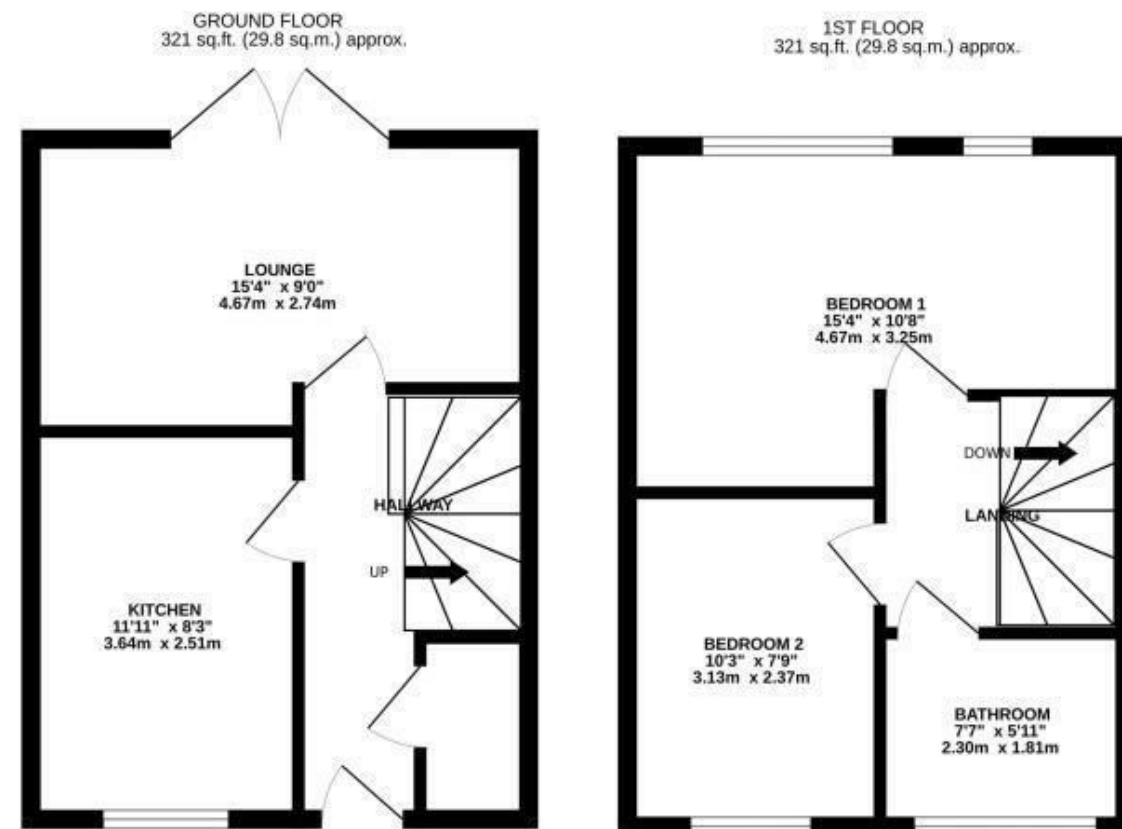

TOTAL FLOOR AREA: 642 sq.ft. (59.7 sq.m.) approx.

Whilst every attempt has been made to ensure the accuracy of the floorplan contained here, measurements of doors, windows, rooms and any other items are approximate and no responsibility is taken for any error, omission or mis-statement. This plan is for illustrative purposes only and should be used as such by any prospective purchaser. The services, systems and appliances shown have not been tested and no guarantee as to their operability or efficiency can be given.

Made with Metropix ©2023



26A Trenches Road, Crowborough, East Sussex, TN6 1ER

£1,400 Per month

- End Terrace House
- Quiet Cul-de-Sac Location
- Modern Kitchen
- Viewing Advised
- Two Bedrooms
- Off-Road Parking Space
- Cloakroom
- Unfurnished

26A Trenches Road, Crowborough TN6 1ER

A lovely two bedroom home set in a small, quiet cul-de-sac being perfectly located for local schools and not far from Crowborough town centre

 2

 1

 1

 B

Council Tax Band: C

The house is well presented throughout having only been constructed in 2018.

The property comprises entrance hall, lounge to the rear with French doors leading onto the garden. There is an attractive kitchen/breakfast room with range of modern units, built in oven and four ring hob. There is also the welcome addition of a cloakroom. The first floor offers two good sized bedrooms and a family bathroom.

There is an off-road parking space adjacent to the house along with ample space on the road for further parking.

Set in a small, quiet cul-de-sac, with no through traffic, apart from residents and visitors. The property is being offered unfurnished and is available from June 2025.

