



Fife Way, Aylesham, Kent
Aylesham

**MATCH
ESTATES**
Guide Price
£40,000



Bedrooms: 1 | Bathrooms: 1 | Receptions: 1

AVAILABLE 25% SHARED OWNERSHIP OR FULL MARKET VALUE £160,000 Situated in a popular and well-connected village, this beautifully presented one-bedroom flat offers contemporary living with excellent access to the A2 – perfect for professionals, first-time buyers, or those seeking a peaceful retreat with commuter convenience.

Step inside to a welcoming entrance hall that leads to a spacious double bedroom and a sleek, modern bathroom. The heart of the home is the bright and airy open-plan living area, seamlessly combining lounge, dining, and kitchen spaces – ideal for both relaxing evenings and entertaining guests.

This modern apartment benefits from allocated parking as well as visitor spaces, a rare advantage that ensures stress-free parking at all times. The grounds are well maintained, offering a sense of privacy and tranquility rarely found in similar properties.

With its stylish finish, functional layout, and prime location, this home ticks all the boxes for contemporary village living.

Built using traditional brick and block construction, the property also promises long-term durability and low maintenance.

Don't miss the opportunity to make this superb flat your own – arrange your viewing today.



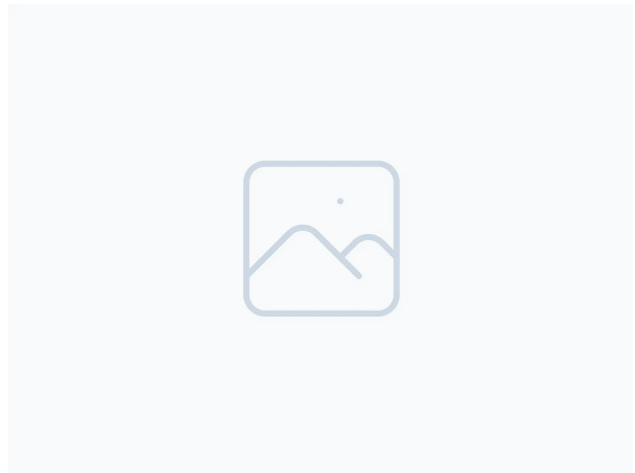

Score	Energy rating	Current	Potential
92+	A		
81-91	B	82 B	82 B
69-80	C		
55-68	D		
39-54	E		
21-38	F		
1-20	G		

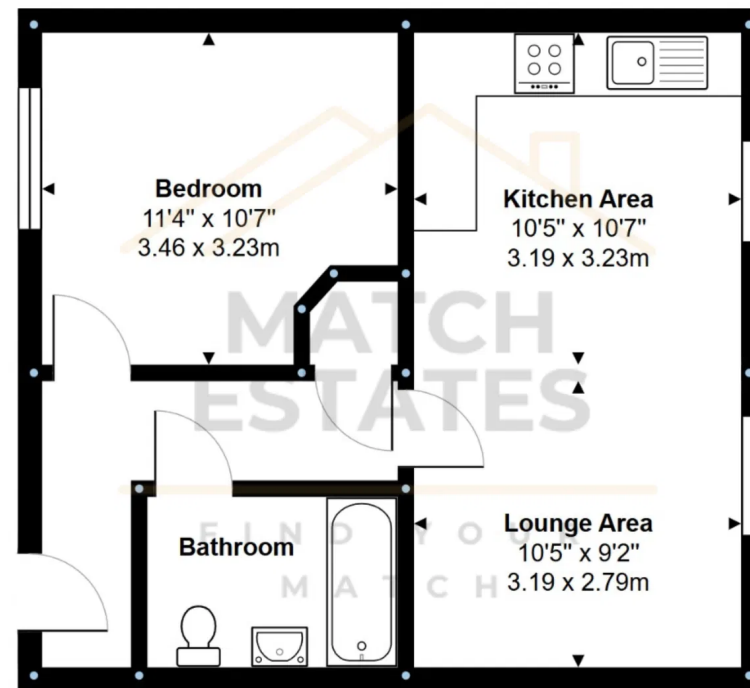

Measurements are approximate and for display purposes only

Match Estates

B3 Bouverie House 16 Bouverie Place Folkestone CT20 1AE

01303 475 085

folkestone@match-estates.co.uk

<https://www.match-estates.co.uk/>