



Effingham House, Effingham Street, Dover
Offers In Region Of £170,000

2 1 2



Nestled in the desirable Effingham Street area of Dover, this beautifully presented two-bedroom split-level maisonette offers an ideal blend of contemporary design and practicality. Situated within a conservation area, the property exudes charm while providing excellent access to the town's key amenities, making it perfect for modern living.

The property features two spacious double bedrooms, ideal for restful retreats, and a versatile loft room that can serve as a guest bedroom, home office, or creative space. The open-plan living room and kitchen are bathed in natural light, thanks to large double-aspect sash windows, creating a warm and inviting atmosphere for relaxation and entertaining. A separate mezzanine area offers a dedicated study space, catering to those who work or study from home. The modern bathroom is thoughtfully designed with high-quality fittings to ensure comfort and convenience.

Practicality is at the forefront with unallocated off-street parking and BRAND NEW efficient gas central heating throughout. Immaculately maintained and ready to move into, this chain-free property ensures a seamless buying process, adding to its appeal for prospective buyers.

Living here offers a lifestyle that balances tranquility with accessibility. The maisonette is located a short walk from Dover Priory train station, providing high-speed connections to London, and the vibrant High Street, where a range of shopping, dining, and entertainment options await. The conservation area setting enhances the charm, while nearby parks and coastal paths offer opportunities for outdoor leisure and exploration.

Effingham House is the perfect choice for professionals, couples, or anyone seeking a stylish, low-maintenance home in a convenient yet peaceful location.



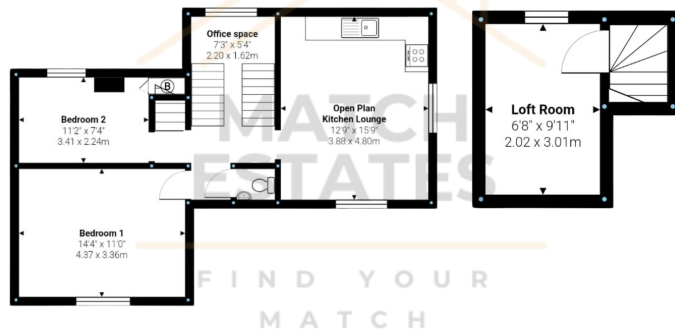

Measurements are approximate and for display purposes only

- CHAIN FREE
- Split Level
- Fantastically Refurbished
- Two Double Bedrooms
- Versatile Loft Room
- Mezzanine Situated Of The Lounge
- Modern Bathroom
- Off Road Parking

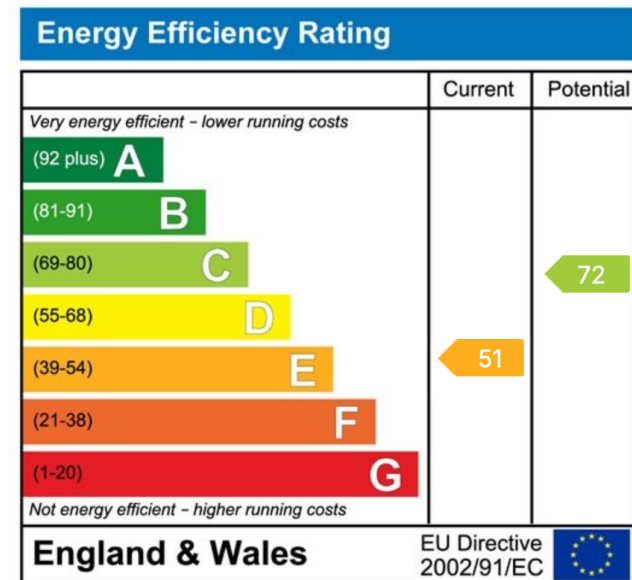

01303 475085

Match Estates LTD, trading as Match Estates, is a private limited company: 15509408
 Registered Address: B3 Bouverie House, Folkestone, Kent, CT20 1AE
 VAT Registration Number: 464 1921 89

www.match-estates.co.uk

