



**MATCH  
ESTATES**

FIND YOUR  
MATCH



## Shoreline, Folkestone, Kent

£2,250PCM (Deposit: £2,596)

🛏️ 2 🚿 2 🛋️ 1



Tax Band: D Furnished: Not specified

Your opportunity to live in Shoreline, Folkestone's most prestigious development nestled on Folkestone Harbour. Check out this exquisite two bedroom apartment with direct sea-views, a private balcony and allocated parking.



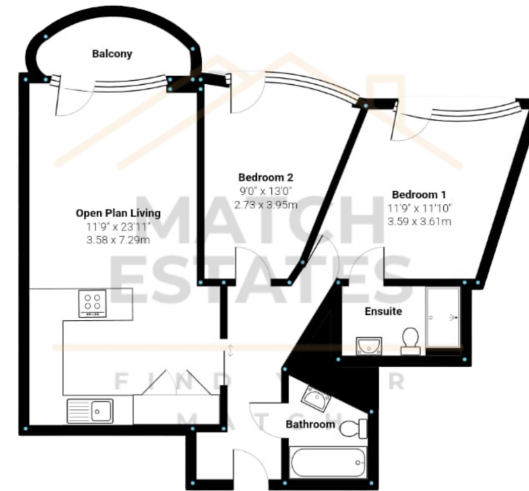

Measurements are approximate and for display purposes only



Energy Efficiency Rating		
	Current	Potential
<i>Very energy efficient - lower running costs</i>		
(92 plus) <b>A</b>		
(81-91) <b>B</b>	85	85
(69-80) <b>C</b>		
(55-68) <b>D</b>		
(39-54) <b>E</b>		
(21-38) <b>F</b>		
(1-20) <b>G</b>		
<i>Not energy efficient - higher running costs</i>		
<b>England &amp; Wales</b>	EU Directive 2002/91/EC	

01303 475085

[www.match-estates.co.uk](http://www.match-estates.co.uk)

Match Estates LTD, trading as Match Estates, is a private limited company: 15509408  
 Registered Address: B3 Bouverie House, Folkestone, Kent, CT20 1AE  
 VAT Registration Number: 464 1921 89

