



Augusta Gardens, Folkestone

Guide Price £175,000

1 1 1



GUIDE PRICE £175,000-£185,000.

Nestled within the sought-after area of Augusta Gardens, this charming one-bedroom, first-floor apartment offers an idyllic blend of comfort and elegance. Upon entering the property, you are greeted by a generously sized living/dining room featuring high ceilings and large windows that provide a scenic view of the lush Augusta Gardens. This inviting space is perfect for both relaxation and entertaining.

The well-appointed kitchen, situated just off the hallway, is designed for convenience and practicality. It features a wide opening window and a serving hatch that opens through to the living room, enhancing the apartment's open and airy feel.

The bathroom is spacious and thoughtfully designed, boasting a bath, WC, basin, and an overhead shower, ensuring all your needs are met with ease and style.

The bedroom is generous in size and benefits from integrated wardrobe space, offering ample storage without compromising on living space.

Residents of Adelphi Court enjoy exclusive access to Augusta Gardens, a private, meticulously maintained garden area that provides a peaceful retreat right on your doorstep.

With a lease length of over 150 years, this property is an ideal first-time buy or investment opportunity, offering a turnkey ready living experience.

There is a section 20 on the building with bill per each flat. This bill will be settled by the current vendors prior to completion. The works are to start this year to cover the exterior of the building.



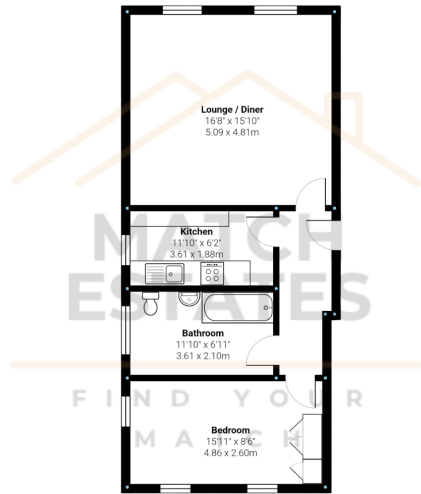

Measurements are approximate and for display purposes only

- Chain Free!
- One Double Bedroom
- Great Sized Living Space
- High Ceilings
- Recently Redecorated
- Fantastic Location
- Access To Augusta Gardens
- Large Bathroom
- Close To Town Centre
- Walking Distance To Folkestone Central Train Station

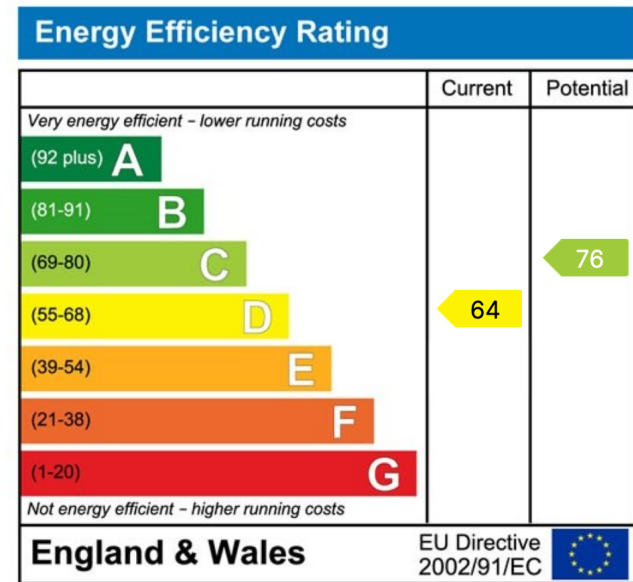

01303 475085

Match Estates LTD, trading as Match Estates, is a private limited company: 15509408
 Registered Address: B3 Bouverie House, Folkestone, Kent, CT20 1AE
 VAT Registration Number: 464 1921 89

www.match-estates.co.uk

