



Earls Avenue, Folkestone

£425,000

4 2 1



Welcome to this exceptionally spacious four-bedroom apartment, situated in the highly sought-after West End of Folkestone. This chain-free first-floor residence offers a unique opportunity to create a stunning home, with ample scope for refurbishment to suit your personal taste.

The apartment boasts a wealth of original features, adding character and charm to its already impressive proportions. The expansive living space includes a generous reception room, a well-sized kitchen, and four comfortable bedrooms. One of the bedrooms benefits from an ensuite shower room, providing convenience and privacy.

Residents will appreciate the off-road parking space, a valuable feature in this desirable location. Additionally, the property is within walking distance to both the town centre and the mainline Central Station, making it ideal for commuters and those who enjoy easy access to local amenities.

With a long lease remaining, this property presents an excellent investment opportunity. Do not miss the chance to view this remarkable apartment and imagine the potential it holds for becoming your dream home.

For more information or to arrange a viewing, please contact our office today.



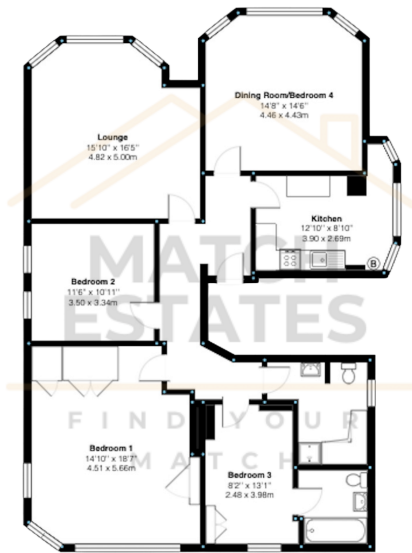

- No Chain
- Off Road Resident Parking
- Packed With Original Features Throughout
- Scope To Refurbish To Make A Wonderful Home
- Huge West End Apartment
- Long Lease Remaining
- Very Sought After Location
- Walking Distance To Town and Central Station



Energy Efficiency Rating		
	Current	Potential
<i>Very energy efficient - lower running costs</i>		
(92 plus) A		
(81-91) B		
(69-80) C		74
(55-68) D	67	
(39-54) E		
(21-38) F		
(1-20) G		
<i>Not energy efficient - higher running costs</i>		
England & Wales	EU Directive 2002/91/EC	

01303 475085

www.match-estates.co.uk

Match Estates LTD, trading as Match Estates, is a private limited company: 15509408
 Registered Address: B3 Bouverie House, Folkestone, Kent, CT20 1AE
 VAT Registration Number: 464 1921 89

