

OPENING DOORS SINCE 1843

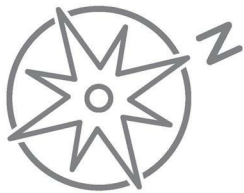

Key

- Plots 1,3,4 & 6 - 2 Bedroom End of Terrace
- Plots 2 & 5 - 2 Bedroom Mid Terrace
- Plots 7 & 8 - 2 Bedroom Semi Detached

Residential Development

Off Croft Mead, Nuneaton, CV10 9PX
Prices From £225,000



For identification purposes only. Not a legal representation of the development. Not to scale

Off Croft Mead Nuneaton, CV10 9PX

A fabulous collection of 8 brand new 2 bedroom homes set within a quiet cul de sac location, off Croft Mead, Ansley, Nuneaton. This beautiful collection of 2 bedroom terraced and semi-detached homes starting from just £225,000 are a fantastic starter home for first time buyers or smaller families looking for their forever homes. These homes have a fantastic specification, with an open flow from kitchen to living room giving the feel of the open plan living.

OPEN DAY COMING SOON PLEASE CALL 024 7634 7676 TO REGISTER YOUR INTEREST.

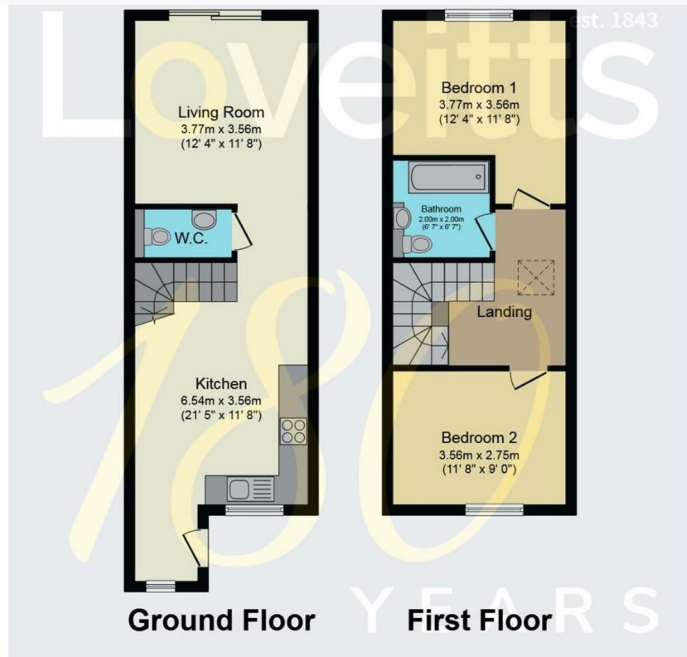

- DO NOT MISS OUT!
- BRAND NEW HOME!
- NO STAMP DUTY FOR FIRST TIME BUYERS!!
- GREAT STARTER HOMES
- SMALL DEVELOPMENT OF ONLY 8 HOMES
- PRIVATE CUL DE SAC LOCATION
- 2 GOOD SIZED BEDROOMS
- HIGH SPECIFICATION
- READY TO MOVE INTO!
- OPEN DAY COMING SOON - REGISTER YOUR INTEREST - BY APPOINTMENT ONLY!!

Floor Plan

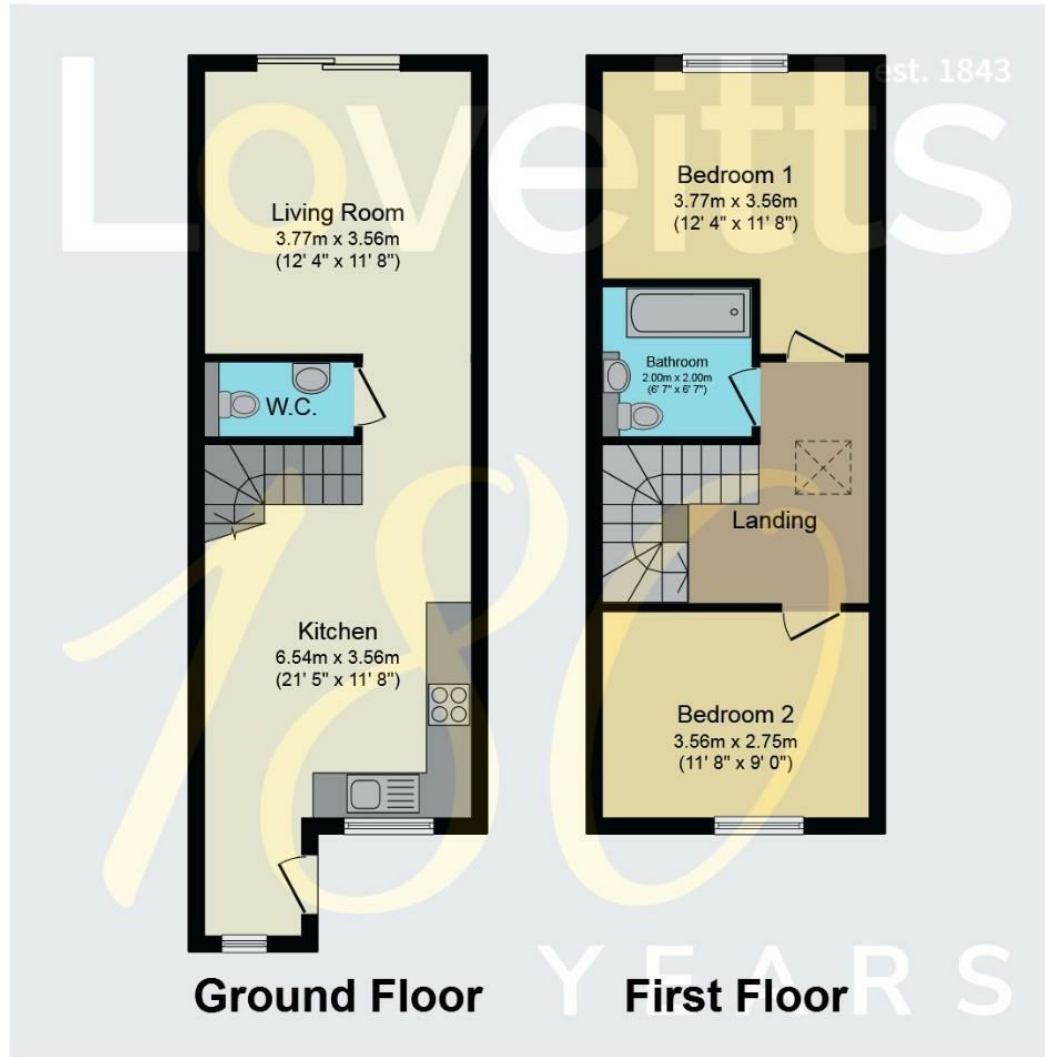

Total floor area 72.8 m² (784 sq.ft.) approx

This plan is for illustration purposes only and may not be representative of the property. Plan not to scale. Powered by PropertyBox

Area Map

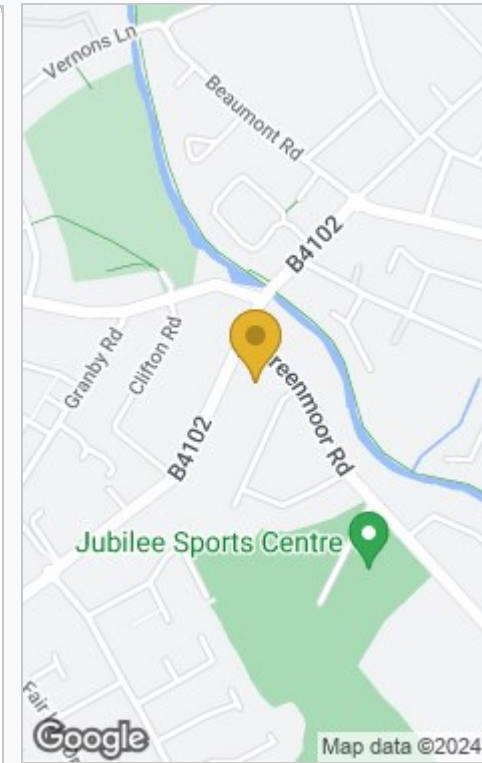

Energy Efficiency Rating

	Current	Potential
Very energy efficient - lower running costs		
(92 plus) A		
(81-91) B		
(69-80) C		
(55-68) D		
(39-54) E		
(21-38) F		
(1-20) G		
Not energy efficient - higher running costs		
England & Wales	EU Directive 2002/91/EC 	

These particulars, whilst believed to be accurate are set out as a general outline only for guidance and do not constitute any part of an offer or contract. Intending purchasers should not rely on them as statements of representation of fact, but must satisfy themselves by inspection or otherwise as to their accuracy. No person in this firm's employment has the authority to make or give any representation or warranty in respect of the property.