



2 Oak Tree Close, Eastchurch
Sheerness

Offers Over **£825,000**



2 Oak Tree Close

Eastchurch, Sheerness

Tenure: Freehold

EPC Energy Efficiency Rating: C

EPC Environmental Impact Rating: C

- Prime location at Kingsborough Manor
- 31 ft by 25 ft Kitchen/dining/family room
- Living space with wood burner, bifold doors and velux windows with electric blinds
- Separate lounge, study and garden room
- Self contained annex with own entrance, hall, fitted kitchen, lounge/diner, utility/cloakroom, two bedrooms and bathroom
- Main 4 bedroom detached residence has been extended to the rear elevation
- Kitchen area with central island, fitted Neff appliances and raise and lower extractor
- Master bedroom has dressing room and en suite bathroom
- Spacious utility room with access to double garage with electric doors
- Impressive frontage with extensive parking, enclosed garden and substantial workshop. Approximately third of an acre plot



Oak Tree Close, Eastchurch, Sheerness, ME12



Approximate Area = 2543 sq ft / 236.2 sq m

Garage = 369 sq ft / 34.2 sq m

Annexe = 1089 sq ft / 101.1 sq m

Total = 4001 sq ft / 371.5 sq m

For identification only - Not to scale

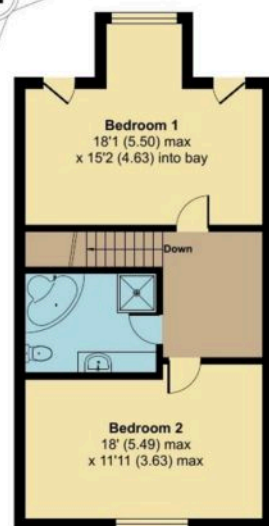

ANNEXE FIRST FLOOR



FIRST FLOOR



ANNEXE GROUND FLOOR / GROUND FLOOR









Lynne Collins Property Bespoke Estate Agent

07817 727321

lynne@homelyproperties.co.uk

www.homelyproperties.co.uk