

# HoldenCopley

PREPARE TO BE MOVED

Black Swan Close, Woodthorpe, Nottinghamshire NG5 3JG

---

£795 PCM

Black Swan Close, Woodthorpe, Nottinghamshire NG5 3JG





## LOCATION LOCATION LOCATION

This well presented two bedroom second floor apartment sits within a popular development in the sought after location of Woodthorpe within walking distance to Sherwood's vibrant shops and cafes, plus close-by Tesco and Jayplex Pharmacy. It also benefits from excellent transport links to and from the City and easy access to the City Hospital and ring road. The accommodation comprises of an inviting entrance hall, two well proportioned bedrooms, a large lounge / diner as well as a separate kitchen host to a range of integrated and freestanding appliances serviced by a modern three piece shower suite. This property is coming to the market un-furnished and is ready for immediate occupancy.

AVAILABLE NOW!

\*PLEASE NOTE ALL WHITE GOODS WILL REMAIN IN THE PROPERTY\*





- Second Floor Apartment
- Two Bedrooms
- Fitted Kitchen
- Spacious Lounge/Diner With Feature Fireplace
- Un-furnished
- Three Piece Shower Suite
- Off-Street Parking Available
- Popular Location
- Available Now









## ACCOMMODATION

### Entrance Hall

14'10" max x 6'0" (4.54m max x 1.85m)

The entrance hall has carpeted flooring, a wall mounted heater, a built in storage cupboard and provides access into the accommodation

### Living/Diner

14'6" max x 12'11" (4.42m max x 3.95m)

The lounge / diner has carpeted flooring, a feature fireplace with surround, a wall mounted heater, a dado rail, electrical points, a TV point, wall mounted lights and a window

### Kitchen

8'9" max x 7'10" (2.67m max x 2.39m)

The kitchen has a range of fitted base and wall units with rolled edge work surfaces, an integrated oven, electric hob and extractor fan, partially tiled walls, a washing machine, dishwasher, freestanding fridge freezer, a wall mounted fan heater, a stainless steel sink with drainer and mixer taps, a Velux window and tile effect flooring

### Master Bedroom

12'11" max x 10'4" (3.96m max x 3.15m)

The main bedroom has carpeted flooring, a wall mounted heater and a window

### Bedroom Two

9'0" max x 8'11" (2.76m max x 2.72m)

The second bedroom has carpeted flooring, a wall mounted heater and a window

### Shower Room

6'4" x 6'2" (1.95m x 1.89m)

The shower room has a low level flush W/C, a pedestal wash basin with taps, a shower enclosure with a wall mounted shower, a wall mounted fan heater, a window and wood effect flooring

## OUTSIDE

### FRONT

To the front of the property there is availability for off-street parking

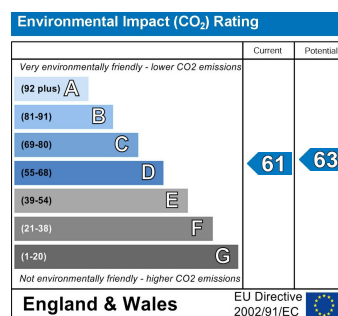
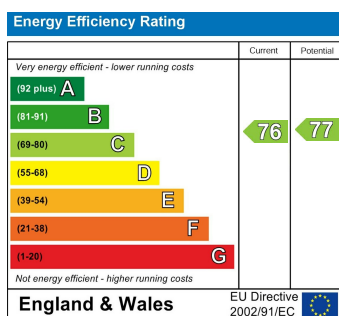

# Black Swan Close, Woodthorpe, Nottinghamshire NG5 3JG

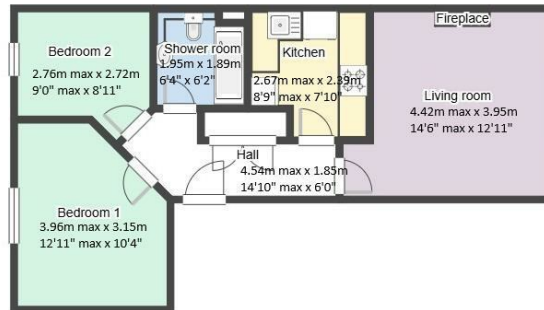

FLOORPLAN IS FOR ILLUSTRATIVE PURPOSES ONLY

All measurements walls, doors, windows, fittings and appliances, their sizes and locations are an approximate only. They cannot be regarded as being a representation by the seller nor their agent and is for identification only. Not to scale.  
© HoldenCopley

## 01158228800

4 Croft Road, Arnold, Nottingham, NG5 7DX

[lettings@holdencopley.co.uk](mailto:lettings@holdencopley.co.uk)

[www.holdencopley.co.uk](http://www.holdencopley.co.uk)

Agents Disclaimer: HoldenCopley, their clients and employees I: Are not authorised to make or give any representations or warranties in relation to the property either here or elsewhere, either on their own behalf or on behalf of their client or otherwise. They assume no responsibility for any statement that may be made in these particulars. These particulars do not form part of any offer or contract and must not be relied upon as statements or representations of fact. 2: Any areas, measurements or distances are approximate. The text, photographs and plans are for guidance only and are not necessarily comprehensive. It should not be assumed that the property has all necessary planning, building regulation or other consents and HoldenCopley have not tested any services, equipment or facilities. Purchasers must make further investigations and inspections before entering into any agreement.