

HoldenCopley

PREPARE TO BE MOVED

Wilford Lane, West Bridgford, Nottinghamshire, NG2 7RE

£825 PCM

Wilford Lane, West Bridgford, Nottinghamshire, NG2 7RE



APARTMENT LIVING...

This two bedroom first floor apartment offers spacious accommodation also boasting of ample storage throughout making the perfect home for any couples or working professionals looking to be located in the sought after area of WestBridgford within close proximity to a range of shops, eateries and transport links into the City Centre. Internally the accommodation comprises of a hallway, spacious living room, fitted kitchen, two good sized bedrooms serviced by a three piece bathroom suite. Outside there is a balcony and access for off street parking.

AVAILABLE NOW!





- First Floor Apartment
- Two Bedroom
- Fitted Kitchen
- Spacious Living Room
- Three Piece Bathroom Suite
- Storage Throughout
- Close To Local Amenities
- Ample Off Street Parking Available
- Popular Location
- 360 Virtual Tour Available





ACCOMMODATION

Hall

3'4" × 30'5" (1.04m × 9.29m)

The hall has parquet flooring, smoke alarm, access to three in-built storage cupboards, wall mounted storage heater, intercom and a single door providing access into the accommodation

Kitchen

5'7" × 10'5" (1.71m × 3.20m)

The kitchen has tile effect flooring, partially tiled walls, a range of fitted wall and base units with rolled edge worksurfaces, stainless steel sink with drainer and mixer taps, integrated oven with electric hobs and an extractor fan, integrated fridge freezer, space and plumbing for a washing machine and other appliances and a UPVC double glazed window to the front elevation

Living Room

10'0" × 18'8" (3.07m × 5.71m)

The living room has parquet flooring, TV point, storage heater, UPVC double glazed windows to the front elevation and a single UPVC door providing access into the accommodation

Master Bedroom

12'9" × 8'10" (3.91m × 2.71m)

The main bedroom has carpeted flooring, wall mounted storage heater, in-built storage cupboard and a double glazed windows to the front elevation

Bedroom Two

14'11" × 8'10" (4.56m × 2.71m)

The second bedroom has carpeted flooring, a wall mounted heater, double glazed windows to the front elevation and a single UPVC door providing access into the accommodation

Bathroom

4'11" × 11'0" (max) (1.50m × 3.36m (max))

The bathroom has wood effect flooring, partially tiled walls, low level flush WC, pedestal wash basin with taps, panelled bath with taps, wall mounted electric shower and shower screen and a UPVC double glazed window the front elevation

OUTSIDE

Outside there is availability for ample off street parking

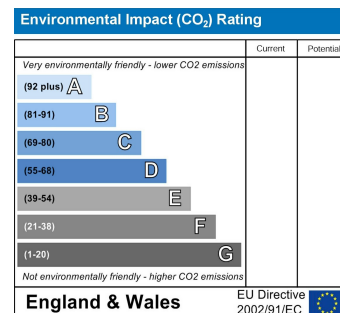
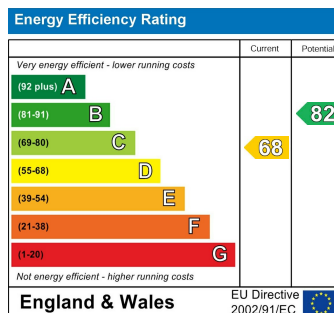

Wilford Lane, West Bridgford, Nottinghamshire, NG2 7RE

HoldenCopley
PREPARE TO BE MOVED

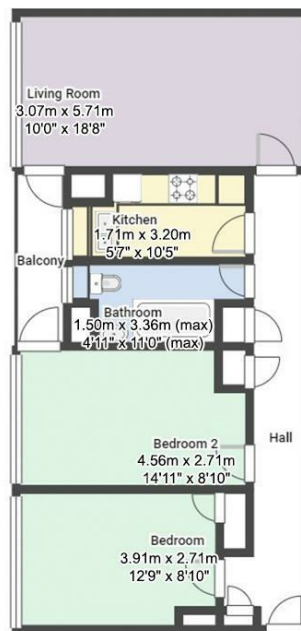

FLOORPLAN IS FOR ILLUSTRATIVE PURPOSES ONLY

All measurements walls, doors, windows, fittings and appliances, their sizes and locations are an approximate only. They cannot be regarded as being a representation by the seller nor their agent and is for identification only. Not to scale.
© HoldenCopley

01158228800

4 Croft Road, Arnold, Nottingham, NG5 7DX

lettings@holdencopley.co.uk

www.holdencopley.co.uk

Agents Disclaimer: HoldenCopley, their clients and employees: 1: Are not authorised to make or give any representations or warranties in relation to the property either here or elsewhere, either on their own behalf or on behalf of their client or otherwise. They assume no responsibility for any statement that may be made in these particulars. These particulars do not form part of any offer or contract and must not be relied upon as statements or representations of fact. 2: Any areas, measurements or distances are approximate. The text, photographs and plans are for guidance only and are not necessarily comprehensive. It should not be assumed that the property has all necessary planning, building regulation or other consents and HoldenCopley have not tested any services, equipment or facilities. Purchasers must make further investigations and inspections before entering into any agreement.